



Swansea Road, offers over £230,000

- Ideal For families
- Modern Throughout
- Close links to the M4 Corridor
- Close to Pontardawe Town Centre
- EPC Rating: E



 3  1  1



About the property

Nestled in a sought-after location between the popular villages of Clydach and Pontardawe, this beautifully presented three-bedroom double-fronted detached property offers generous living space, modern interiors, and versatile outdoor features ideal for growing families.

Step inside to find two comfortable reception rooms used as a lounge and separate dining area. These rooms are filled with natural light thanks to the large front-facing windows that create a bright and welcoming atmosphere. The modern kitchen compliments the property nicely. Upstairs, there are three well-proportioned bedrooms and a stylish family bathroom, all tastefully decorated and ready to move into.

With great access to local amenities, great links to the M4, and a convenient distance from Rhyd Y Fro Waterfall, there is something for everyone. This is a truly lovely home in a fantastic area. Light, spacious, and beautifully presented throughout,

Also at the rear of the property there is a private road which will take you to the two car ports for this house.



Accommodation

Living Room One

6' 4" x 7' 3" (1.93m x 2.21m)

14' 7" x 12' 1" (4.45m x 3.68m)

Living Room Two

9' 3" x 11' 1" (2.82m x 3.38m)

Kitchen

11' 9" x 11' 6" (3.58m x 3.51m)

Utility

5' 3" x 6' (1.60m x 1.83m)

Porch

9' x 8' 5" (2.74m x 2.57m)

Bedroom One

14' 6" x 11' 4" (4.42m x 3.45m)

Bedroom Two

9' 9" x 15' 1" (2.97m x 4.60m)

Bedroom Three

11' 5" x 8' 1" (3.48m x 2.46m)

Bathroom

01792 798201

morrison@peteralan.co.uk

Floorplan

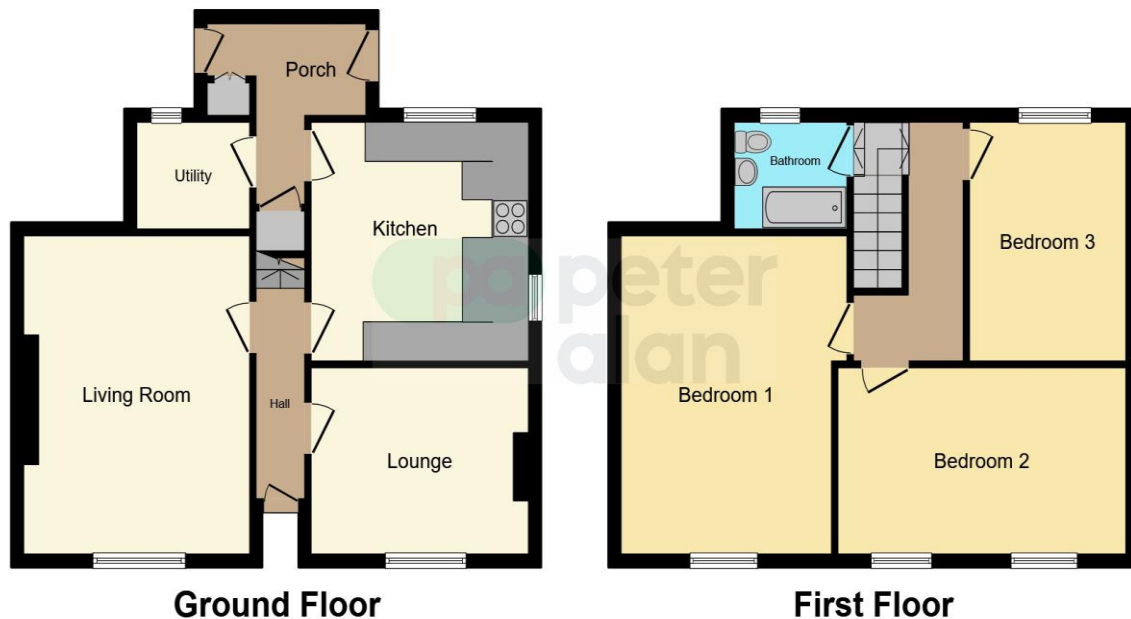

This floor plan is for illustrative purposes only. It is not drawn to scale. Any measurements, floor areas (including any total floor area), openings and orientation are approximate. No details are guaranteed, they cannot be relied upon for any purpose and they do not form part of any agreement. No liability is taken for any error, omission or misstatement. A party must rely upon its own inspection(s). Powered by www.focalagent.com

Important Information

Note while we endeavour to make our sales details accurate and reliable, if there is any point which is of particular interest to you, please contact the office and we will be pleased to confirm the position for you. We have not personally tested any apparatus, equipment, fixtures, fittings or services and cannot verify they are in working order or fit for their purposes. Nothing in these particulars is intended to indicate that carpets or curtains, furnishings or fittings, electrical goods (whether wired or not). Gas fires or light fittings or any other fixtures not expressly included form part of the property offered for sale. This computer generated Floorplan, if applicable, is intended as a general guide to the layout and design of the property. It is not to scale and should not be relied upon for dimensions. Tenure: We cannot confirm the tenure of the property as we have not had access to the legal documents. The buyer is advised to obtain verification from their solicitor or surveyor.

Peter Alan Limited is registered in England and Wales under company number 2073153, Registered Office is Cumbria House, 16-20 Hockliffe Street, Leighton Buzzard, Bedfordshire, LU7 1GN. VAT Registration Number is 500 2481 05. For activities relating to regulated mortgages and non-investment insurance contracts, Peter Alan Limited is an appointed representative of Connells Limited which is authorised and regulated by the Financial Conduct Authority. Connells Limited's Financial Services Register number is 302221. Most buy-to-let

