



Wayfair Grahamstown offers in excess of £250,000

- 2 BEDROOMS
- OFF ROAD PARKING
- PRIVATE REAR GARDEN
- FAR REACHING VIEWS
- OPEN PLAN
- EPC Rating: C
- Council Tax: B



 2  2  1



About the property

We are delighted to present this stylish, semi detached Two-Bedroom Home, boasting stylish and versatile space across two floors.

Located in a quiet and sought-after area of Chepstow, this well-presented two-bedroom home offers modern, move-in-ready accommodation ideal for a range of buyers.

The property features a bright open-plan kitchen/reception room with dual-aspect windows, a ground-floor WC, and a versatile second bedroom. Upstairs, the spacious principal bedroom occupies the entire first floor, benefiting from two 'His & Hers' en-suite shower rooms and lovely views across the Severn and surrounding countryside. If extra space is what you require, this area can easily be transformed into two separate bedrooms! Further benefits of this property include off road parking for 2 vehicles with gated access leading to the well presented enclosed rear garden

Conveniently positioned close to local amenities, reputable schools and with excellent transport links with easy access to the M48 and Severn Bridge, this home combines comfort, practicality, and location.





Accommodation

Entrance Hallway

Kitchen/Living Area

20' 9" x 14' 5" (6.32m x 4.39m)

Bedroom 2

8' 10" x 7' 11" (2.69m x 2.41m)

W.C

Bedroom 1

17' 1" x 15' 9" (5.21m x 4.80m)

En-Suite X 2

Outside

Delightful enclosed courtyard garden to the rear with gated access to side leading to parking for 2 vehicles

Floorplan

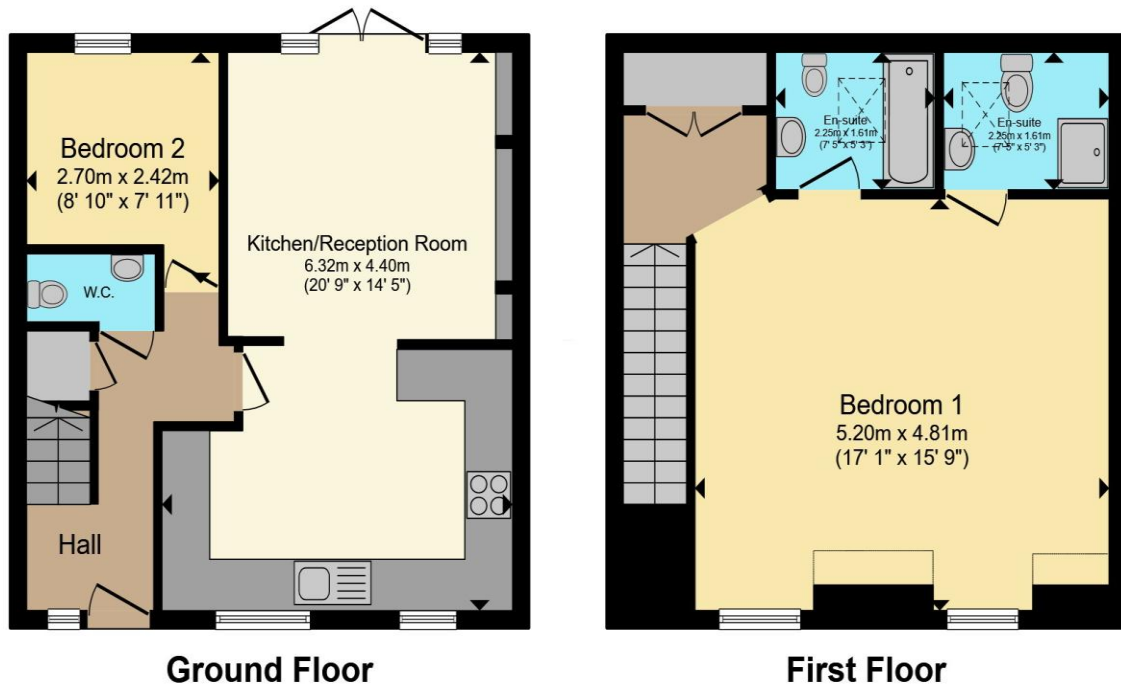

Total floor area 79.5 m² (856 sq.ft.) approx

This floor plan is for illustrative purposes only. It is not drawn to scale. Any measurements, floor areas (including any total floor area), openings and orientation are approximate. No details are guaranteed, they cannot be relied upon for any purpose and they do not form part of any agreement. No liability is taken for any error, omission or misstatement. A party must rely upon its own inspection(s). Powered by www.propertybox.io



Important Information

Note while we endeavour to make our sales details accurate and reliable, if there is any point which is of particular interest to you, please contact the office and we will be pleased to confirm the position for you. We have not personally tested any apparatus, equipment, fixtures, fittings or services and cannot verify they are in working order or fit for their purposes. Nothing in these particulars is intended to indicate that carpets or curtains, furnishings or fittings, electrical goods (whether wired or not). Gas fires or light fittings or any other fixtures not expressly included form part of the property offered for sale. This computer generated Floorplan, if applicable, is intended as a general guide to the layout and design of the property. It is not to scale and should not be relied upon for dimensions. Tenure: We cannot confirm the tenure of the property as we have not had access to the legal documents. The buyer is advised to obtain verification from their solicitor or surveyor.

Peter Alan Limited is registered in England and Wales under company number 2073153. Registered Office is Cumbria House, 16-20 Hockliffe Street, Leighton Buzzard, Bedfordshire, LU7 1GN. VAT Registration Number is 500 2481 05. For activities relating to regulated mortgages and non-investment insurance contracts, Peter Alan Limited is an appointed representative of Connells Limited which is authorised and regulated by the Financial Conduct Authority. Connells Limited's Financial Services Register number is 302221. Most buy-to-let