





£190,000

Situated in the desirable area of Great Linford this two bedroom terraced home is offered to the market with no upper chain with further benefits including a kitchen, lounge/diner, family bathroom, front and rear gardens and allocated parking.

Property Description

ENTRANCE

Door to:

ENTRANCE HALL

Radiator, storage cupboard, doors to lounge/diner and kitchen.

LOUNGE/DINER

Window to rear aspect. Radiator, stairs to first floor, understairs storage cupboard, door to kitchen.

KITCHEN

Window to front aspect. Range of wall mounted and floor standing units with work surface over, space for cooker, space for fridge/freezer, stainless steel sink with individual taps, storage cupboard, part tiled walls, radiator.

LANDING

Airing cupboard housing wall mounted water tank, doors to bedrooms and bathroom.

BEDROOM ONE

Window to front aspect. Radiator, built in wardrobe.

BEDROOM TWO

Window to rear aspect. Radiator.

BATHROOM

Low level w.c., wall mounted wash hand basin, panelled bath with hot and cold taps, part tiled walls, radiator.

FRONT GARDEN

Enclosed by brick wall, pathway to front door.

REAR GARDEN

Laid to lawn and enclosed by timber fencing panels.

GROUND FLOOR
330 sq.ft. (30.7 sq.m.) approx.

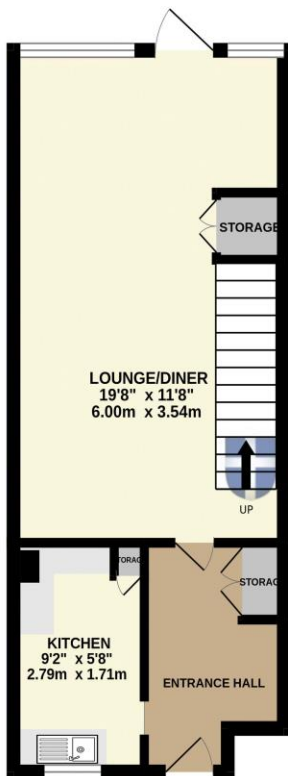

1ST FLOOR
368 sq.ft. (34.2 sq.m.) approx.

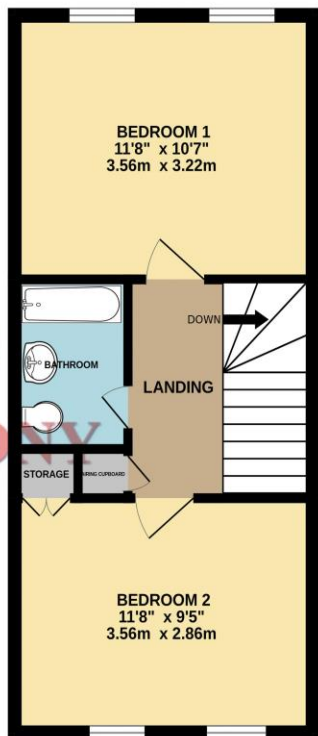

Michael
ANTHONY

TOTAL FLOOR AREA: 698 sq.ft. (64.8 sq.m.) approx.

Whilst every attempt has been made to ensure the accuracy of the floorplan contained here, measurements of doors, windows, rooms and any other items are approximate and no responsibility is taken for any error, omission or mis-statement. This plan is for illustrative purposes only and should be used as such by any prospective purchaser. The services, systems and appliances shown have not been tested and no guarantee as to their operability or efficiency can be given.
Made with Metropix ©2025

MONEY LAUNDERING REGULATIONS 2017 intending purchasers will be asked to produce identification and proof of financial status when an offer is received. We would ask for your co-operation in order that there will be no delay in agreeing the sale.

THE CONSUMER PROTECTION REGULATIONS 2008 The Agent has not tested any apparatus, equipment, fixtures and fittings or services and so cannot verify that they are in working order or fit for the purpose. A Buyer is advised to obtain verification from their Solicitor or Surveyor. References to the Tenure of a Property are based on information supplied by the Seller. The Agent has not had sight of the title documents. A Buyer is advised to obtain verification from their Solicitor. You are advised to check the availability of this property before travelling any distance to view. We have taken every precaution to ensure that these details are accurate and not misleading. If there is any point which is of particular importance to you, please contact us and we will provide any information you require. This is advisable, particularly if you intend to travel some distance to view the property. The mention of any appliances and services within these details does not imply that they are in full and efficient working order. These particulars are in draft form awaiting Vendors confirmation of their accuracy. These details must therefore be taken as a guide only and approved details should be requested from the agents

209A Witan Gate Sovereign Court Milton Keynes Buckinghamshire MK9 2HP
01908 393 553 | miltonkeynes@maea.co.uk