

HENDERSON CONNELLAN

ESTATE AGENTS

Neale Avenue, Kettering, NN16

"Talk of the Town"

"Talk of the Town"

This charming bay-fronted Victorian semi-detached home is ideally situated on a desirable tree-lined avenue to the north of the town. Beautiful character features have been thoughtfully retained and blend seamlessly with the well-presented accommodation throughout. The property offers an entrance hall with quarry tiled flooring, a spacious bay-fronted living room with a working multi-fuel burner, a separate dining room with bay window and understairs storage, and a well-appointed kitchen with integrated appliances and double doors opening onto the garden. Upstairs are three well-proportioned bedrooms, two of which are doubles, and a family bathroom. Externally, the property enjoys an attractive frontage and a generous rear garden with a patio seating area, lawn, mature planting, and two useful brick-built storage rooms with power and lighting.

Living Room - 3.78m x 3.48m (12'5" x 11'5")

Dining Room - 3.78m x 3.63m (12'5" x 11'11")

Kitchen - 4.93m x 2.64m (16'2" x 8'8")

Bedroom 1 - 4.83m x 3.51m (15'10" x 11'6")

Bedroom 2 - 3.63m x 2.95m (11'11" x 9'8")

Bedroom 3 - 2.97m x 2.64m (9'9" x 8'8")

Bathroom - 2.21m x 1.85m (7'3" x 6'1")

- In Sought After Location
- Semi Detached Home
- Bright Living Room
- Modern Kitchen
- Three Good Sized Bedrooms
- Large Garden
- UPVC Double Glazing
- Gas Central Heating
- COUNCIL TAX: C
- EPC RATING: PENDING

Tenure: Freehold





Ground Floor

Approx. 47.9 sq. metres (515.9 sq. feet)

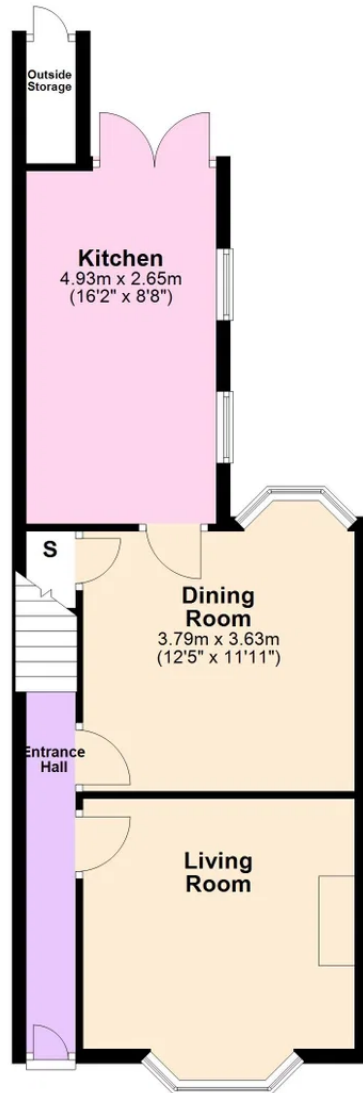

First Floor

Approx. 46.3 sq. metres (498.7 sq. feet)



Total area: approx. 94.3 sq. metres (1014.6 sq. feet)