



# TRACY PHILLIPS

## Estates



# TRACY PHILLIPS

## Estates

GROUND FLOOR  
608 sq.ft. (56.5 sq.m.) approx.

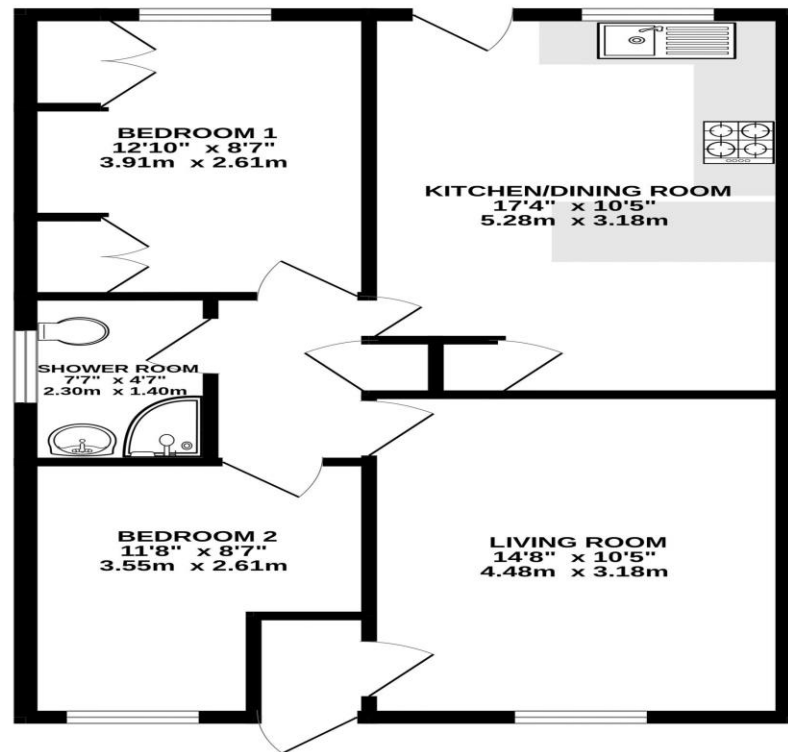

TOTAL FLOOR AREA: 608 sq.ft. (56.5 sq.m.) approx.  
Whilst every attempt has been made to ensure the accuracy of the floorplans contained here, measurements of doors, windows, rooms and any other items are approximate and no responsibility is taken for any error, omission or mis-statement. This plan is for illustrative purposes only and should be used as such by any prospective purchaser. The services, systems and appliances shown have not been tested and no guarantee as to their operability or efficiency can be given.  
Made with Metropix ©2026



Score	Energy rating	Current	Potential
92+	A		
81-91	B		
69-80	C	72 C	80 C
55-68	D		
39-54	E		
21-38	F		
1-20	G		



01257 422228

enquiries@tracyphillipsestates.com

tracyphillipsestates.com

Asking Price £185,000

Scot Lane, Wigan WN2 1YL

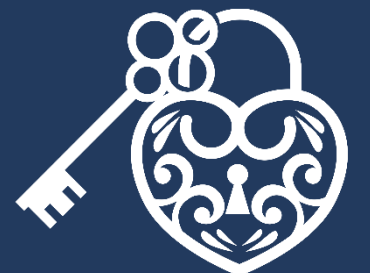

Every care has been taken with the preparation of this Sales Brochure but it is for general guidance only and complete accuracy cannot be guaranteed. If there is any point, which is of particular importance professional verification should be sought. This Sales Brochure does not constitute a contract or part of a contract. We are not qualified to verify tenure of property. Prospective purchasers should seek clarification from their solicitor or verify the tenure of this property for themselves by visiting [www.landregisteronline.gov.uk](http://www.landregisteronline.gov.uk). The mention of any appliances, fixtures or fittings does not imply they are in working order. Photographs are reproduced for general information and it cannot be inferred that any item shown is included in the sale. All dimensions are approximate.

Situated in the highly desirable village of Aspull, this well-presented two-bedroom semi-detached true bungalow offers comfortable, low-maintenance living, ideal for downsizers, first-time buyers, or those seeking single-level accommodation.

The property welcomes you with an entrance hall leading into a lounge, complete with a gas fireplace. The spacious kitchen-diner has ample worktop space, fitted units, and space for dining. A rear door provides direct access to the garden. There are two well-proportioned bedrooms, with the main bedroom offering fitted wardrobes for convenient storage. The modern bathroom features a shower enclosure, vanity basin, and W/C.

Externally, the rear garden is private and well-maintained, combining lawn and patio areas bordered by mature planting. To the front, a brick-paved driveway provides off-road parking for multiple vehicles, along with access to a single garage offering additional storage or workshop potential. Located in a popular residential area, Wigan town centre is just a short distance away, offering a wide range of shops, restaurants, and leisure facilities. The area also benefits from excellent transport links and access to major road networks, making it ideal for commuters. The property is offered with no onward chain.



