

Egmont Road, KT6

£475,000

A well presented two bedroom ground floor apartment, ideally located within easy reach of Surbiton Station and town centre. The property offers a bright and spacious bay fronted reception room, two well proportioned bedrooms, a separate kitchen and a smart three piece bathroom. Further benefits include a private rear garden, allocated parking and a share of the freehold.

Egmont Road is under a mile from Surbiton town centre, with its array of shops, bars, restaurants and the convenient mainline train station, with efficient links to London Waterloo.

Features

Ground Floor Apartment
Two Double Bedrooms
Private Rear Garden
Allocated Parking
Well Presented
Close To Transport Links

Egmont Road, Surbiton, KT6

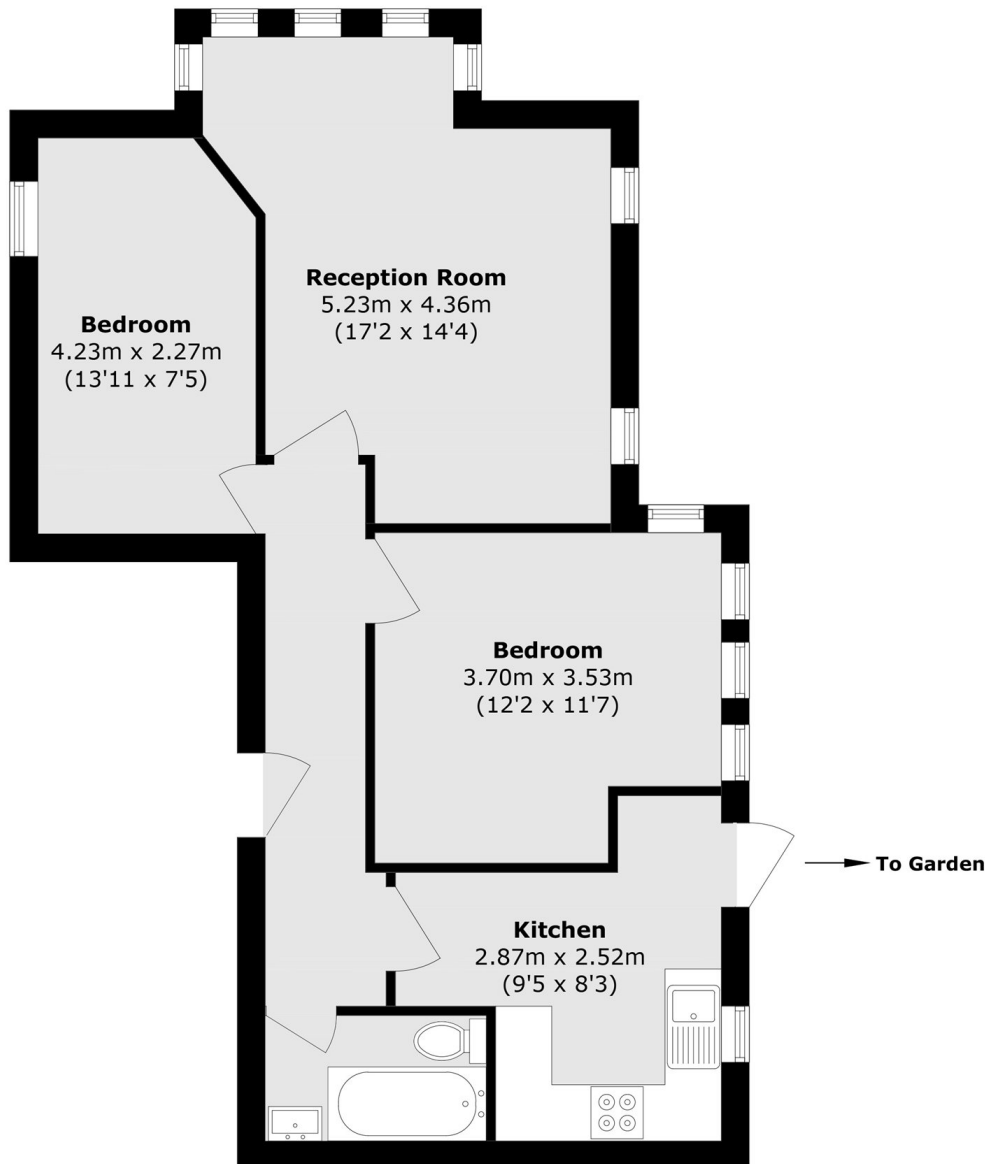

Total area (approx.): 60.5 sq. m (651.2 sq. ft)