



43 Sandyford Park

Jesmond



43 Sandyford Park, Jesmond, Newcastle Upon Tyne, NE2 1TA

Well Presented & Renovated Ground Floor Apartment Boasting Two Bedrooms, Contemporary Bathroom, Living Room, Open Plan Kitchen/Diner and Direct Access to the Communal Gardens!

Sandyford Park is an over 60's development, set within private woodland grounds, and offers a communal resident's lounge, on site estate manager and 24 hour emergency response call system. Ideally positioned just off Sandyford Road, Sandyford Park is well situated to access local transport links into Newcastle City Centre and is also located close to the shops and amenities of Jesmond.

The internal accommodation comprises: Private entrance | Entrance hallway with storage cupboard | Two double bedrooms, both of which enjoy ample fitted wardrobes | Generous living room, with built in bay window seat | Open plan kitchen/diner, boasting a range of modern cabinetry & worktops, as well as integrated appliances throughout | Family bathroom with contemporary three piece suite.





Externally, the property offers ample resident and visitor parking | The kitchen/diner connects straight through to a paved patio terrace, set within the communal grounds, and enjoys a south westerly aspect.

Offered to the market with No Onward Chain, early viewings are strongly encouraged!

Services: Mains Electricity, Water & Drainage | Tenure: Leasehold | Lease Remaining: 60 Years | Service Charge: £245 pcm | Council Tax: Band B | Energy Performance Certificate: Rating: D

Price Guide: Guide Price £175,000

Ground Floor

Approx. 60.6 sq. metres (652.7 sq. feet)

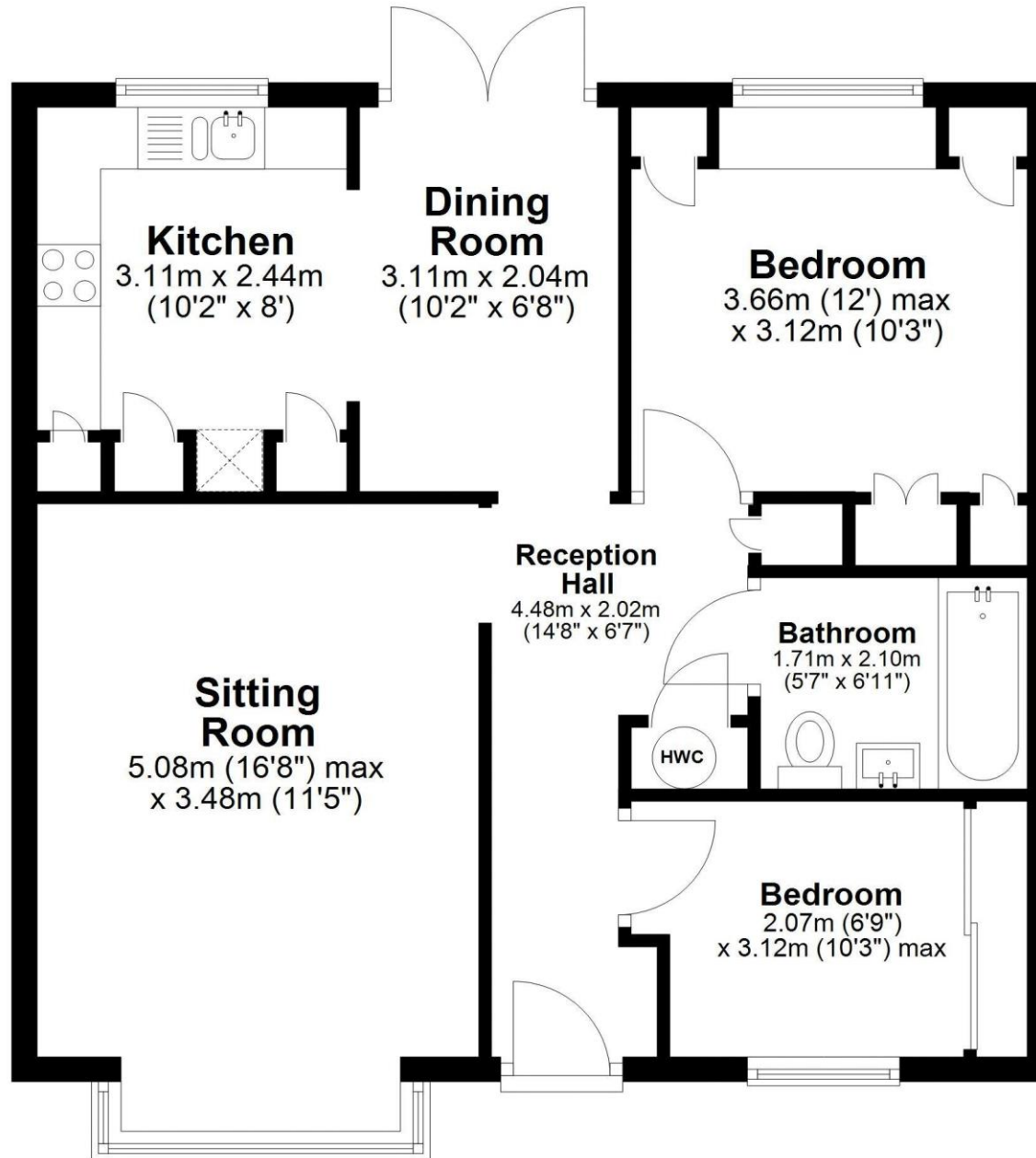

Total area: approx. 60.6 sq. metres (652.7 sq. feet)

43 Sandyford Park, Sandyford



SANDERSON YOUNG

Regional Gosforth Office
95 High Street | Gosforth
Newcastle upon Tyne | NE3 4AA
gosforth@sandersonyoung.co.uk
0191 213 0033