



Streatham Road, CR4

£350,000



- One Double Bedroom
- Private Balcony
- Modern Build
- Spacious Kitchen/Reception
- Close to Transport Links
- 592 Sq. Ft.





ABOUT THE PROPERTY

An immaculately presented first floor, one bedroom flat with a private balcony that is the perfect purchase for first time buyers. The open plan kitchen/reception area spans the whole length of the property and accommodates the fully fitted, modern, L-shaped kitchen. It provides direct access to the private balcony. Access to the balcony can also be gained from the double bedroom, which is spacious and comes with fitted sliding wardrobes. Completing this property is a contemporary family style bathroom with a rainfall shower over the bath.



The Imperial Court building is within walking distance of local amenities found along Mitcham Lane and plenty of green spaces including Figges Marsh and Tooting Common. The Imperial Court building is also exceptionally well connected: Tooting overground, Streatham common and Tooting Broadway stations are within walking distance.



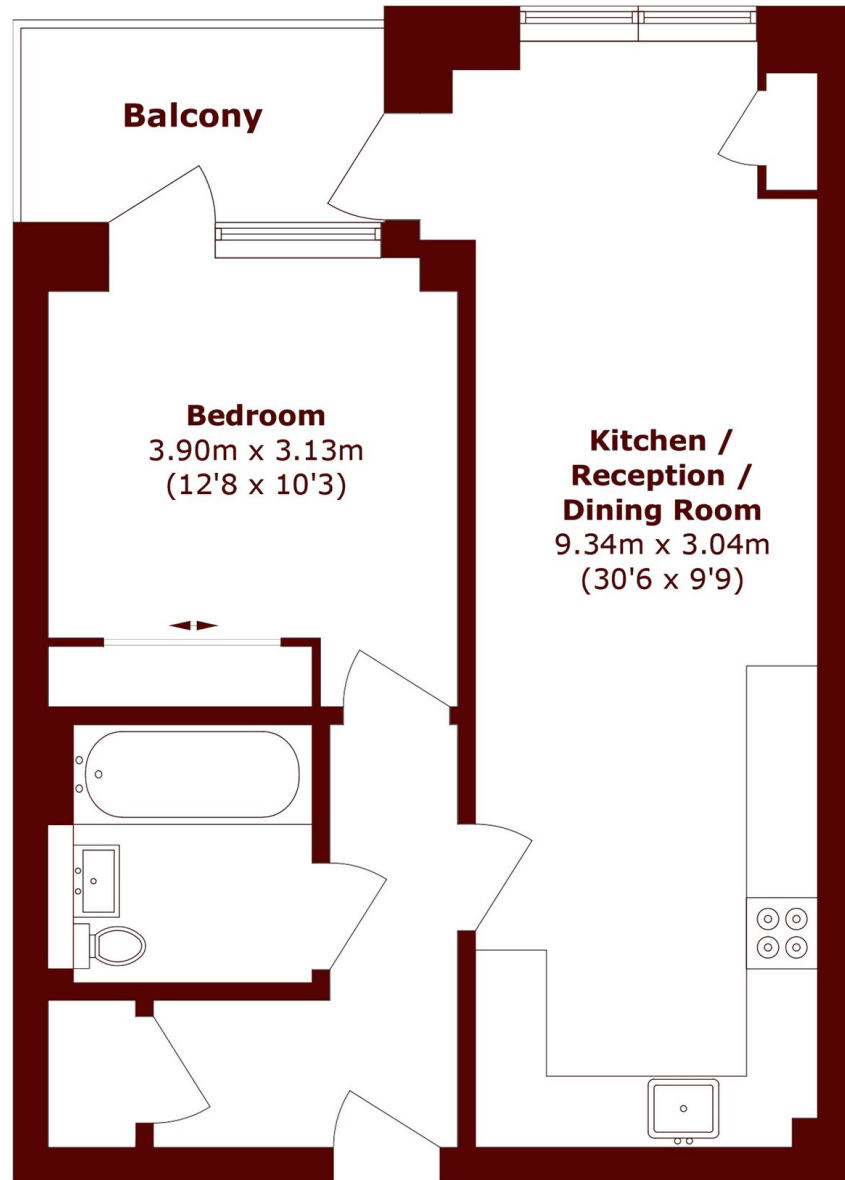

Total area (approx.): 55.0 sq. m (592.0 sq. ft)

Balcony area (approx.): 5.0 sq. m (53.8 sq. ft)

Marsh & Parsons Tooting
29-31 Upper Tooting Road,
London, SW17 7TS
020 8767 3655

We aim to make our particulars both accurate and reliable. However, they are not guaranteed; nor do they form part of an offer or contract. If you require clarification on any points then please contact us, especially if you're traveling some distance to view. Please note that appliances and heating systems have not been tested and therefore no warranties can be given as to their good working order.