

Loxwood Road, Ifold

Guide Price £625,000

 2  2  3



An impressive Detached Bungalow set on a Private 0.35 Acre Plot in an attractive Semi Rural Location, boasting a triple aspect 29ft Kitchen Dining Room and excellent potential to extend(stpp).

Tenure: Freehold

Council Tax Band: F

EPC: Current D - Potential C

Key Features

- Watch Our Video Tour
- 0.35 Acre Private Plot
- Gated Driveway & Garage
- 29ft Triple Aspect Kitchen Diner
- 18ft Living Room
- Snug & Study
- Two Large Double Bedrooms
- Bathroom & Shower Room
- Potential To Extend (stpp)
- Attractive Semi Rural Location

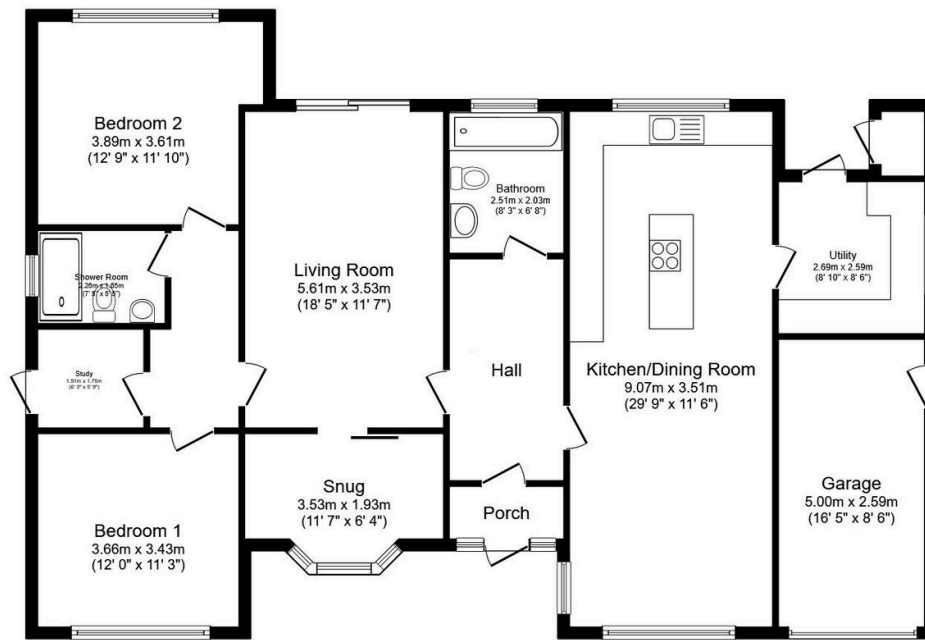

Floor Plan

Floor area 139.3 sq.m. (1,499 sq.ft.)

Total floor area: 139.3 sq.m. (1,499 sq.ft.)

This floor plan is for illustrative purposes only. It is not drawn to scale. Any measurements, floor areas (including any total floor area), openings and orientations are approximate. No details are guaranteed, they cannot be relied upon for any purpose and do not form any part of any agreement. No liability is taken for any error, omission or misstatement. A party must rely upon its own inspection(s). Powered by www.Propertybox.io