

Nairn Close, Birmingham, B28 0NX

£385,000

3 1 1



Spacious Family Home in a Peaceful Cul-de-Sac Setting – 31 Nairn Close, Birmingham, B28 0NX

Key Features

- Quiet cul-de-sac location
- Impressive open-plan lounge/diner
- Utility room and downstairs bathroom
- Modern family bathroom on the first floor
- Close to local schools, transport links, and amenities
- Spacious three-bedroom semi-detached family home
- Large fitted kitchen with rear garden access
- Three well-proportioned bedrooms
- Private, low-maintenance rear garden

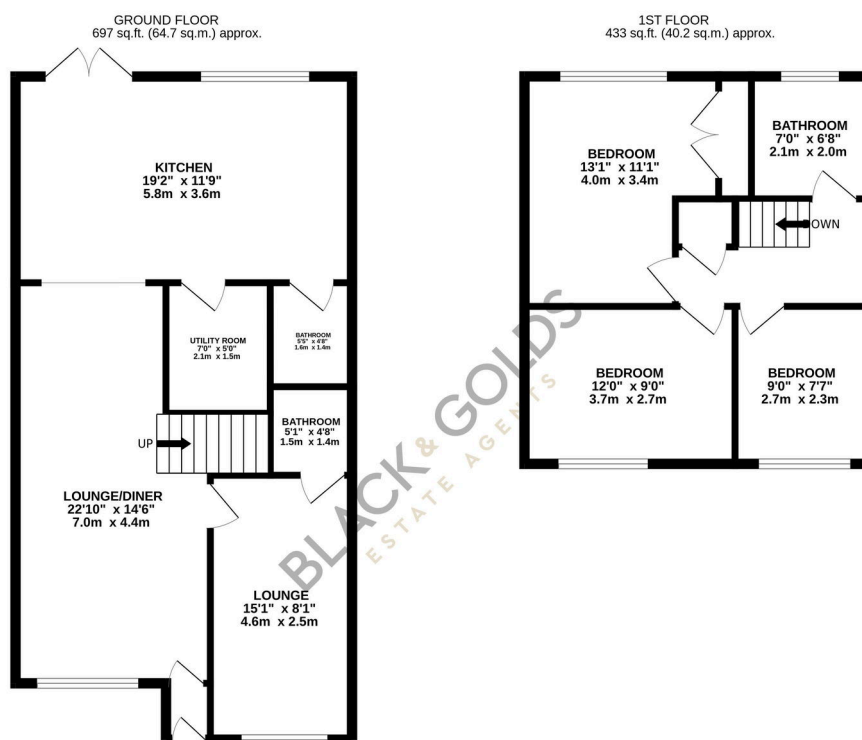

TOTAL FLOOR AREA: 1130 sq.ft. (105.0 sq.m.) approx.

Whilst every attempt has been made to ensure the accuracy of the floorplan contained here, measurements of doors, windows, rooms and any other items are approximate and no responsibility is taken for any error, omission or mis-statement. This plan is for illustrative purposes only and should be used as such by any prospective purchaser. The services, systems and appliances shown have not been tested and no guarantee as to their operability or efficiency can be given.

Made with Metropix ©2025

