

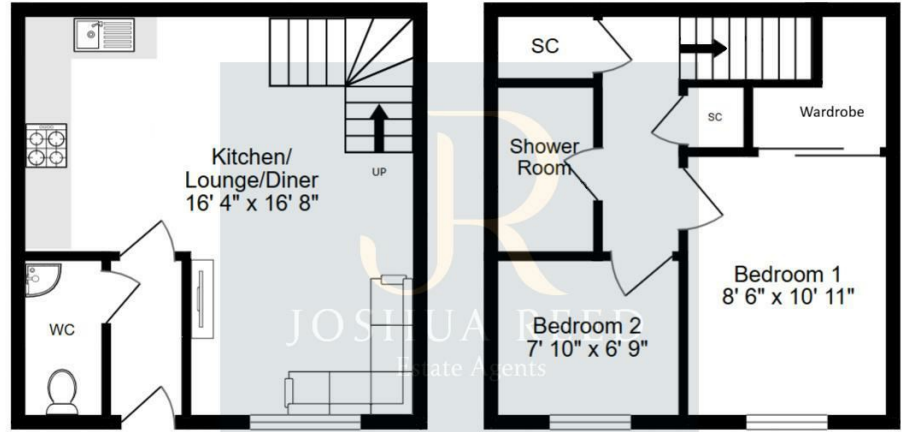

2 Bed House - Terraced  
located in

**R**  
JOSHUA REED  
Estate Agents

59 Olvega Drive  
 Buntingford  
 SG9 9FJ



**Total Floor Area: 529 Sqft**  
 All measurements are approximate and for display purposes only

£275,000

**CONTACT**

23-27 Maidenhead Street  
 Hertford  
 Hertfordshire  
 SG14 1DW

**EMAIL**

josh@joshua-reed.co.uk

**TELEPHONE**

01992 917388

www.joshua-reed.co.uk

**SUMMARY**

A beautifully presented, modern two bedroom cluster home nicely positioned in this cul-de-sac within walking distance to the Town Centre which offers an array of amenities. Finished to a high standard throughout, the accommodation offers an entrance porch, downstairs WC, modern gloss kitchen with integrated appliances that is open plan to the living and dining space. To the first floor are two good size bedrooms with built in wardrobes to the master, contemporary shower room, storage cupboard on the landing and access to loft space.

Additionally, the property benefits from gas central heating, UPVC double glazing, allocated parking space, secure residents bike store and children's play area nearby.

Arrange your viewing today.

**DIRECTIONS**

Energy Efficiency Rating		Current	Potential
Very energy efficient - lower running costs			
(92 plus) <b>A</b>			
(81-91) <b>B</b>			
(69-80) <b>C</b>			
(55-68) <b>D</b>			
(39-54) <b>E</b>			
(21-38) <b>F</b>			
(1-20) <b>G</b>			
Not energy efficient - higher running costs			
<b>England &amp; Wales</b>		EU Directive 2002/91/EC	