



Church Street, Ware SG12 9EW

£1750 per calendar month



Taylor Phelps

Estate Agency

Estate Agency

Taylor Phelps are pleased to offer this rarely available three bedroom apartment in Ware town centre. This duplex property offers spacious accommodation and character features throughout. Further benefitting from two bathrooms, and its own entrance doo. The conveniences of Ware high street are on the doorstep and Ware train station which serves both Hertford East and London Liverpool Street.





Taylor Phelps



Taylor Phelps



Taylor Phelps



Taylor Phelps



Taylor Phelps
Estate Agency



Taylor Phelps
Estate Agency



Taylor Phelps
Estate Agency



Taylor Phelps
Estate Agency

Floor Plan

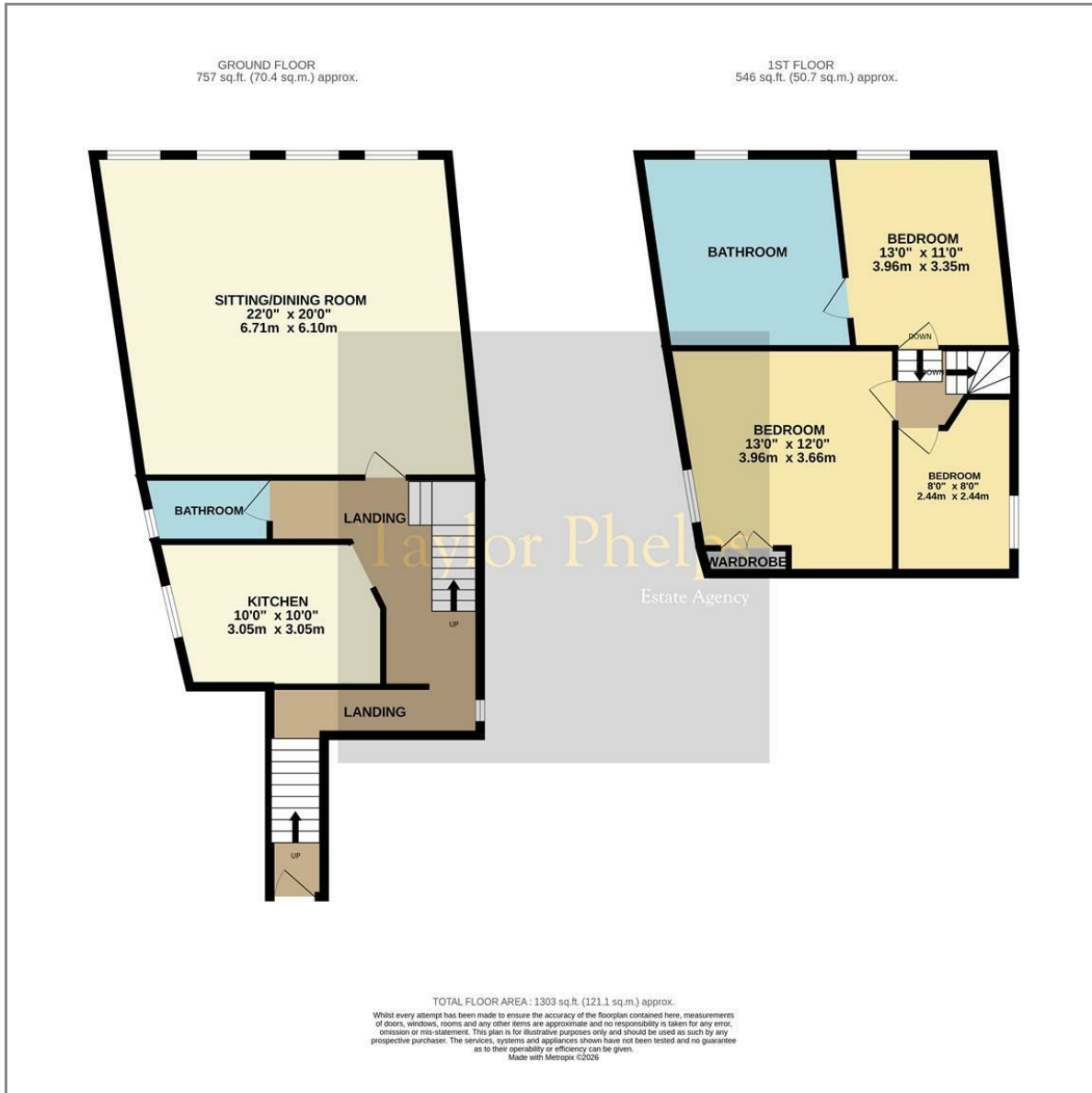

Area Map

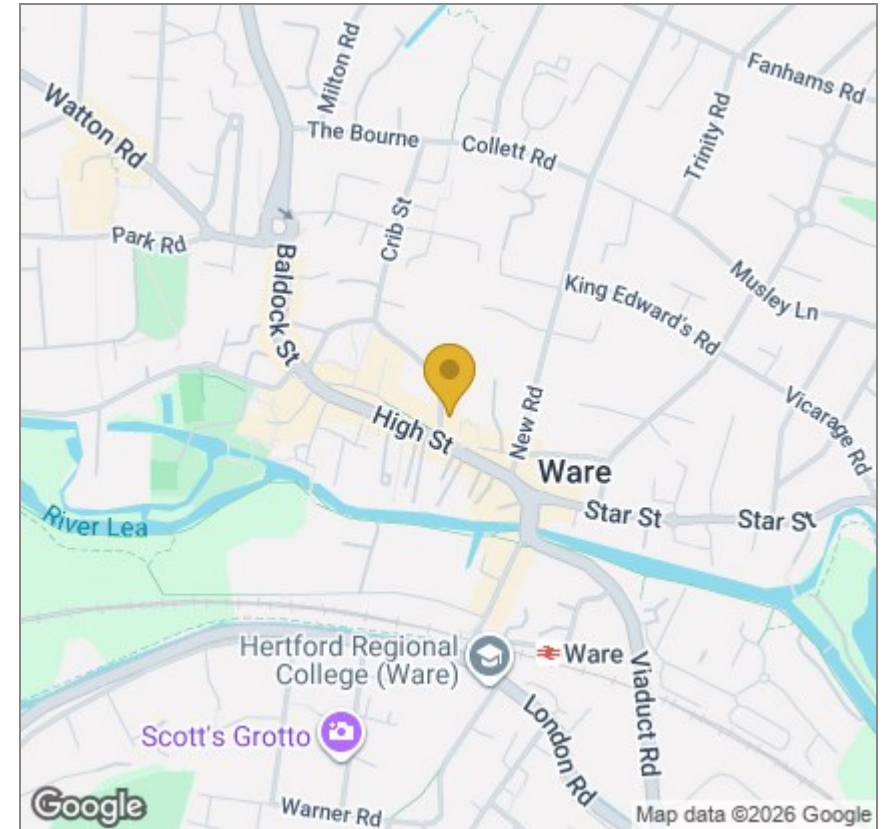

Energy Efficiency Graph

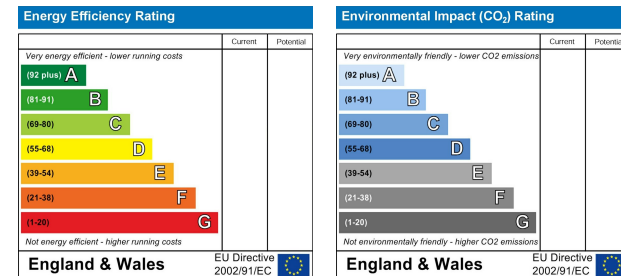

These particulars, whilst believed to be accurate are set out as a general outline only for guidance and do not constitute any part of an offer or contract. Intending purchasers should not rely on them as statements of representation of fact, but must satisfy themselves by inspection or otherwise as to their accuracy. No person in this firm's employment has the authority to make or give any representation or warranty in respect of the property.

01920 459000

hello@taylorphelps.co.uk

5 Frenchs Yard, Amwell End, Ware, Hertfordshire, SG12 9HP

www.taylorphelps.co.uk

