



**Selbon**

Residential sales & lettings

Azalea Gardens, Church Crookham,  
Hampshire, GU52 8UY

Offers over £520,000 Freehold



**01252 979300**

[Selbonproperty.co.uk](http://Selbonproperty.co.uk)

- Extended Detached Family Home
- Kitchen/Breakfast Room
- Entrance Hallway & Cloakroom
- Enclosed Rear Garden
- Cul-De-Sac Location
- Four Bedrooms
- Living Room & Dining Room
- Family Bathroom
- Driveway Parking & Garage
- Close to Local Schools & Amenities

Selbon Estate Agents are delighted to offer to the market this extended four bedroom detached family home, ideally situated in a cul-de-sac location in Church Crookham. The property is in need of some modernisation and is an ideal home for those with a growing family.

The location is excellent for local schools and amenities and is currently in the catchment area for Tweseldown Infant school, Church Crookham Junior school and Court Moor Secondary school.

On entering the property you are welcomed into a reception hallway with stairs to the first floor with storage cupboard. The principle accommodation includes; front aspect living room, a kitchen/breakfast/family room which opens to a dining room, utility room and a cloakroom to the ground floor.

The kitchen is in need of modernisation and the current owners have purchased new units that can be negotiated separately should a potential buyer be interested.

To the first floor there are four generous bedrooms. Bedroom one benefits from an en-suite wet room with shower and hand wash basin. Bedroom two also benefits from an en-suite shower room.

The family bathroom has been re-fitted and comprises an oversized bath tub with jets and lighting, separate corner shower cubicle, hand wash basin and W.C.

Externally the rear garden is predominately laid to lawn with patio area immediately to the rear of the property.

To the front is driveway parking with car port which leads to a garage with up and over door.

For those seeking the outdoor life, Velmead Woods, Tweseldown, Fleet pond and the Basingstoke canal are all close by, offering a wealth of beautiful walking, running and cycling routes.

Fleet town centre with an array of shops, bars and restaurants and the mainline railway station are a short drive away and there are excellent road links including the M3 & A3.

















## Floor Plans

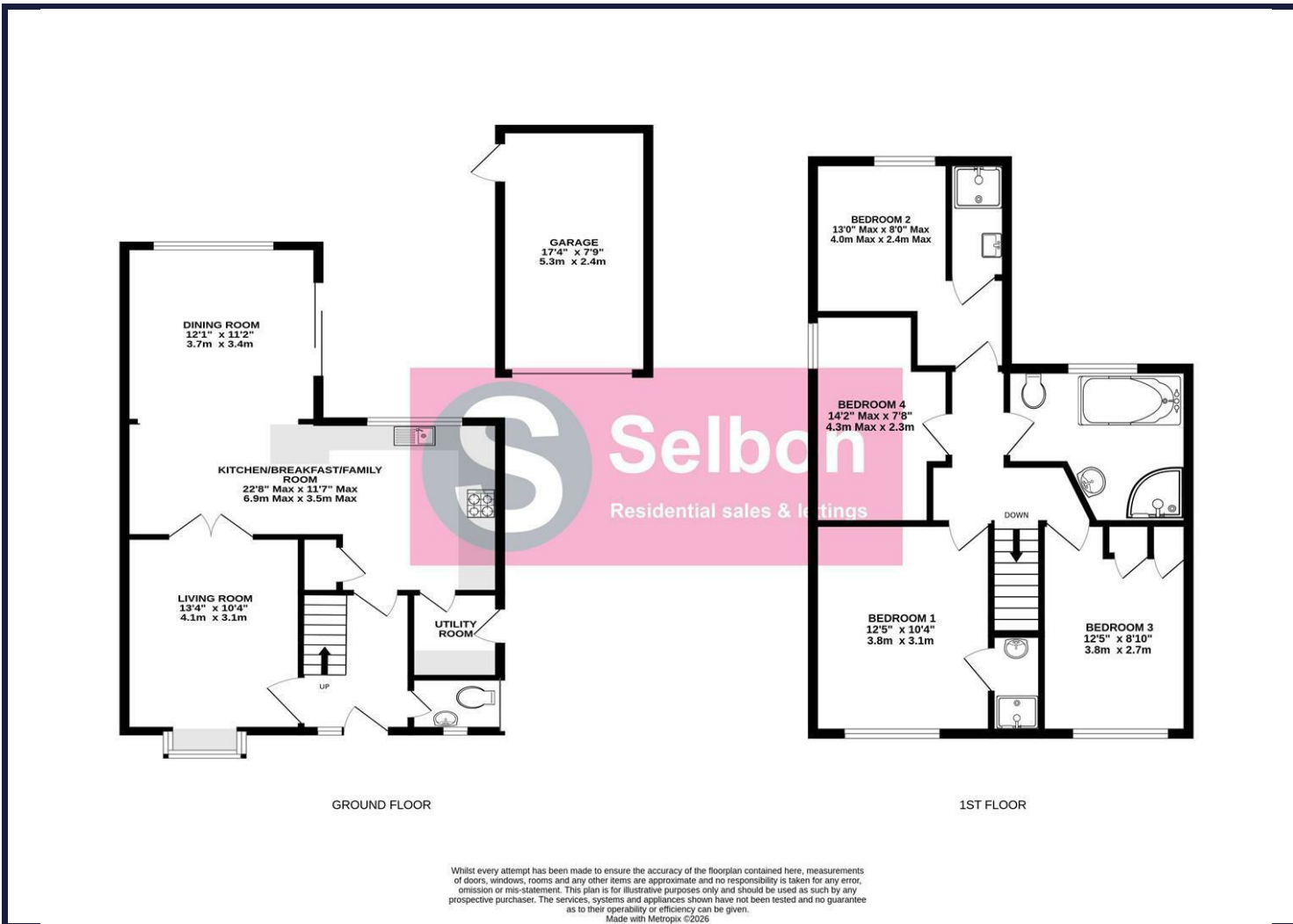

## Area Map

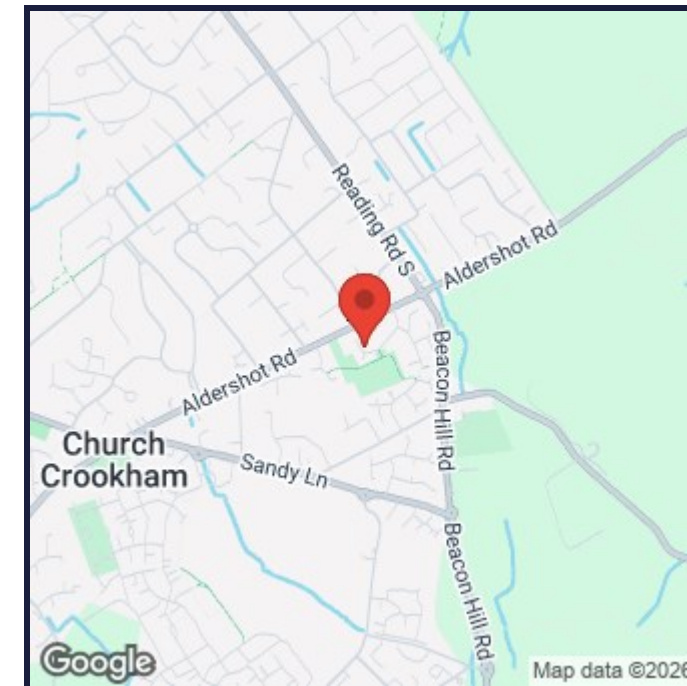

## Energy Performance Graph

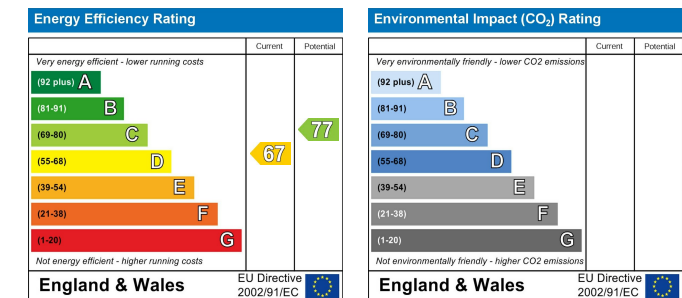

## Viewing

For further information on this property or to arrange a viewing please contact Selbon Estate Agents on 01252 979300

We give notice that these particulars are produced in good faith and in accordance with the Consumer Protection from Unfair Trading Regulations 2008 (CPR). They are set out as a general guide only and do not constitute any part of a contract or warranty whatsoever. Intending purchasers should not rely on them as statements of representation of fact, but must satisfy themselves by inspection or otherwise as to their accuracy. No person in the employment of Selbon has any authority to make or give any representation or warranty whatever in relation to the property. A detailed survey has not been carried out nor have the services, heating systems, appliances or specific fittings been tested. Any photograph incorporated within these particulars shows only certain parts of the property and it must not be assumed that any contents or fixtures and fittings shown in the photographs are either included with the property or indeed remain in it. Room sizes shown and any floor plans should not be relied upon for carpets and furnishings. If there is any point which is of particular importance to you we will be pleased to check the information for you and confirm that the property remains available. This is particularly important if you are contemplating travelling some distance to view the property.

## Council Tax Band: E

### Selbon Property Services Ltd

Registered Office, 16 Levignen Close, Church Crookham, Fleet, Hampshire, GU52 0TW

Company Registration Number: 12108205 VAT Number: 370 7956 65

Tel: 01252 979300 Email: sales@selbonproperty.co.uk