



1 Bed
Flat
located in

£1,200 Per month



TAYLOR
MICHAEL

Clyde Road, Brighton, BN1 4NN

Approximate Gross Internal Area = 42.6 sq m / 458 sq ft

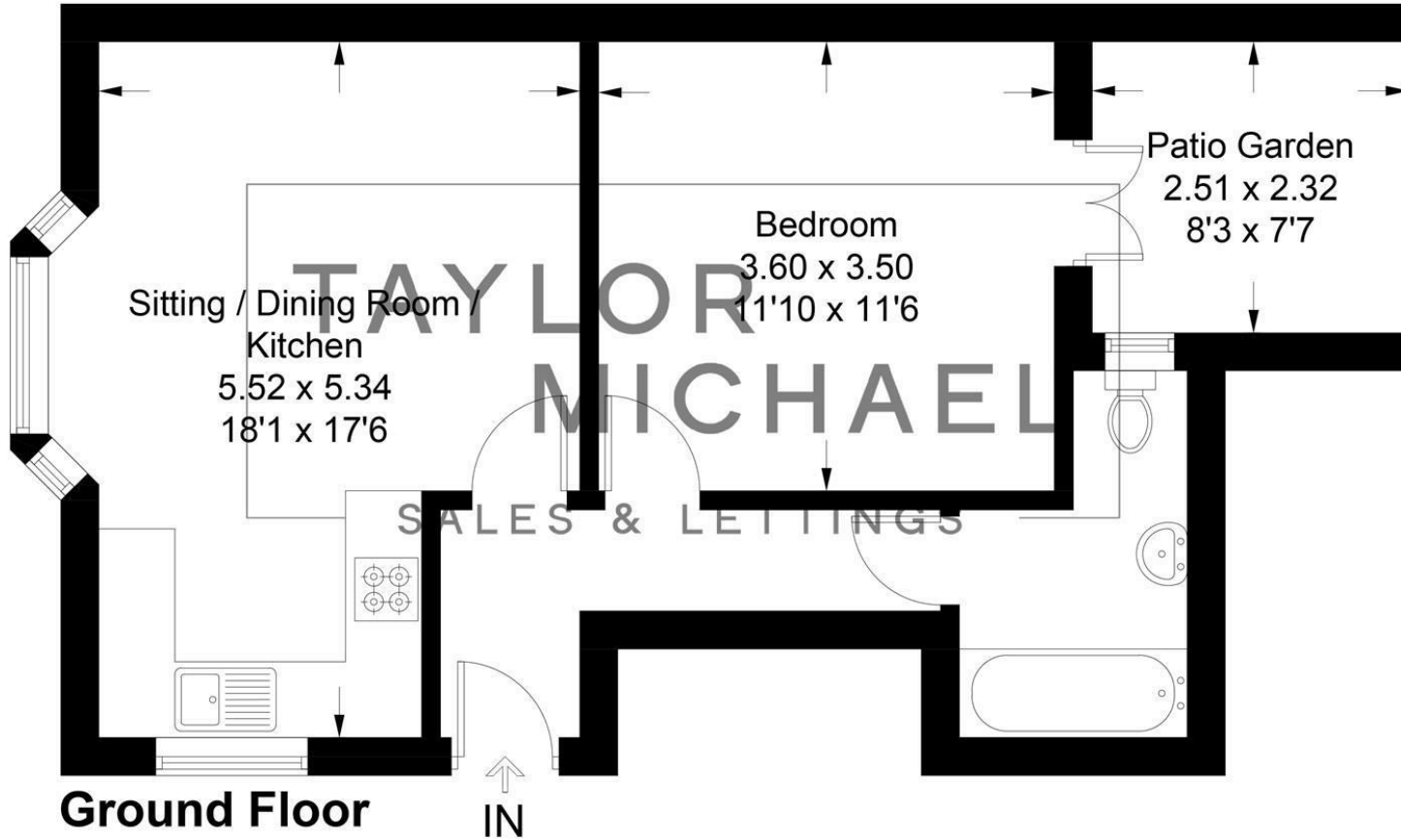

Illustration for identification purposes only, measurements are approximate, not to scale.
Imageplansurveys @ 2025

Energy Efficiency Rating		
	Current	Potential
Very energy efficient - lower running costs		
(92 plus) A		
(81-91) B		
(69-80) C		
(55-68) D		
(39-54) E		
(21-38) F		
(1-20) G		
Not energy efficient - higher running costs		
	70	78

EU Directive 2002/91/EC

England & Wales

DIRECTIONS

CONTACT

62 Church Road
Hove
East Sussex
BN3 2FP

E: lettings@taylormichael.agency
T: 01273 600100
<https://taylormichael.agency/>

TAYLOR
MICHAEL