

... Your proactive estate agent



Station Road, Ackworth, Pontefract, WF7 7HP
Offers In Excess Of £400,000





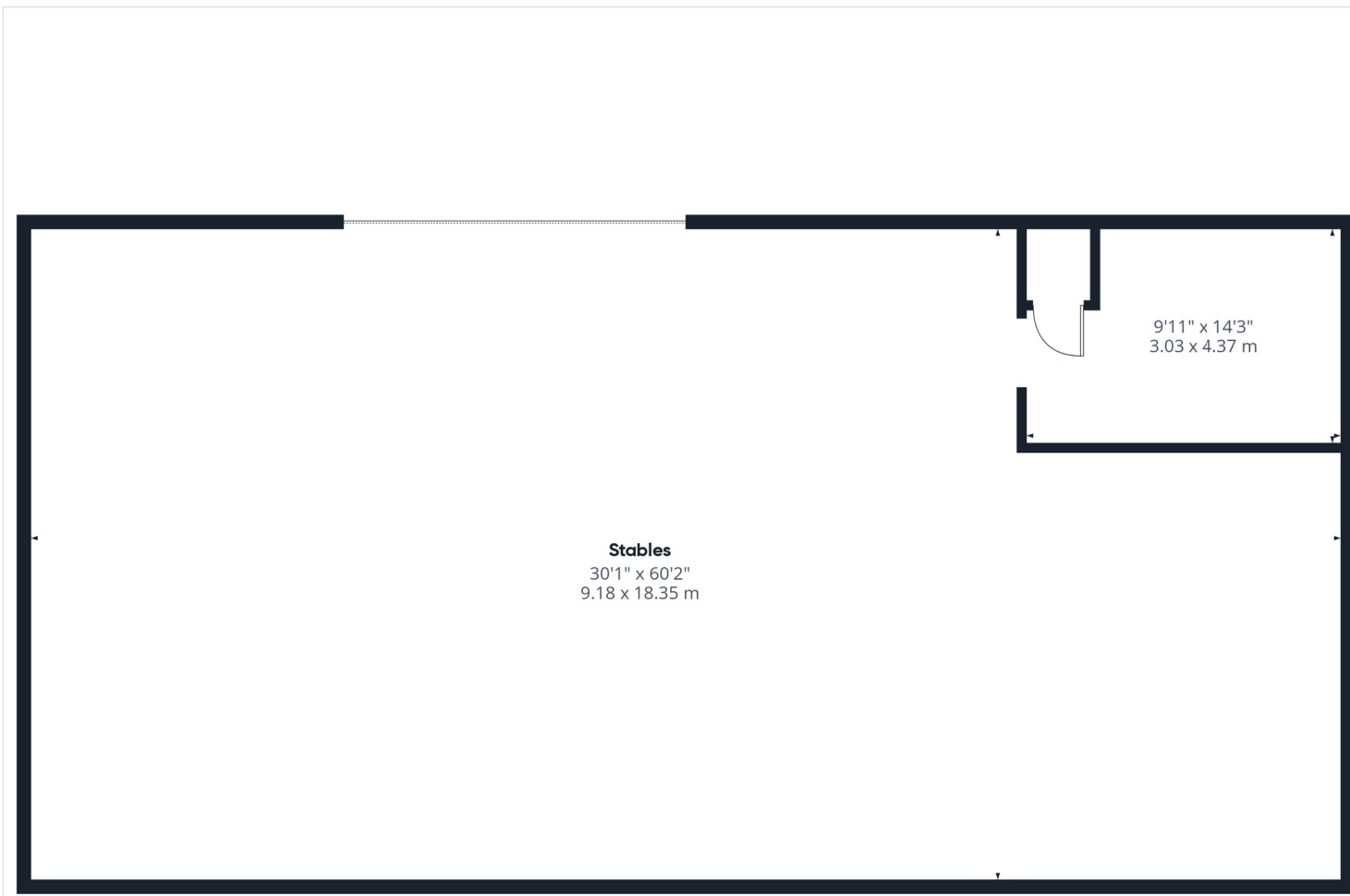

Stables
30'1" x 60'2"
9.18 x 18.35 m

9'11" x 14'3"
3.03 x 4.37 m

Approximate total area^m
1792 ft²
166.5 m²

(1) Excluding balconies and terraces

Calculations reference the RICS IPMS
3C standard. Measurements are
approximate and not to scale. This
floor plan is intended for illustration
only.

GIRAFFE360



T 01977 791133
W www.parkrow.co.uk
30 Newgate, Pontefract, West Yorkshire, WF8 1DB
pontefract@parkrow.co.uk



T 01977 791133

W www.parkrow.co.uk

30 Newgate, Pontefract, West Yorkshire, WF8 1DB
pontefract@parkrow.co.uk

