



Constables
SALES & LETTINGS

The Parade

Parkgate, Neston

£98,500



A beautifully presented second floor retirement apartment suitable for the over 60s. It is in the sought after Deeside Court development on The Parade in Parkgate. The apartment enjoys delightful views over the Dee Estuary towards the Welsh hills.

The accommodation is incredibly well-presented and comprises: entrance hallway with large built in mirrored storage cupboards, a spacious lounge with bay window and feature fireplace and an archway into the kitchen which has an integrated oven and an electric hob and a window (a rare addition in this building). There is a one double bedroom with built in wardrobes and a stylish shower room.

The development has a communal lounge facing the Dee Estuary and beautiful landscaped gardens to the rear. There is a shared laundry room. A guest suite is available on the ground floor. An emergency call system is installed in the apartment with pull cords in lounge, bedroom and bathroom and there is a non-resident house manager.

Parking space included with this apartment.

Parkgate offers an excellent range of bars and restaurants. There is a bus stop close by providing access to Neston town centre which has more comprehensive amenities, as well as further afield to Chester and Heswall.

Constables

SALES & LETTINGS

- Second Floor Retirement Apartment
- Well Appointed Throughout

- Dedicated Parking Space
- Lift To All Floors

- Large Bay Window Overlooking Estuary
- No Onward Chain

Entrance Hall

Kitchen

6'11 x 6'11 (2.11m x 2.11m)

Lounge

17'9 x 10'4 (5.41m x 3.15m)

Master Bedroom

14'4 x 8'10 (4.37m x 2.69m)

Bathroom

6'11 x 6'6 (2.11m x 1.98m)





EPC & Floor Plan

Energy Efficiency Rating		
	Current	Potential
<i>Very energy efficient - lower running costs</i>		
(92 plus) A		
(81-91) B		
(69-80) C		73
(55-68) D	61	
(39-54) E		
(21-38) F		
(1-20) G		
<i>Not energy efficient - higher running costs</i>		
England & Wales	EU Directive 2002/91/EC	

Ground Floor

Approx. 45.6 sq. metres (491.0 sq. feet)

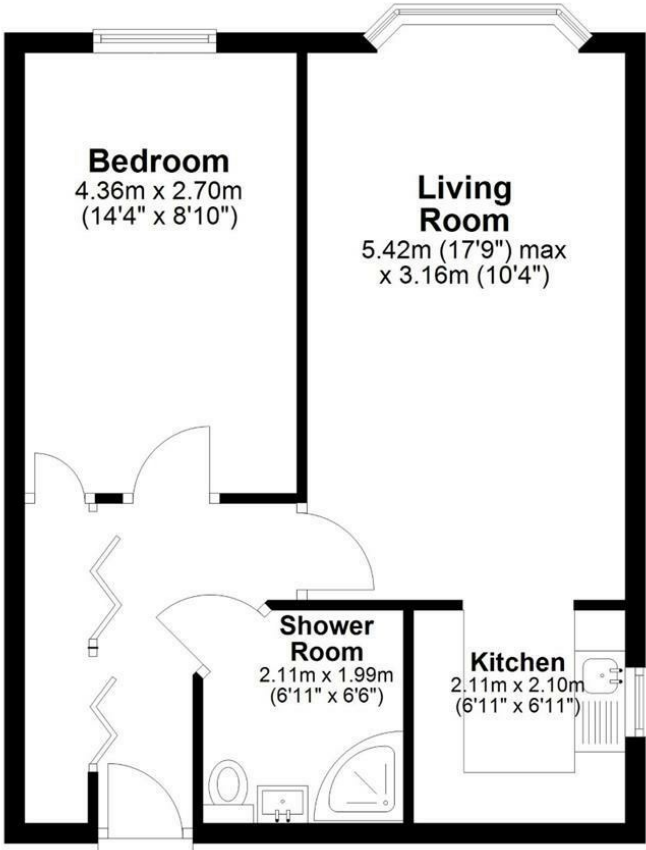

Total area: approx. 45.6 sq. metres (491.0 sq. feet)

30 Deeside Court, Parkgate, NESTON

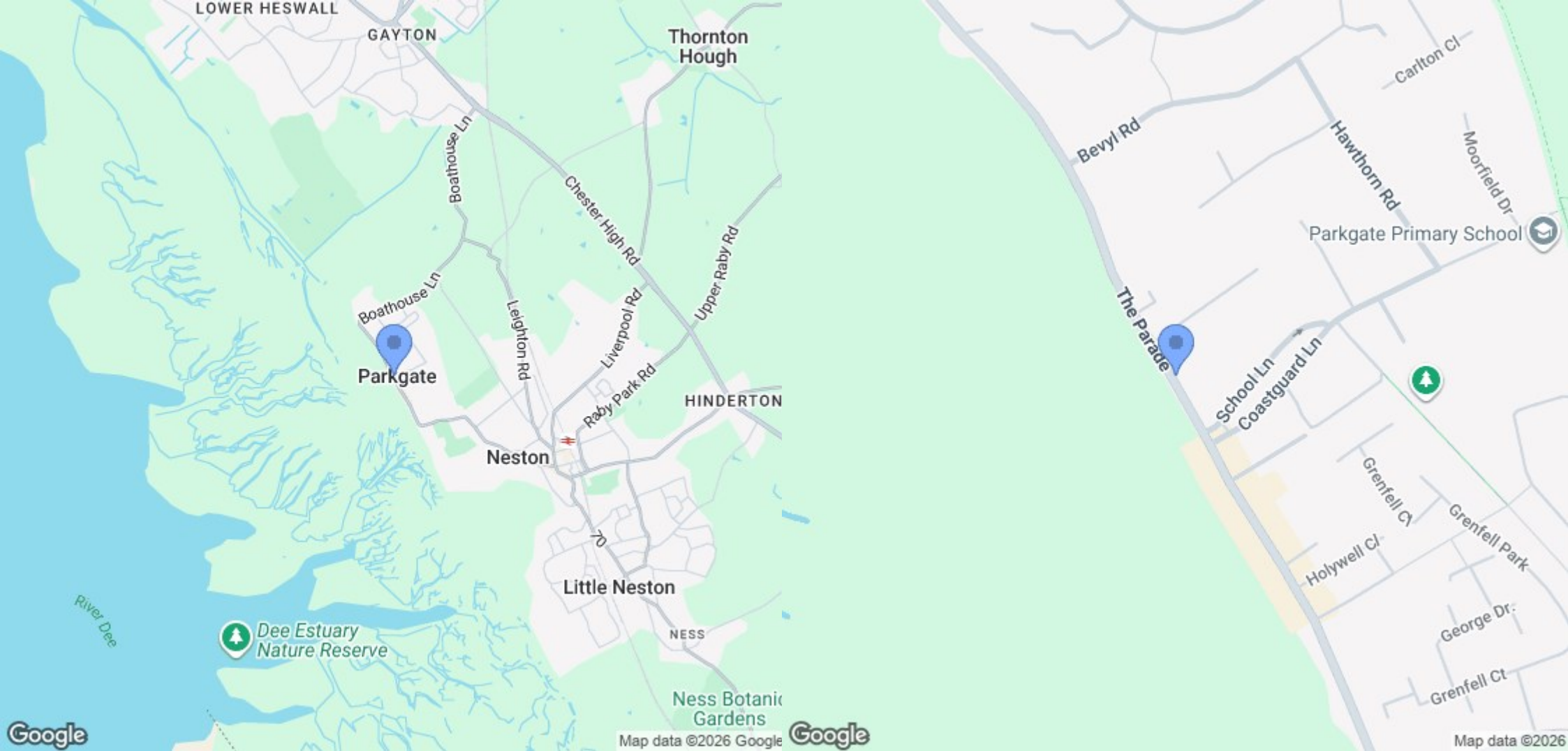

Location Map

Constables

S A L E S & L E T T I N G S

21 High Street, Neston

South Wirral, Neston, Cheshire

www.constablesestateagents.co.uk

info@constablesestateagents.co.uk

0151 353 1333