



## 20, Arnewood Gardens, Yeovil, Somerset BA20 2LQ Offers Over **£300,000**

Towers Wills are delighted to welcome to market this very well presented two bedroom detached bungalow, situated in a highly sought-after area of Yeovil along West Coker Road. Renovated to a high specification in 2020, the property boasts a modern kitchen, bathroom and en suite, modern windows and boiler, and offers stylish one-level living. Further benefits include driveway parking, carport, garage, and a private rear garden. Ideally positioned in a cul-de-sac location within walking distance of local amenities including a convenience store, pharmacy and hairdresser, and close to a nearby park perfect for leisurely walks or dog walking. Available with no onward chain.

## Accommodation:

### Entrance Hall

Open plan to the lounge/diner with radiator, cupboard and access to the loft. Doors to kitchen/breakfast room, bathroom and bedroom two.

### Lounge/Diner – 3.99m max x 6.17m max

A spacious living area with two radiators, two sets of French doors opening to the rear garden, loft access and cupboard.

### Kitchen/Breakfast Room – 4.00m x 5.19m max

Fitted with a modern range of units and high-spec appliances, comprising one-and-a-half bowl sink/drainers with boiling water tap, integrated dishwasher, integrated washing machine, space for fridge/freezer, integrated electric hob with extractor over, and self-cleaning electric Neff oven. Two double glazed windows to front, radiator and double glazed door to side providing access to carport.

### Bathroom

Suite comprising bath with shower over, wash hand basin, WC, heated towel rail and double glazed window to rear.

### Bedroom One – 4.24m max x 5.16m max (irregular shape)

Double glazed window to front, radiator and dressing area that opens to en suite.

### En Suite

Comprising shower cubicle, WC, wash hand basin, heated towel rail and double glazed window to side.

### Bedroom Two – 3.18m max x 3.70m max

With built-in wardrobe, radiator and double glazed window to rear.

## Outside:

To the front, a gated driveway provides ample off-road parking with carport, garage and outside tap. The front garden is mainly laid to lawn with planted borders and mature shrubs.

The rear garden enjoys a private aspect with patio area, planted borders and mature shrubs.

### Garage 4.78m x 2.78m

With up-and-over door to front, power, light, double glazed window and personal door to rear garden.

## Key Features

- Detached Bungalow
- Renovated to High Specification
- Two Double Bedrooms (Master En Suite)
- Driveway, Carport & Garage
- Front & Rear Gardens
- Highly Sought-After Location
- No Onward Chain

## Contact Us

### Towers Wills Estate Agents - Yeovil

114, Hendford Hill

Yeovil

Somerset

BA202RF

T: 01935 577032

E: [info@towerswills.co.uk](mailto:info@towerswills.co.uk)

## Energy Efficiency

Score	Energy rating	Current	Potential
92+	A		
81-91	B		81 B
69-80	C		
55-68	D	59 D	
39-54	E		
21-38	F		
1-20	G		



# Floor Plan

## GROUND FLOOR

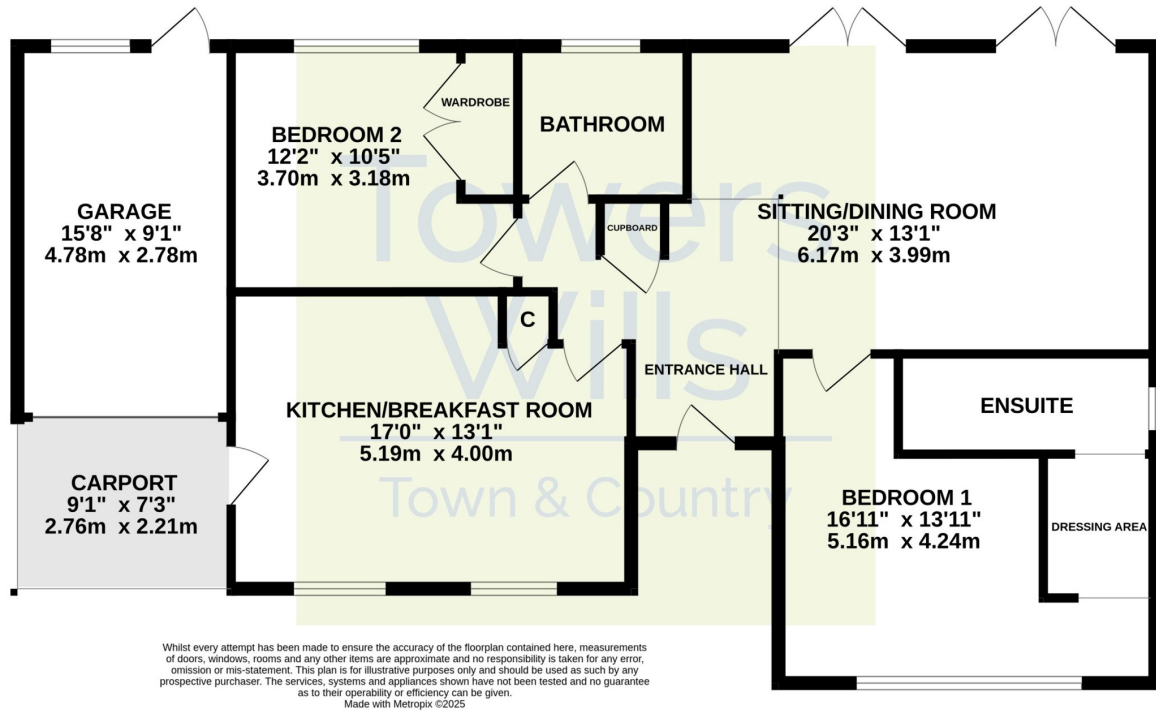

Please Note No tests have been undertaken of any of the services and any intending purchasers should satisfy themselves in this regard. Towers Wills Ltd for themselves and for the vendor of this property whose agents they are, give notice that, (i) these particulars do not constitute any part of an offer or contract, (ii) all statements contained within these particulars are made without responsibility on the part of Towers Wills or the vendor, (iii) whilst made in good faith, none of the statements contained within these particulars are to be relied upon as a statement of representation or fact, (iv) any intending purchaser must satisfy him/herself by inspection or otherwise as to the correctness of each of the statements contained within these particulars, (v) the vendor does not make or give either Towers Wills or any person in their employment any authority to make or give representation or warranty whatsoever in relation to this property.

Photographs / Floor Plans Photographs are reproduced for general information and it must not be inferred that any item is included for sale with this property. Please note floor plans are not to scale and are for identification purposes only. The photographs used in these particulars may have been taken with the use of a wide angle lens. If you have any queries as to the size of the accommodation or plot, please address these with the agent prior to making an appointment to view

**Towers Wills**

The White House, 114 Hendford Hill, Yeovil BA20 2RF

Yeovil 01935 577032 / South Petherton 01460 298530

[info@towerswills.co.uk](mailto:info@towerswills.co.uk) | [www.towerswills.co.uk](http://www.towerswills.co.uk)