

for sale

£250,000



Pound Close Lyneham Chippenham SN15 4PJ

This well-presented two bedroom end-of-terrace home, situated in a cul-de-sac, offers comfortable and practical living. Ideal for first-time buyers, investors or those looking to downsize. Viewing is essential to fully appreciate this lovely home.



Pound Close Lyneham Chippenham SN15 4PJ

Description

Situated in a quiet residential cul-de-sac within the popular village of Lyneham, this well-presented two bedroom end-of-terrace home offers comfortable and practical living, ideal for first-time buyers, investors or those looking to downsize.

The property opens into a welcoming entrance hall leading through to a bright and well-proportioned living room, providing a pleasant space for everyday living and entertaining. To the rear, the modern kitchen/dining area offers ample worktop and storage space, with room for a dining table and direct access to the garden—perfect for indoor-outdoor living. There is also a useful Utility Room.

Upstairs, the accommodation comprises two bedrooms, including a generous principal bedroom and a second bedroom suited to a

guest room, home office or child's room. A contemporary family bathroom completes the first floor.

Externally, the property benefits from being an end terrace, enjoying additional privacy and outdoor space. The rear garden is enclosed and low maintenance, ideal for relaxing or entertaining, while the front of the property offers an attractive approach.

Conveniently located close to local amenities, schools and transport links, 34 Pound Close is well placed for access to Chippenham, the M4 corridor and surrounding countryside, making it an excellent choice for a range of buyers.



Ground Floor

Entrance Hall

Stairs rising to the First Floor. Window to front. Door to Kitchen/Diner.

Lounge

Window to front. Door to Lounge/Diner.

Kitchen/Diner

Fitted with a matching range of base and wall units with complementary work surfaces over with inset sink and drainer. Integrated oven and hob. Plumbing for dishwasher. French doors to rear. Door to Utility Room.

Utility Room

Base and wall units with complementary work surfaces and sink unit. Plumbing for washing machine. Window to rear.

First Floor

Landing

Stairs from Ground Floor. Doors to all rooms.

Bedroom One

Window to front. Built in cupboard.

Bedroom Two

Window to rear. Built in wardrobes.

Bathroom

Suite comprising low level WC, wash hand basin and bath with shower over. Window to rear.

Outside

Front & Side

Pathway leading to front entrance door. The front and side gardens are laid to lawn.

Rear Garden

Fully enclosed. Large decking area providing a great entertaining space. Lawn area and further decking area at the end of the garden.



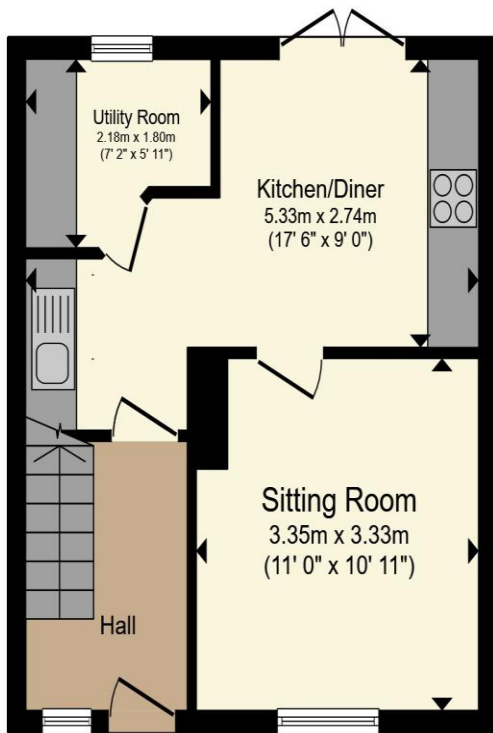

Ground Floor

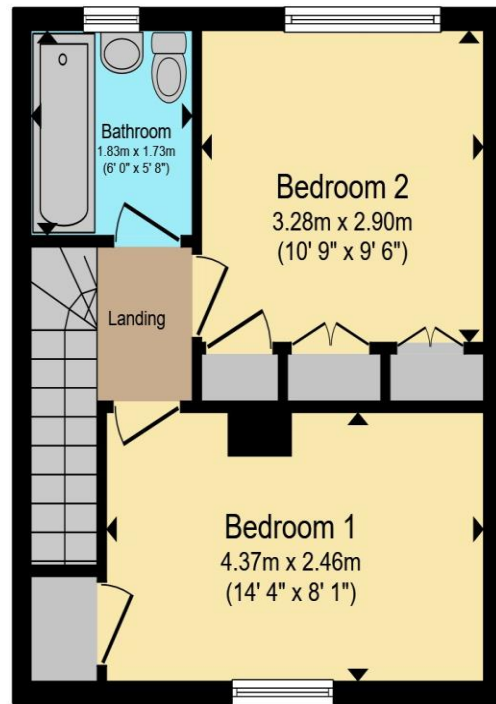

First Floor

Total floor area 66.1 m² (711 sq.ft.) approx

This floor plan is for illustrative purposes only. It is not drawn to scale. Any measurements, floor areas (including any total floor area), openings and orientation are approximate. No details are guaranteed, they cannot be relied upon for any purpose and they do not form part of any agreement. No liability is taken for any error, omission or misstatement. A party must rely upon its own inspection(s). Powered by www.propertybox.io



To view this property please contact Connells on

T 01249 652 476
E chippenham@connells.co.uk

59 Market Place
 CHIPPENHAM SN15 3HL

Property Ref: CHM306566 - 0003

Tenure:Freehold EPC Rating: D

Council Tax Band: B

view this property online connells.co.uk/Property/CHM306566



1. MONEY LAUNDERING REGULATIONS Intending purchasers will be asked to produce identification documentation at a later stage and we would ask for your co-operation in order that there will be no delay in agreeing the sale. 2. These particulars do not constitute part or all of an offer or contract. 3. The measurements indicated are supplied for guidance only and as such must be considered incorrect. Potential buyers are advised to recheck measurements before committing to any expense. 4. We have not tested any apparatus, equipment, fixtures, fittings or services and it is in the buyers interest to check the working condition of any appliances.

Connells Residential is registered in England and Wales under company number 1489613, Registered Office is Cumbria House, 16-20 Hockliffe Street, Leighton Buzzard, Bedfordshire, LU7 1GN. VAT Registration Number is 500 2481 05.

see all our properties at www.connells.co.uk | www.rightmove.co.uk | www.zoopla.co.uk