



## CHISWICK ROAD, W4

£295,000

Perfect for a pied-à-terre, first-time buyer, or investor. A top-floor one-bedroom apartment in the heart of Chiswick, offered with a long lease, communal garden, and no onward chain.

Top floor  
One bedroom  
Communal garden

Close to transport  
No onward chain  
Energy rating: d

# STEP INSIDE CHISWICK ROAD

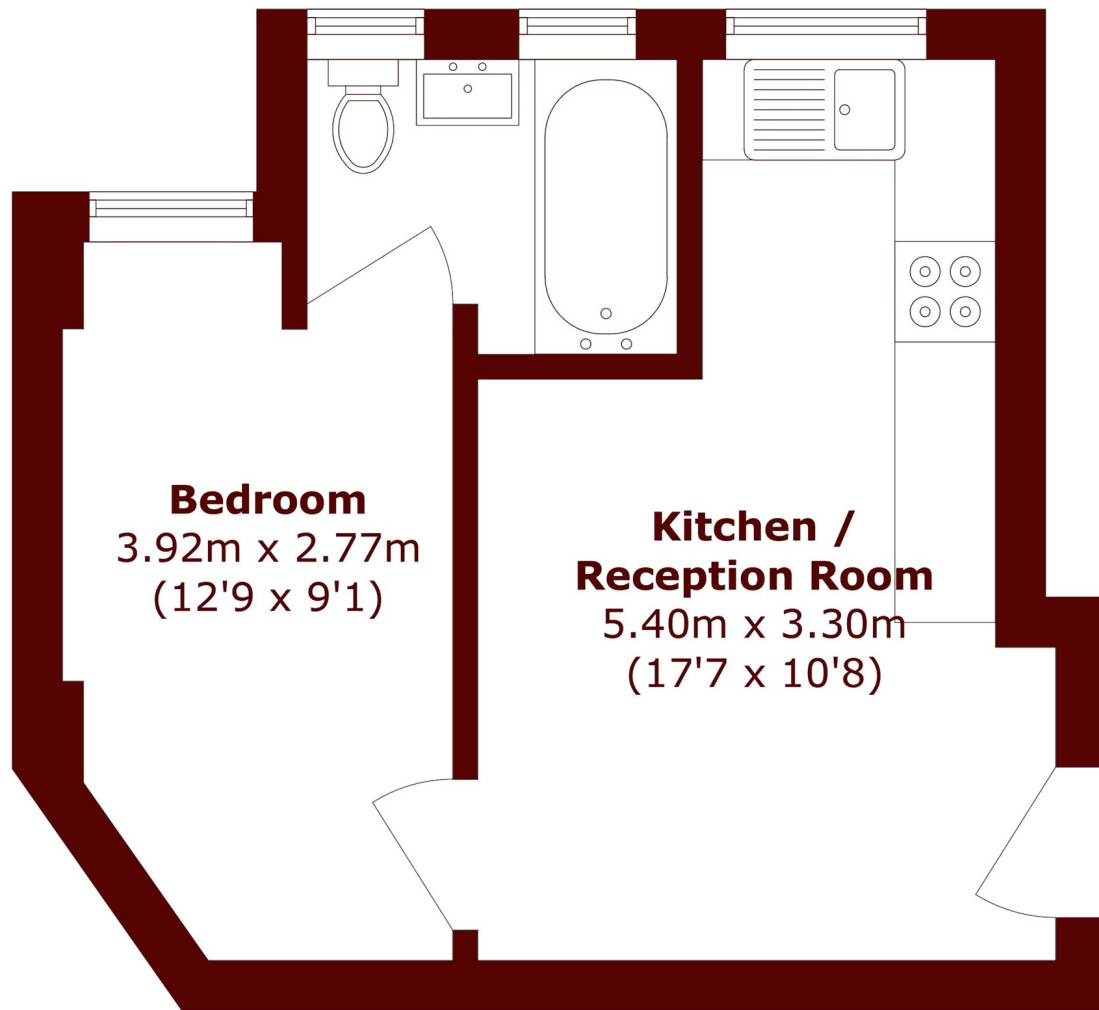

**Bedroom**  
3.92m x 2.77m  
(12'9 x 9'1)

**Kitchen /  
Reception Room**  
5.40m x 3.30m  
(17'7 x 10'8)

Total area (approx.): 28.5 sq. m (306.8 sq. ft)

Chiswick  
020 8994 2556

Energy Rating: D We aim to make our particulars both accurate and reliable. However, they are not guaranteed; nor do they form part of an offer or contract. If you require clarification on any points then please contact us, especially if you're traveling some distance to view. Please note that appliances and heating systems have not been tested and therefore no warranties can be given as to their good working order

**MARSH &  
PARSONS**