



## Bartholomew Court

Edgware

£575,000

Davidson Frost-Wellings are pleased to offer this two bedroom, two bathroom first floor flat conveniently located walking distance from local shops and transport link.

This flat is located close to Canons Park Station (Jubilee Line), local amenities, and highly regarded schools such as Whitchurch Primary, Avanti House School and North London Collegiate Schools. This property presents excellent opportunity for first-time buyers or as investment venture

Leasehold 97 Years  
 Service charge £2450 pa  
 Ground rent £400 pa  
 Council Tax Band F

- Two bedrooms
- Two bathrooms
- Allocated parking space
- Gated development with lift
- Master Bedroom With En-Suite
- Close to Canons park station (Jubilee Line)

### Viewing

Please contact our Davidson Frost-Wellings Office on 020 8954 8806 if you wish to arrange a viewing appointment for this property or require further information.

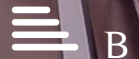

## Floor Plan

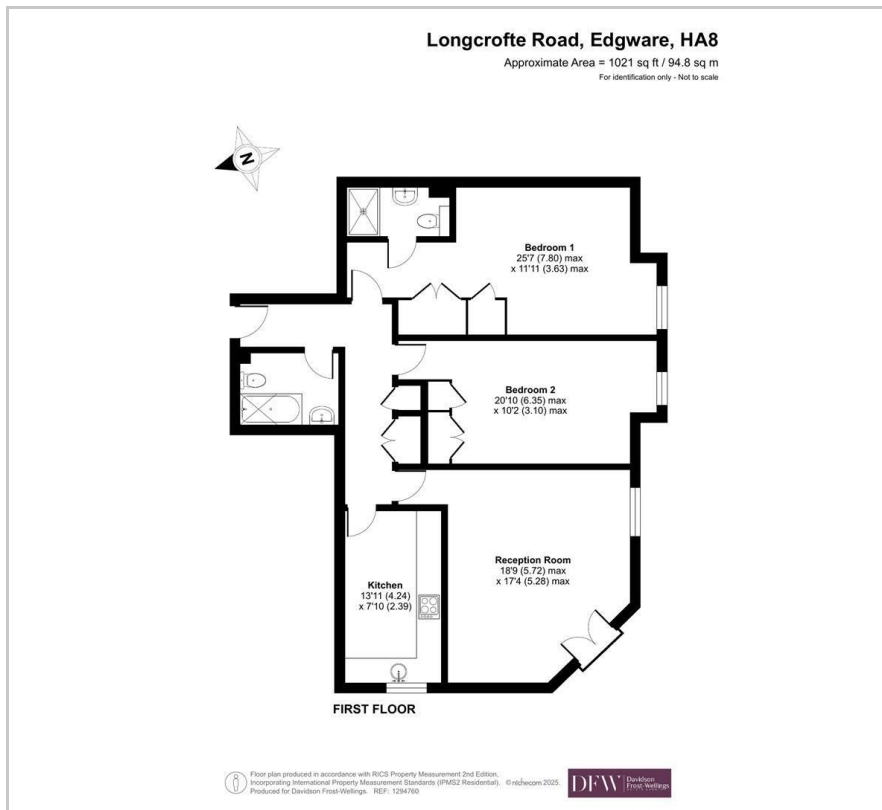

## Area Map

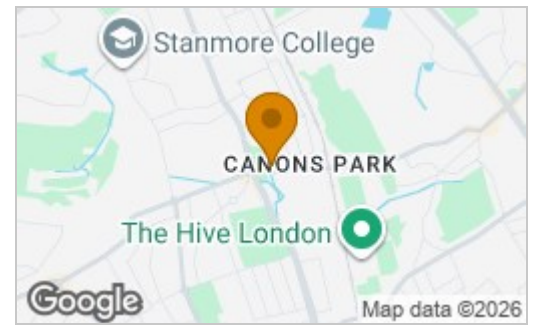

### Energy Efficiency Rating

	Current	Potential
<i>Very energy efficient - lower running costs</i>		
(92 plus) <b>A</b>		
(81-91) <b>B</b>	<b>81</b>	<b>83</b>
(69-80) <b>C</b>		
(55-68) <b>D</b>		
(39-54) <b>E</b>		
(21-38) <b>F</b>		
(1-20) <b>G</b>		
<i>Not energy efficient - higher running costs</i>		
<b>England &amp; Wales</b>	EU Directive 2002/91/EC	



These particulars, whilst believed to be accurate are set out as a general outline only for guidance and do not constitute any part of an offer or contract. Intending purchasers should not rely on them as statements of representation of fact, but must satisfy themselves by inspection or otherwise as to their accuracy. No person in this firm's employment has the authority to make or give any representation or warranty in respect of the property.