



## 19 Countess Crescent, Bispham, Blackpool, FY2 9LQ

**£194,950**

**A DETACHED Bungalow, in a super location less than 500m from both the Promenade and also the increasingly popular Red Bank Road with all its amenities. No.19 has a really impressive frontage, which could be perfect if you are looking for extra Parking, and is ready to walk into whilst still being that perfect blank canvas to really make you own. Sold with NO ONWARD CHAIN.**

- Lounge
- Breakfast Kitchen
- Three Bedrooms
- Shower room
- UPVC double glazing
- Gas central heating
- Gardens - Westerly facing rear
- Garage - over 21' - and additional Parking



**McDonald**  
Estate Agents

**Fylde Coast Property Hub**

81-83 Red Bank Road, Bispham, FY2 9HZ  
01253 398 498

📞 sales@mcdonaldproperty.co.uk  
🌐 www.mcdonaldproperty.co.uk



Award winning property sales since 1948.



**Vestibule:** Meter cupboard, UPVC double glazed door.

**Hall:** Walk in cupboard housing gas central heating boiler, Coved ceiling, Radiator.

**Lounge:** 14'1" x 11'3" (4.29 m x 3.43 m) Polished wood fireplace, Coved ceiling, TV point, UPVC double glazed window, Radiator.

**Breakfast Kitchen:** 16'9" x 9'0" (5.11 m x 2.74 m) Wall and base cupboard units with complementary roll edge worktops and matching breakfast bar, Split level oven and hob with extractor, One and a half bowl sink with mixer tap, Plumbed for washing machine, UPVC double glazed windows and door, Radiator.

**Shower Room:** Comprising; Step in shower, Low flush WC, Pedestal wash basin.

**Bedroom 1:** 12'3" x 10'0" (3.73 m x 3.05 m) Fitted wardrobes, Coved ceiling, UPVC double glazed bay window, Radiator.

**Bedroom 2:** 9'5" x 8'7" (2.87 m x 2.62 m) Built in cupboard, UPVC double glazed window, Radiator.

#### **First Floor:**

**Bedroom 3:** 12'3" x 11'8" (3.73 m x 3.56 m) Built in wardrobes, UPVC double glazed window, Radiator.

**En-Suite WC:** Comprising; Low flush WC, Vanity wash basin, Extractor, Towel heater radiator.

#### **Outside:**

**Front:** An impressive frontage, laid to a combination of lawn and paving.

**Rear:** Westerly facing mainly paved with established beds.

**Parking:** Attached garage around 21' in length, and plenty of additional parking to the front.

**Heating:** Gas central heating (NOT TESTED).

**Tenure:** We have been informed that the property is freehold. Prospective purchasers should seek clarification of this from their Solicitors.

**Council Tax:** Band - C £2233.97 (2026/27)



**Directions:** From our office on Red Bank Road, proceed directly south along Warbreck Drive, Countess Crescent is the third turning on the left.

**General Disclaimer:** Whilst every care has been taken in the preparation of these details, interested parties should seek clarification from their solicitor and surveyor as their complete accuracy cannot be guaranteed. These particulars do not constitute a contract or part of a contract. **Measurements:** Room dimensions are approximate, with maximum dimensions taken where rooms are not a simple rectangle. Measured into bays and recesses where appropriate. Floorplans are for general guidance and are not to scale.

**Photography:** Images are for representation only and items shown do not infer their inclusion. **Fixtures, Fittings & Appliances:** Unless stated otherwise, these items have not been tested and therefore no guarantee can be given that they are in good working order.

Energy Efficiency Rating		Current	Potential
Very energy efficient - lower running costs			
(92 plus)	<b>A</b>		
(81-91)	<b>B</b>		
(69-80)	<b>C</b>		73
(55-68)	<b>D</b>	56	
(39-54)	<b>E</b>		
(21-38)	<b>F</b>		
(1-20)	<b>G</b>		
Not energy efficient - higher running costs			

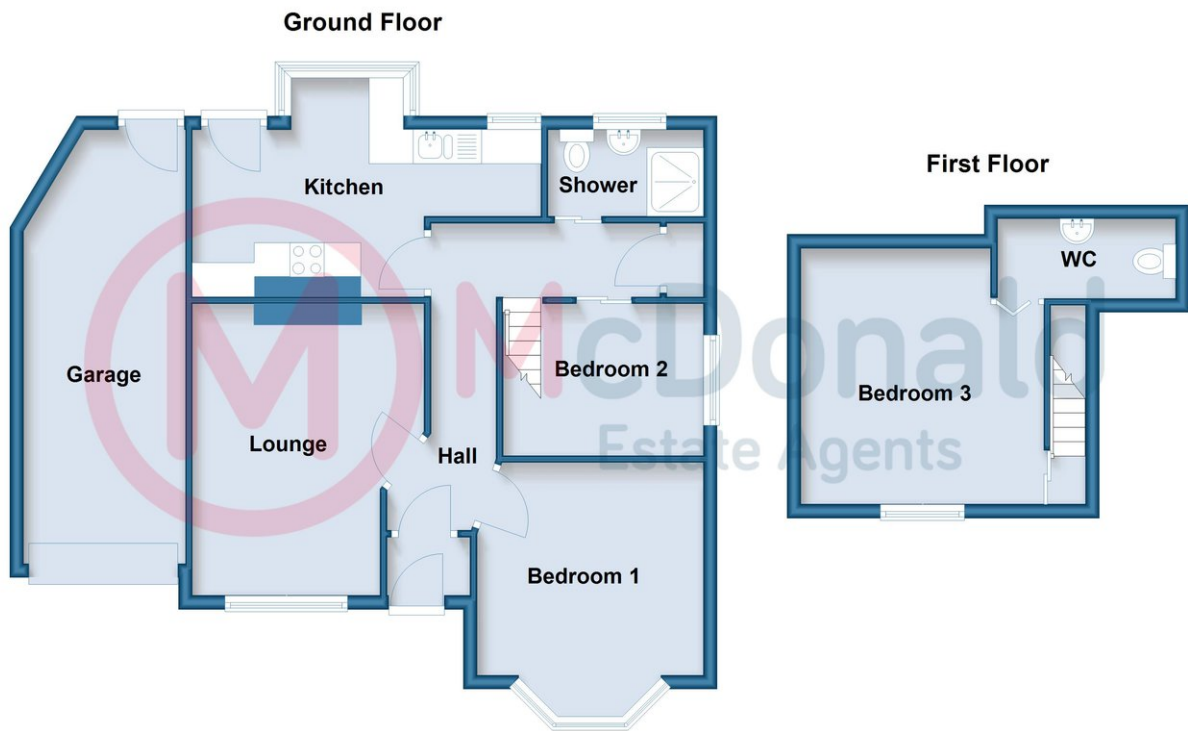

Whilst every care has been taken in the preparation of these details, accuracy cannot be guaranteed. These particulars do not constitute a contract or part of a contract. Room dimensions (where shown) are approximate. Floorplans are for general guidance and are not to scale. Plan produced using PlanUp.

**Countess Crescent**

Are YOU thinking of selling?  
 Call McDonald Estate Agents NOW, for  
 your FREE market appraisal.

Award winning property sales since 1948.

