



Ealing Road, TW8

£350,000

A modern two bedroom, purpose-built apartment in this sought-after development. With open plan kitchen/ reception, lift access, balcony, allocated underground parking and long lease.

Trico House is located a quarter of a mile from Brentford mainline station which offers a direct link into London Waterloo. South Ealing underground station (Piccadilly Line) which has a direct service into London Heathrow is under half a mile away.

Features

- Seventh Floor
- Modern
- Two Double Bedrooms
- Balcony
- Allocated Underground Parking
- Close To Transport

Ealing Road,
Brentford, TW8

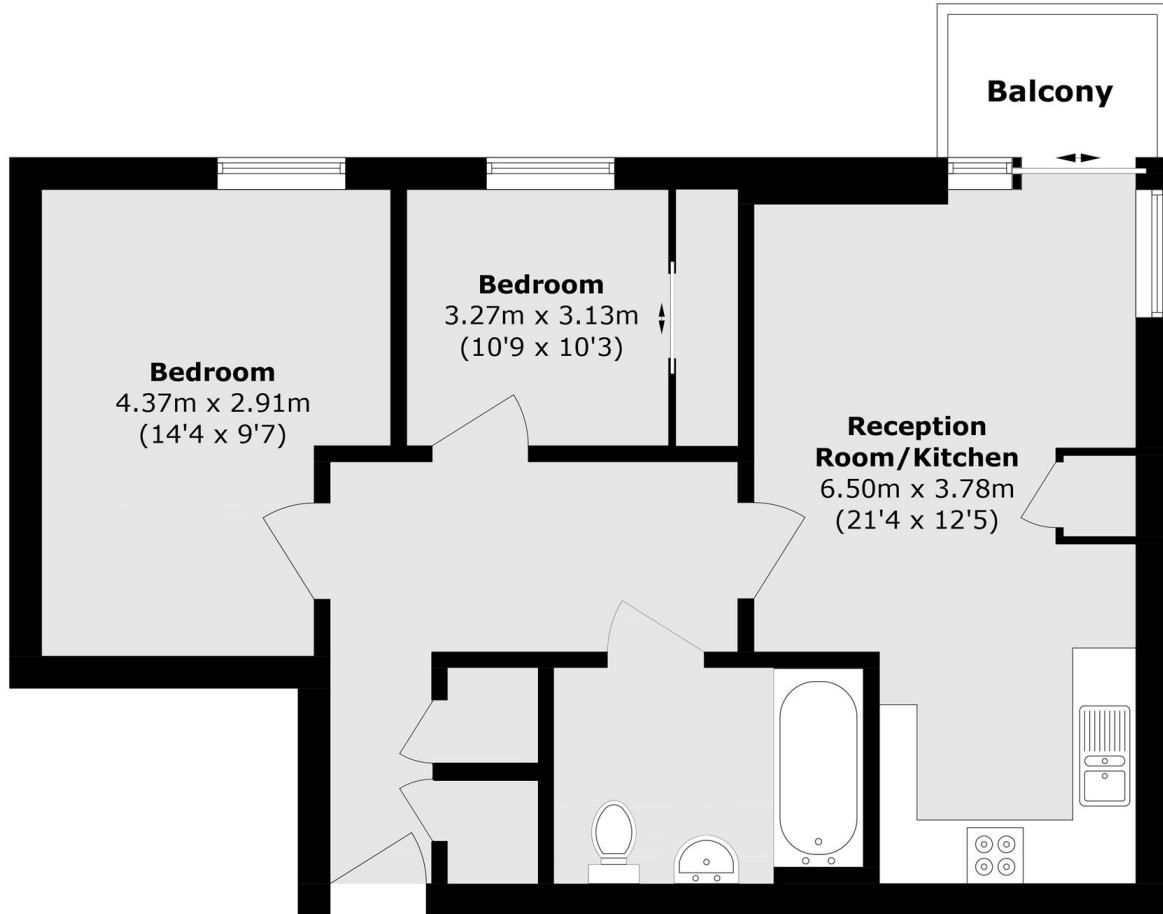

Seventh Floor

Total area (approx.): 60.8 sq. m (654.4 sq. ft)

Balcony area (approx.): 1.6 sq. m (17.2 sq. ft)