

Broadheath Drive, Chislehurst, BR7

4 2 1



A well-presented four-bedroom family home arranged over three floors, offering spacious and versatile living, a modern kitchen, and a beautifully landscaped low-maintenance garden. The property also benefits from off-street parking for two cars and is ideally positioned in a sought-after Chislehurst location, with far-reaching London views and excellent access to local amenities and transport links.

Key Features

- Please Quote RF0924 for all enquiries
- A must-see property
- Four-bedroom family home arranged over three floors
- Spacious reception/dining room with excellent natural light
- Modern fitted kitchen with breakfast bar
- Ground floor bedroom ideal for guests or home office
- Utility room and ground floor bathroom
- Two double bedrooms & one single bedroom on the top floor
- Landscaped, low-maintenance tiered rear garden
- Well-located for local schools, transport links, and amenities

Broadheath Drive, Chislehurst, BR7

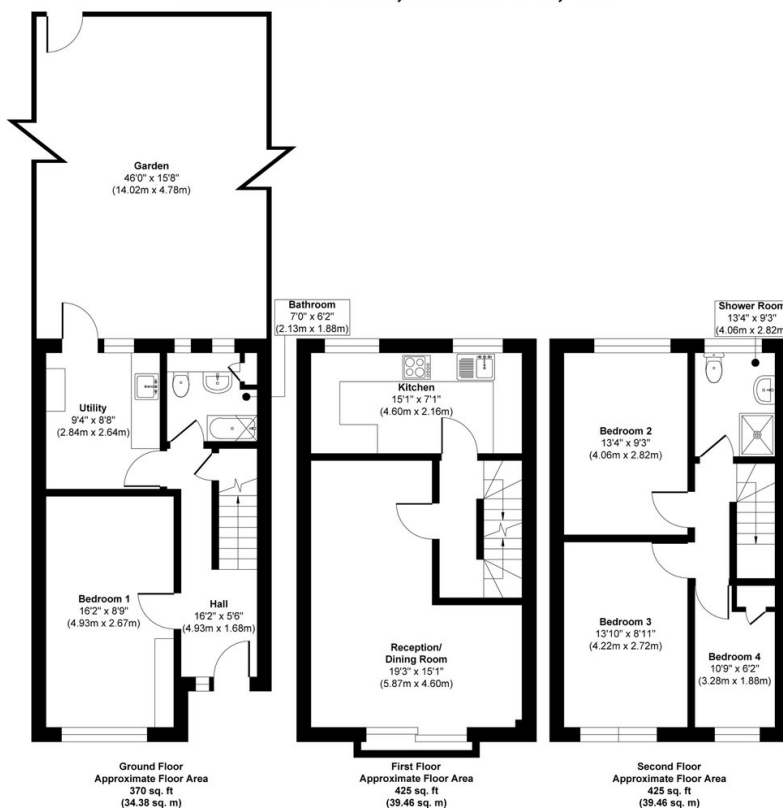

Approx. Gross Internal Floor Area 1220 sq. ft / 113.30 sq. m

Illustration for identification purposes only, measurements are approximate, not to scale.

Produced by Elements Property