

237 Fairmile Road
Christchurch
Dorset
BH23 2LQ

01202 487587

MICHAEL ADAM

post@michaeladam.co.uk

www.michaeladam.co.uk



These particulars are intended to give a fair description of the property, but their accuracy is not guaranteed and they do not constitute an offer or contract.

DRAFT DETAILS – AWAITING VERIFICATION FROM VENDOR

**23 BRONTE AVENUE
CHRISTCHURCH
BH23 2LZ**

Price £375,000

Freehold



A MODERN 3 BEDROOM TERRACED FAMILY HOME WHICH IS SITUATED IN THIS POPULAR LOCATION AND IS BEING OFFERED FOR SALE WITH NO FORWARD CHAIN.

THE MAIN HOUSE HAS AN OPEN PLAN LIVING/DINING/KITCHEN, 3 WELL PROPORTIONED BEDROOMS & MODERN SHOWER ROOM.

BENEFITS INCLUDE MODERN SHOWER ROOM, GAS FIRED CENTRAL HEATING, DOUBLE GLAZING, OFF ROAD PARKING AND SITUATED WITHIN THE TWYNHAM SCHOOL CATCHMENT AREA.

THE TOWN CENTRE IS APPROXIMATELY 1 MILE DISTANT WITH IT'S ARRAY OF SHOPS AND RECREATIONAL FACILITIES.

MUST BE VIEWED TO FULLY APPRECIATE.

23 BRONTE AVENUE, CHRISTCHURCH BH23 2LZ

- **MODERN TERRACED HOUSE**
- **TWYNHAM CATCHMENT**
- **NO FORWARD CHAIN**
- **OFF ROAD PARKING**
- **MODERN OPEN PLAN LIVING SPACE**
- **3 BEDROOMS**
- **MODERN SHOWER ROOM**
- **GAS FIRED CENTRAL HEATING**
- **DOUBLE GLAZING**
- **FOR MORE INFORMATION CALL**
01202 487587



VIEWING STRICTLY BY APPOINTMENT PLEASE

Please note that the equipment, fittings, fireplaces, heating systems, mains services, apparatus and appliances have not been tested by us the agents so we cannot confirm that they are in working order. All measurements are approximate and are for guidance only.

PLEASE NOTE:

MONEY LAUNDERING REGULATIONS – Intending purchasers will be asked to produce identification documentation at a later stage and we would ask for your co-operation in order that there will be no delay in agreeing the sale.

MICHAEL ADAM Estate Agents have not sought to verify the legal title of the property and the buyers must obtain verification from their solicitors.

23 BRONTE AVENUE, CHRISTCHURCH BH23 2LZ





Ground Floor

Approx. 41.0 sq. metres (441.7 sq. feet)

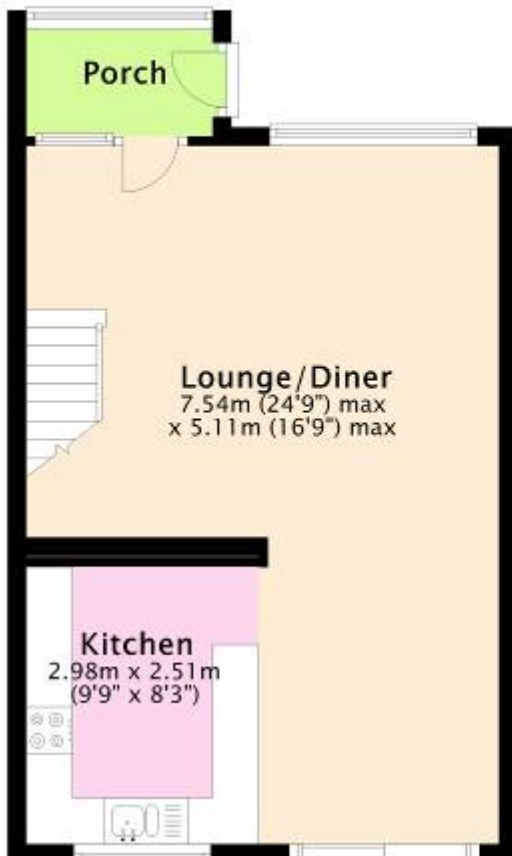

First Floor

Approx. 38.5 sq. metres (414.3 sq. feet)

