



Muirfield, W3

£650,000

A lovely three bedroom mid terraced home with a separate reception and dining room ideal for family living. The property has circa 900 sq.ft of internal living space and is arranged over two floors. The residence has significant potential to extend (STPP) as well produce driveway parking for multiple vehicles.

Located under ten minutes walking from East Acton station (Central line) and circa 1 mile from the Acton Main Line (Elizabeth line).

Features

- Three Bedrooms
- Two Reception Rooms
- Local Amenities Nearby
- Potential to Extend (STPP)
- Cul-De-Sac
- No Onward Chain

Muirfield, London, W3

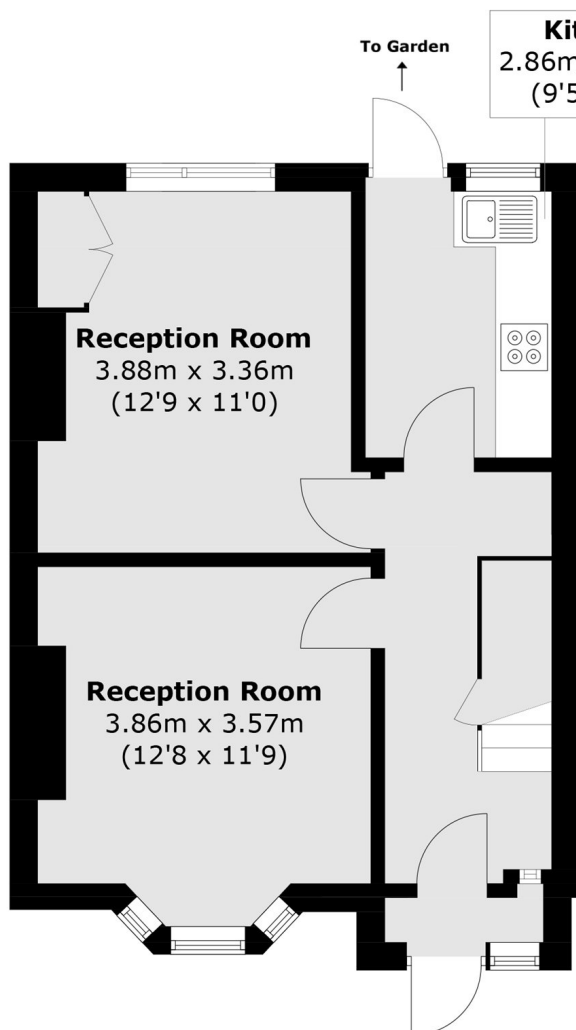

Ground Floor

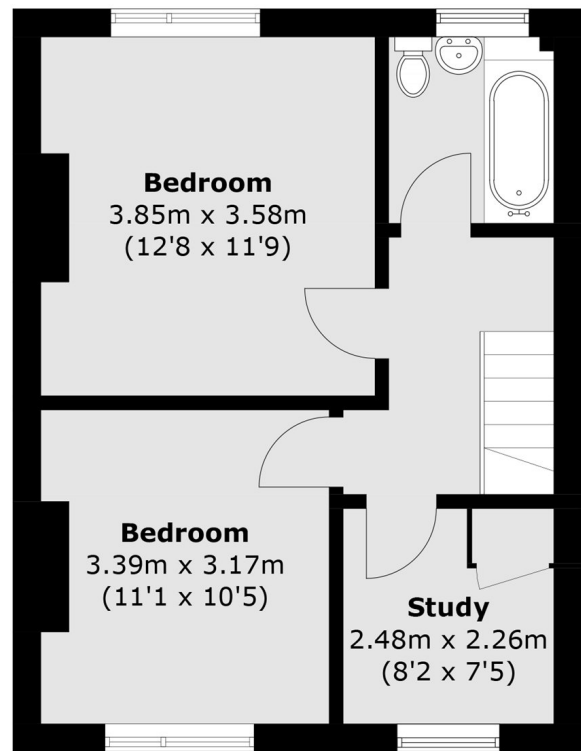

First Floor

Total area (approx.): 83.4 sq. m (897.7 sq. ft)