



JUNIPER DRIVE, SW18

£375,000

- Allocated parking space - option of renting the space out.
- Concierge service
- Luxury apartment
- Private balcony
- Popular location
- Energy rating: B





ABOUT THE HOME

A beautiful example of a luxury, Manhattan apartment located in the popular Battersea Reach development. This property offers a bright and spacious open plan living / kitchen room, with a generous storage cupboard upon entrance. There is a separate bedroom off the main living space with built in wardrobes and a luxury bathroom. This property is offered to the market with it's own private balcony and no onward chain.

Battersea Reach is a desirable riverside development which is ideally positioned for easy access to Central London via Wandsworth Town Station and Clapham Junction. Whilst being a short distance from the popular shops, bars and restaurants of Wandsworth Town and Northcote Road, it is also just across the bridge from Fulham. The Riverbus stop at Plantation Wharf offers a fast and convenient commute into the City and out to Canary Wharf.





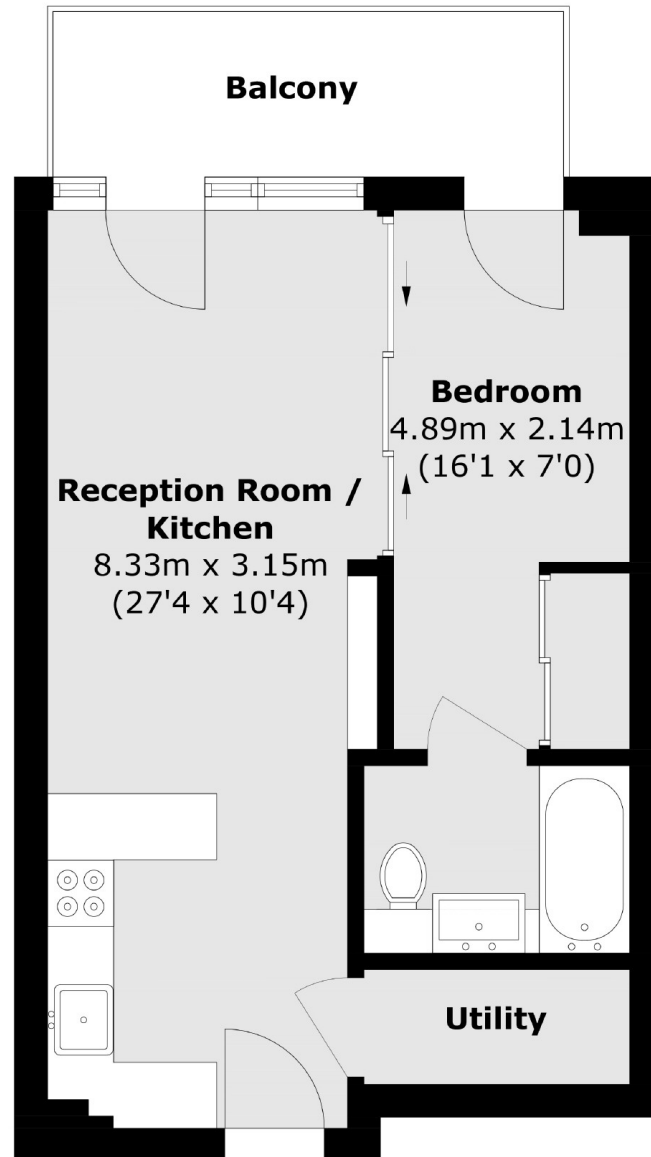

Total area (approx.): 42.9 sq. m (462.4 sq. ft)

Balcony area (approx.): 6.9 sq. m (74.8 sq. ft)

JACKSONS EARLSFIELD

372-374 Garratt Lane,
Earlsfield, London, SW18 4ES
Sales: 020 8971 7979
Lettings: 020 8971 7070

Energy Rating: C We aim to make our particulars both accurate and reliable. However they are not guaranteed; nor do they form part of an offer or contract. If you require clarification on any points then please contact us, especially if you're traveling some distance to view. Please note that appliances and heating systems have not been tested and therefore no warranties can be given as to their good working order.