



May Street, Derby

£925 PCM



Key Features

- Two Bedroom Terrace
- Short Walk to City Centre
- Rear Enclosed Garden
- On Street Parking
- Holding Deposit £213
- Available 20th July 2026
- Two well-sized reception rooms
- EPC rating E





Two bedroom UNFURNISHED terrace house, located within a short walk of the City Centre. Close to all road links A52, A38, A6, A5111.

The property briefly comprises of: Two receptions rooms, new modern kitchen oven & hob.

To the first floor are two double bedrooms. Bathroom with three piece suite and shower over bath.

The rear of the property is an enclosed lawn and decking area.

New décor & flooring.

On street parking is available.



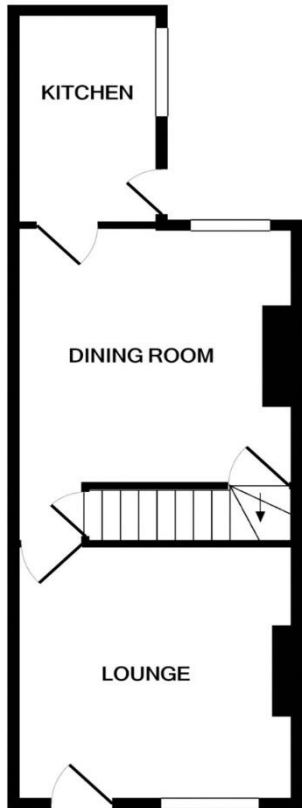

GROUND FLOOR
APPROX. FLOOR
AREA 31.8 SQ.M.
(342 SQ.FT.)



1ST FLOOR
APPROX. FLOOR
AREA 32.0 SQ.M.
(344 SQ.FT.)

TOTAL APPROX. FLOOR AREA 63.8 SQ.M. (687 SQ.FT.)

Whilst every attempt has been made to ensure the accuracy of the floor plan contained here, measurements of doors, windows, rooms and any other items are approximate and no responsibility is taken for any error, omission, or mis-statement. This plan is for illustrative purposes only and should be used as such by any prospective purchaser. The services, systems and appliances shown have not been tested and no guarantee as to their operability or efficiency can be given
Made with Metropix ©2020



