

FOLKLANDS



THORNTON AVENUE, CROYDON
MONTHLY RENTAL OF £1,950









Thornton Ave, Croydon

Approximate Gross Internal Area = 80.3 sq m / 865 sq ft

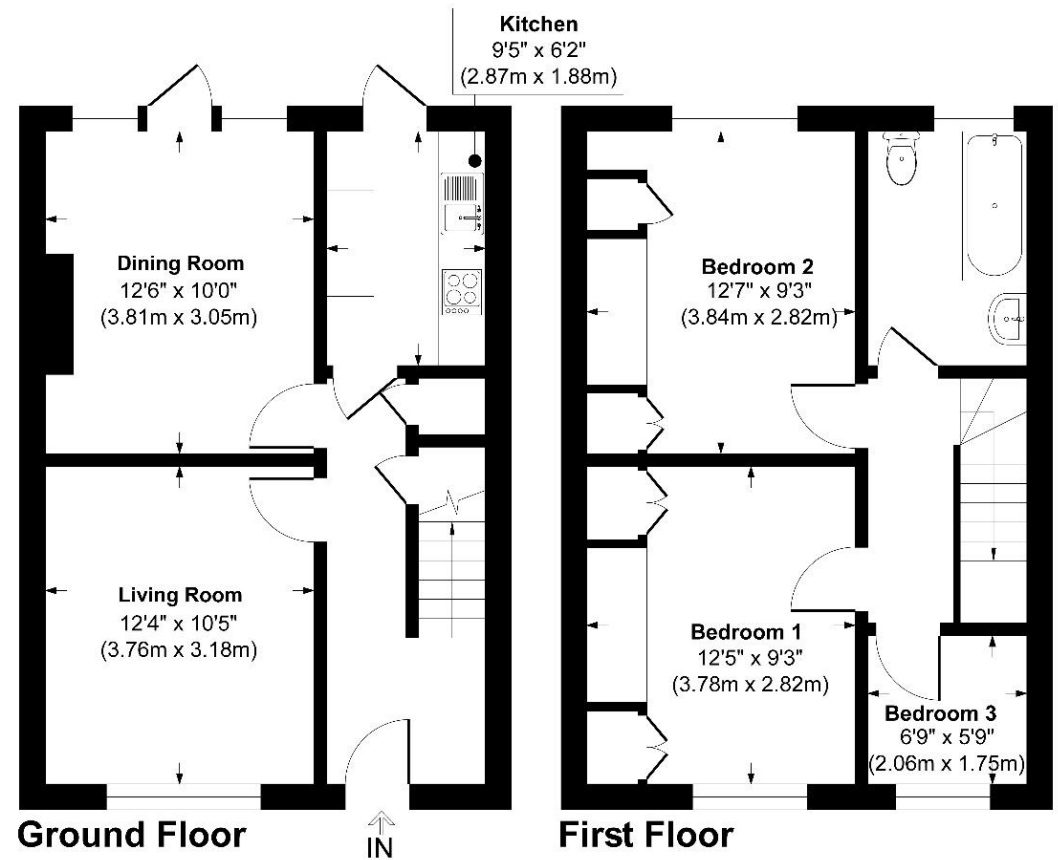

Illustration for identification purpose only, measurements approximate, and not to scale.

INFO@FOLKLANDS.COM - 020 8686 0002

362 BRIGHTON ROAD - SOUTH CROYDON - CR2 6AL

- ❖ AVAILABLE IMMEDIATELY
- ❖ UNFURNISHED
- ❖ THREE BEDROOM TERRACE HOUSE
- ❖ PRIVATE REAR GARDEN
- ❖ TWO RECEPTION ROOMS
- ❖ QUIET RESIDENTIAL ROAD
- ❖ 1.1 MILES FROM WEST CROYDON TRAIN STATION
- ❖ 0.3 MILES FROM THE LOCAL TRAM STOP
- ❖ EXCELLENT CHOICE OF LOCAL SCHOOLS
- ❖ FPC FFR D



**** Available Immediately ** Unfurnished **** A three-bedroom terrace house situated within this quiet residential road, conveniently located 0.3 miles from the local Tram stop and just over one mile from both West Croydon & Thornton Heath train stations.

This bright & airy home boasts a sizeable rear garden, there is ample storage and there is hard flooring throughout. The property is also fully double glazed and there is gas central heating.

The accommodation comprises two large double bedrooms each with fitted wardrobes, a third bedroom/study, a three-piece family bathroom suite, a spacious entrance hall, two separate reception rooms and a fitted kitchen with appliances included.

Furthermore, this property is nearby the green expanse of Mitcham Common and sits within the catchment of a number of well-regarded primary and secondary schools.

Score	Energy rating	Current	Potential
92+	A		
81-91	B		88 B
69-80	C		
55-68	D	68 D	
39-54	E		
21-38	F		
1-20	G		