



Lancaster Court, Yaxley Peterborough
£255,000 Freehold

**Sharman
Quinney**

Key Features



- Extended Semi Detached Home
- Four Bedrooms & Shower Room
- Lounge & Kitchen/Diner
- 16'7" Utility Room
- Downstairs Cloakroom

Located in the Village of Yaxley this Good Size Extended Semi-Detached Family Home in brief the accommodation comprises of, Entrance Hall with archway to the inner hallway and doors to the Downstairs Cloakroom with a low wc and a wash hand basin, Utility Room which has been converted from the original garage, it has worktop space with a stainless steel sink unit, storage cupboards under, plumbing for washing machine, space for a tumble dryer, Inner Hall with stairs to the first floor landing, Lounge with a bay window to the front, Kitchen/Diner which has a range of fitted base and eye level units, cupboards, drawers, worktop space, single drainer sink unit, space for a cooker, plumbing for a dishwasher, double doors to the rear garden. Upstairs First Floor Landing has doors to the Four Bedrooms, Three Piece Shower Room, Bedroom 1 benefits



from having a panelled bath and a heated towel rail. Outside from the rear there is access to the driveway which provided Off Road Parking, there is gated access to the Enclosed Rear Garden and side access to the front.

Accommodation Includes

Entrance Hall - 1.91m max x 1.04m (6'3"max x 3'5"max).

Downstairs Cloakroom - 1.55m x 1.14m (5'1" x 3'9").

Utility Room - 5.05m x 2.29m (16'7" x 7'6" (converted from garage).

Inner Hallway - 3.56m max x 1.73m max inc stairs (11'8"max x 5'8"max (including stairs).

Lounge - 4.11m max x 3.53m max excluding bay window (13'6"max x 11'7"max (excluding bay window).

Kitchen/Diner - 5.94m x 2.95m (19'6" x 9'8").

First Floor Landing - 2.64m max x 1.83m max inc stairs (8'8"max x 6'max (including stairs).

Bedroom 1 - 6.93m max x 2.26m max (22'9"max x 7'5"max).

Bedroom 2 - 3.53m max x 3.51m max (11'7"max





Ground Floor

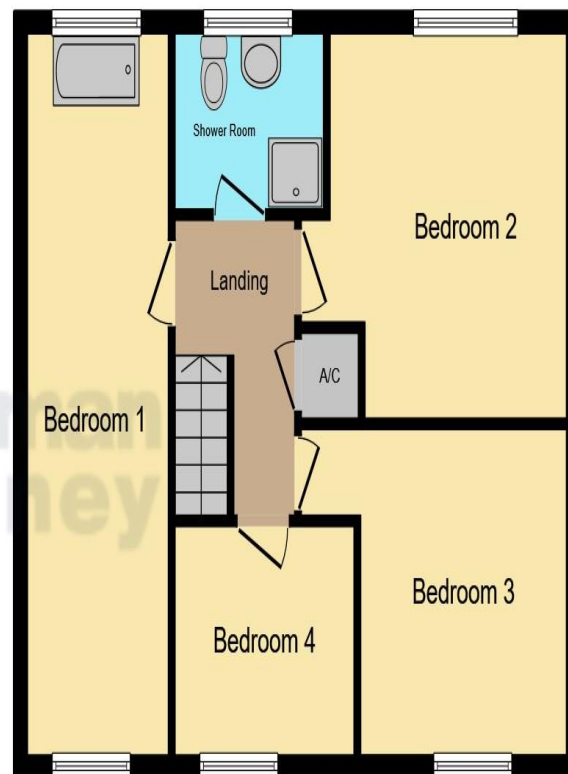

First Floor

This floor plan is for illustrative purposes only. It is not drawn to scale. Any measurements, floor areas (including any total floor area), openings and orientation are approximate. No details are guaranteed, they cannot be relied upon for any purpose and they do not form part of any agreement. No liability is taken for any error, omission or misstatement. A party must rely upon its own inspection(s). Powered by www.focalagent.com

x 11'6"max).

Bedroom 3 - 3.07m x 3.05m exc door recess (10'1" x 10' (excluding door recess)).

Bedroom 4 - 2.67m x 2.06m (8'9" x 6'9").

Shower Room - 2.16m max x 1.65m max (7'1"max x 5'5"max).

To view this property call Sharman Quinney on:
01733 245400

Selling your property?

Contact us to arrange a **FREE** home valuation.

 01733 245400

 Unit 19 Maltings Square, Broadway Shopping Centre, Yaxley, PE7 3EW

 yaxley@sharmanquinney.co.uk

 www.sharmanquinney.co.uk



 SCAN ME



Sharman Quinney Holdings Limited is registered in England and Wales under company number 4174227, Registered Office is Cumbria House, 16-20 Hockliffe Street, Leighton Buzzard, Bedfordshire, LU7 1GN. VAT Registration Number is 500 2481 05.

1: These particulars do not constitute part or all of an offer or contract. 2: The measurements indicated are supplied for guidance only and as such must be considered incorrect. 3: Potential buyers are advised to recheck the measurements before committing to any expense. 4: Sharman Quinney has not tested any apparatus, equipment, fixtures, fittings or services and it is the buyers interests to check the working condition of any appliances. 5: Sharman Quinney has not sought to verify the legal title of the property and buyers must obtain verification from their legal representative. 6: Intending purchasers will be asked to produce identification documentation at a later stage and we would ask your co-operation in order that there will be no delay in agreeing the sale. Ref: YAX203746 - 0005

