



## Leopold Street, Wigston

In Excess of £195,000

Located on Leopold Street within South Wigston is this period BAY FRONTED terrace. The property provides accommodation over two floors to include two reception rooms, a kitchen, TWO DOUBLE BEDROOMS.

Council Tax band: A

Tenure: Freehold

EPC Energy Efficiency Rating: D



0116 288 4888





### **Reception Room One**

15' 2" x 11' 3" (4.63m x 3.43m)

Maximum measurement. With double glazed bay window to the front elevation, chimney breast with inset living flame gas fire, ceiling coving, TV point, radiator.

### **Reception Room Two**

11' 11" x 11' 3" (3.62m x 3.43m)

With double glazed window to the rear elevation, chimney breast with cast iron coal fire, door leading to stairs to first floor, radiator, door to the kitchen.

### **Kitchen**

13' 1" x 5' 11" (4.00m x 1.80m)

This space features double-glazed windows and a side door, bringing in plenty of natural light. It's fitted with wall and base units topped with a work surface, along with spotlights overhead. There's a sink and drainer with a mixer tap, plus an inset four-ring gas hob and oven with an extractor hood and splashback. You'll also find plumbing for a washing machine, as well as room for a fridge and a freezer. Part-tiled walls and a radiator complete the room.



### **First Floor Landing**

With loft access, radiator.

### **Bedroom One**

12' 11" x 12' 0" (3.94m x 3.66m)

With double glazed window to the front elevation, built-in cupboard, chimney breast, radiator.

### **Bedroom Two**

12' 0" x 9' 11" (3.67m x 3.02m)

With double glazed window to the rear elevation, chimney breast, built-in over stairs cupboard, radiator.

### **Bathroom**

13' 1" x 5' 11" (4.00m x 1.81m)

With double glazed window to the rear elevation, bath with shower over, low-level WC, wash hash hand basin, part tiled walls, built-in cupboards, airing cupboard, splash backs, radiator.

### **Front Garden**

Front forecourt.

### **Rear Garden**

With paved patio area, AstroTurf lawn, fencing to perimeter.

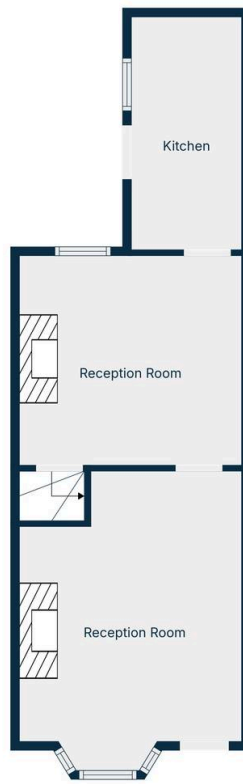

Floor Plan Created By Cubicasa App. Measurements Deemed Highly Reliable But Not Guaranteed.



Floor Plan Created By Cubicasa App. Measurements Deemed Highly Reliable But Not Guaranteed.

**We'll keep you moving...**



We must inform all prospective purchasers that the measurements are taken by an electronic take and are provided as a guide only and they should not be used as accurate measurements. We have not tested any mains services, gas or electric appliances, or fixtures and fittings mentioned in these details, therefore, prospective purchasers should satisfy themselves before committing to purchase. Intending purchasers must satisfy themselves by inspection or otherwise to the correctness of the statements contained in these particulars. Knightsbridge Estate Agents (nor any person in their employment) has any authority to make any representation or warranty in relation to the property. The floor plans are not to scale, and are intended for use as a guide to the layout of the property only. They should not be used for any other purpose. We are required by law to conduct anti-money laundering checks on all those selling or buying a property. Whilst we retain responsibility for ensuring checks and any ongoing monitoring are carried out correctly, the initial checks are carried out on our behalf by Lifetime Legal who will contact you once you have agreed to instruct us in your sale or had an offer accepted on a property you wish to buy. The cost of these checks is £60 (incl. VAT), which covers the cost of obtaining relevant data and any manual checks and monitoring which might be required. This fee will need to be paid by you in advance of us publishing your property (in the case of a vendor) or issuing a memorandum of sale (in the case of a buyer), directly to Lifetime Legal, and is non-refundable. We will receive some of the fee taken by Lifetime Legal to compensate for its role in the provision of these checks.