



**Guide Price**  
**£600,000**

**Freehold**

3x  1x  2x 

**Harvel Road, Meopham,  
Kent, DA13**

**OVER 60?**

Secure this property  
for up to **59% less!**

*Wards*  
Helping you move forwards

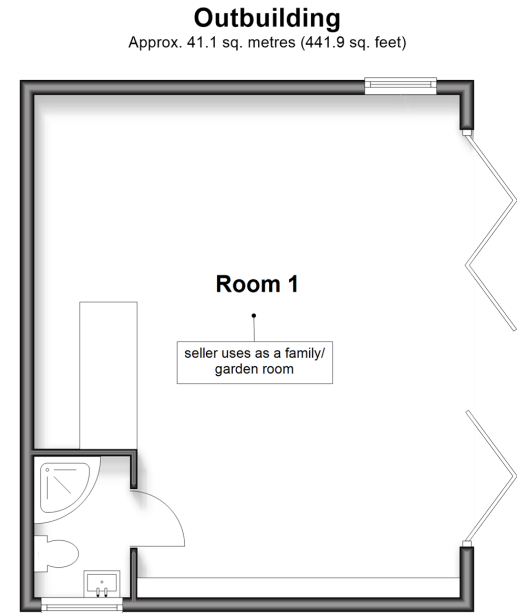
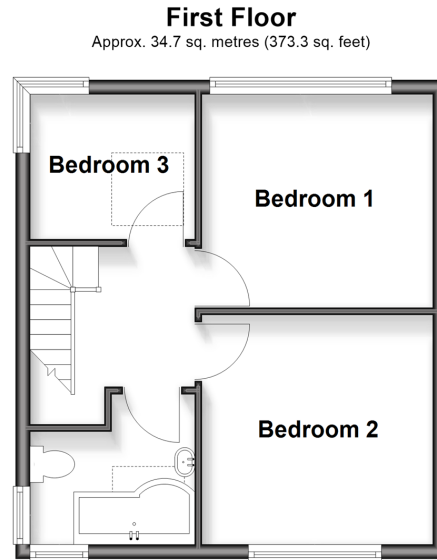
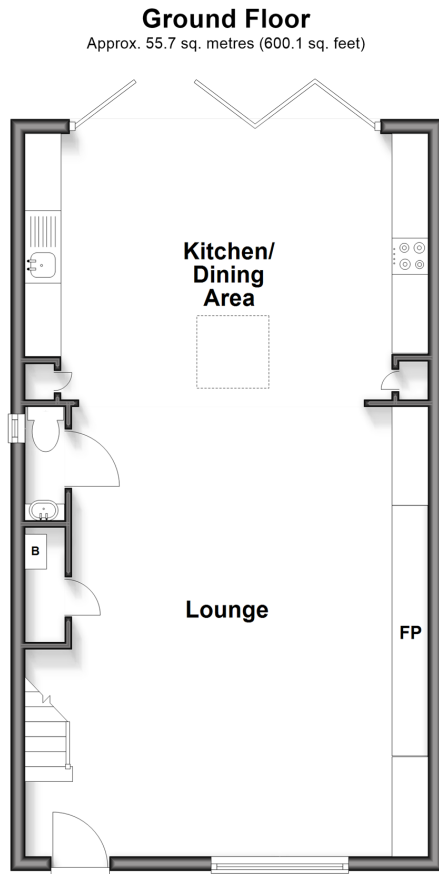

## Accommodation

### GROUND FLOOR

Lounge: 21'4 x 15'9 (6.51m x 4.80m)  
 Kitchen/Dining Area: 17'9 x 12'0 (5.41m x 3.66m)  
 Cloakroom: 5'3 x 2'1 (1.60m x 0.64m)

### FIRST FLOOR

Landing  
 Bedroom 1: 11'8 x 10'0 (3.56m x 3.05m)  
 Bedroom 2: 11'2 x 10'5 (3.41m x 3.18m)  
 Bedroom 3: 7'4 x 6'3 (2.24m x 1.91m)  
 Bathroom: 7'5 x 6'8 (2.26m x 2.03m)

### OUTBUILDING

Room 1 (uses as a Family Room): 22'7 x 19'4 (6.89m x 5.90m)  
 Shower Room: 6'1 x 4'5 (1.86m x 1.35m)

### OUTSIDE

Driveway  
 Front Garden  
 Rear Garden



## Main features

- No onward chain, ensuring effortless acquisition
- Fully refurbished to exceptional, high specification giving a contemporary finish
- Premium outbuilding ideal as an office or business, with shower room and air conditioning
- Impressive 0.52 acres plot, perfect for entertaining friends and family
- Private electric gates and substantial driveway providing secure arrival and generous parking



### Nearest Schools

Primary and Secondary Schools: Vigo Village School 0.1 miles, Culverstone Green Primary 0.8 miles, Trottiscliffe C of E Primary 0.9 miles, Meopham School 2.5 miles, Helen Allison School 3.0 miles, Grange Park School 3.0 miles, Wrotham School 3.2 miles



### Transport Information

Train Stations: Sole Street 3.6 miles, Meopham 3.7 miles, West Malling 3.7 miles



### Address

Harvel Road, Meopham, Kent, DA13



### Directions

For directions to this property please contact us.



*Wards*  
Helping you move forwards

Call Meopham Branch 01474 813100 ■ [wardsofkent.co.uk](http://wardsofkent.co.uk)



■ If buying to rent, please check if Local Authority licensing schemes apply before proceeding

■ Through a Homewise Home For Life Plan people aged 60+ can secure this property for up to 59% less, by purchasing a Lifetime Lease

EPC RATING	CURRENT:	POTENTIAL:
	<b>C(76)</b>	<b>A(107)</b>

13326286/20260521/KD/KD