



Hutchings Street, E14

£275,000

Located within the sought-after Seacon Wharf development, this well-presented one bedroom apartment is offered to the market chain free. The property features a private balcony, concierge service, residents' leisure facilities and a lease of over 900 years.

Ideally located for Canary Wharf, offering a wide selection of shops, supermarkets, restaurants and bars. Nearby DLR, Jubilee line and Elizabeth line services provide excellent connections across London.

Features

- 490 Square Feet
- Private Balcony
- 900 Plus Year Lease
- Concierge Service
- Residents Leisure Facilities
- Gated Development

Hutchings Street, London, E14

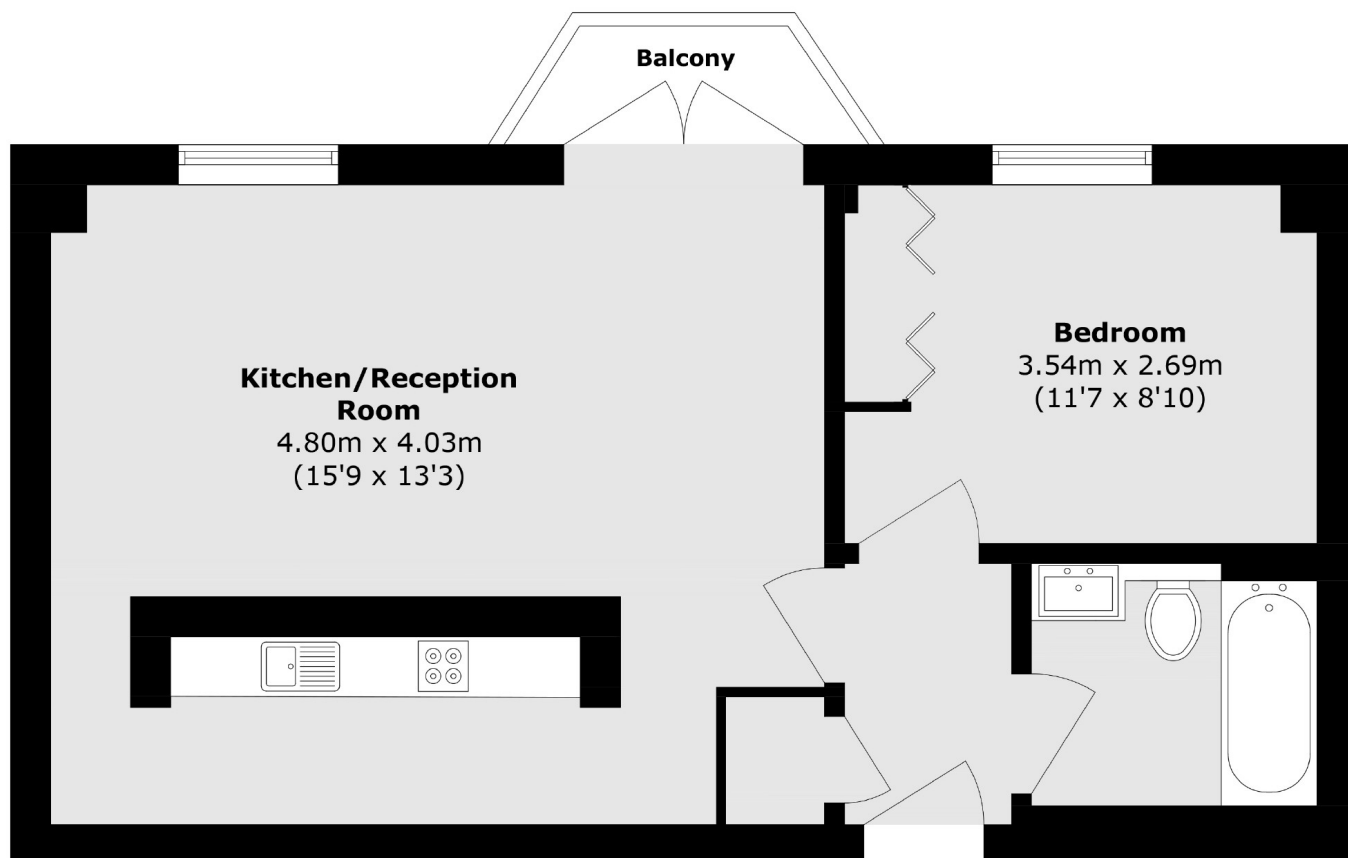

Total area (approx.): 45.5 sq. m (489.7 sq. ft)

Balcony area (approx.): 1.9 sq. m (20.4 sq. ft)