



Croft Gardens, W7

£575,000

Newly converted garden maisonette which has been meticulously fitted by the current owner with much attention to detail.

Ideal for a purchaser looking for a property they can just move in to and unpack.

Private entrance to the reception hall which has a guest WC, main bedroom with a stylish ensuite shower room, second bedroom and a beautifully fitted kitchen/living room with bifold doors to the private rear garden.

Excellent location close to West Ealing and Hanwell stations for the Elizabeth line and the Piccadilly line at Northfields station.

Features

- New Conversion
- Two Bedrooms
- Stylish Finish
- Share of Freehold
- Landscaped Garden
- Residents Parking

Croft Gardens, London, W7

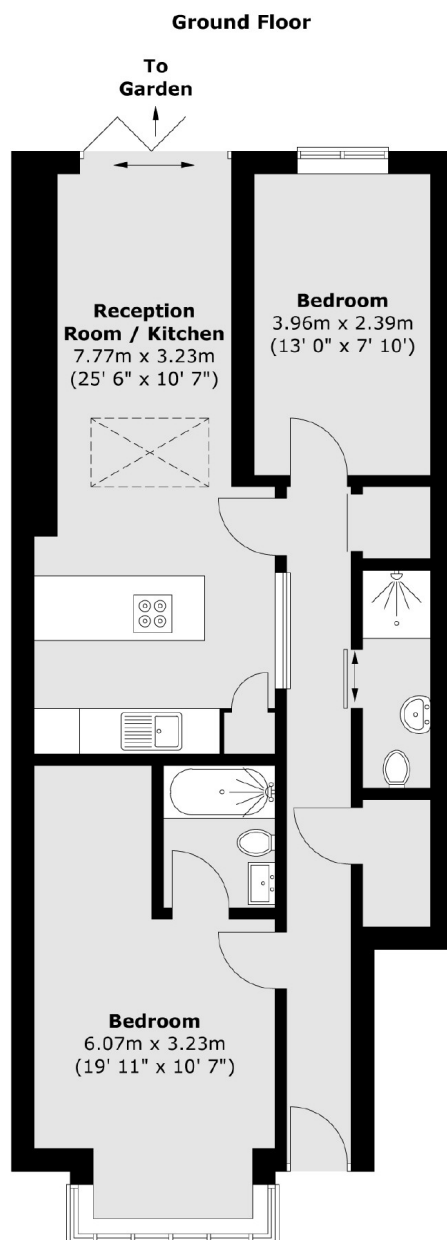

Total area (approx.) : 67.3 sq. m (724 sq. ft)

Dexters

Northfields
140 Northfield Avenue
London
W13 9SB
Sales
020 8545 8588

Energy Rating: C. We aim to make our particulars both accurate and reliable. However they are not guaranteed; nor do they form part of an offer or contract. If you require clarification on any points then please contact us, especially if you're traveling some distance to view. Please note that appliances and heating systems have not been tested and therefore no warranties can be given as to their good working order.

 **RICS** | Regulated
Estate Agent
and Letting Agent

dexters.co.uk