

A row of traditional stone cottages with thatched awnings over the doors. The buildings are made of light-colored stone and have black-framed windows. The scene is set on a street with a paved road and lush greenery, including large rose bushes in the foreground. The sky is blue with some light clouds.

Symonds
& Sampson

1 Shutes Farm Cottages

Shutes Lane, Symondsburry, Bridport, Dorset

1 Shutes Farm Cottages

Shutes Lane
Symondsburry
Bridport
Dorset DT6 6HF

GUIDE RANGE £325,000 - £350,000. Handsome two bedroom Grade II listed cottage in the heart of Symondsburry village, a short stroll to Colmer's Hill and a public house.



- A chocolate box cottage in sought after village location
 - Private courtyard garden
 - Open-plan dining/sitting room
 - On street parking

Guide Range £325,000 - £350,000

Freehold

Bridport Sales
01308 422092
bridport@symondsandsampson.co.uk



THE PROPERTY

1 Shutes Farm Cottages is an attractive end of terrace cottage, beautifully positioned away from passing traffic on the north side of Symondsburry Village. It is ideally placed, just a short walk out onto open countryside and Colmers Hill, a short step to the Ilchester Arms and a short drive to Bridport town centre and the beach. Think "chocolate box cottage" and you have it in a nutshell. The property has warm stone elevations under a tile roof and an interior that has been refurbished and updated over the last few years, keeping the original character of the cottage, yet installing all those essentials needed for 21st century living.

ACCOMMODATION

The living room stretches from the front to the rear of the property with a seating area to one end centred on a woodburning stove, and a dining area to the other looking out to the garden. The fireplace has a contemporary woodburning stove while the whole room is laid to attractive painted floorboards. To one side there is a well organised kitchen with hardwood work surfaces over and integral appliances that include an electric oven, ceramic hob, a fridge and a dishwasher. In addition under the stairs there is space and plumbing for washing machine, a tumble dryer and a small freezer. Upstairs there are two good

bedrooms, the principal of which stretches along the front of the cottage and has a built-in wardrobe, with both bedrooms sharing a stylish fitted bathroom with an electric shower over the bath. The property is in good decorative order throughout and has electric heating.

OUTSIDE

To the front of the property there is on street parking. To the rear is a south and west facing courtyard garden laid to paving, with a raised enclosed herbaceous border to one corner and a door to the other corner out onto a courtyard behind. The garden is a suntrap, ideal for taking in the sun at the end of the day, making it a good outside entertaining area during the summer months.

SITUATION

This property lies within the village of Symondsburry. Here you will find wonderful countryside walks over Colmers Hill and the well established Symondsburry Estate. Yearly events are held at the estate with a cafe, visitors centre and much more. A short walk into the local town of Bridport, this is a bustling and vibrant market town which has a history of rope making and is now a gateway to the Jurassic World Heritage coastline at nearby West Bay. It has a variety of independent shops, supermarkets, public houses and restaurants catering for a range of tastes and

excellent arts and music events. There is a good choice of primary and secondary schooling in the area. Communication links are good with road links along the A35 and mainline stations at Maiden Newton, Dorchester, Axminster and Crewkerne.

DIRECTIONS

What3Words///hindered.swimsuits.gentle

SERVICES

Mains electricity, drainage and water

Electric heating

Broadband - Ultrafast broadband is available.

There is mobile coverage in the area, please refer to Ofcom's website for more details.

LOCAL AUTHORITY

Dorset Council

Council Tax band C



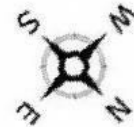
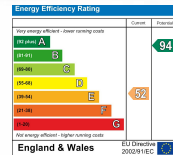
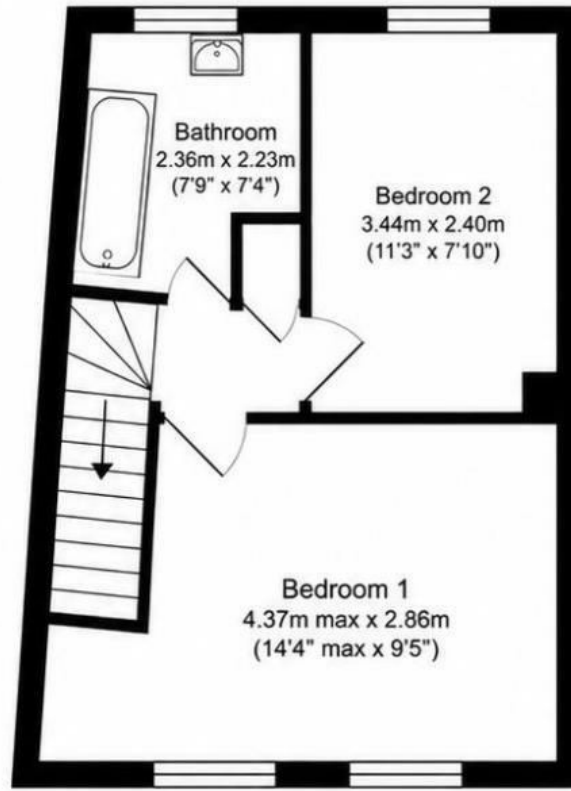
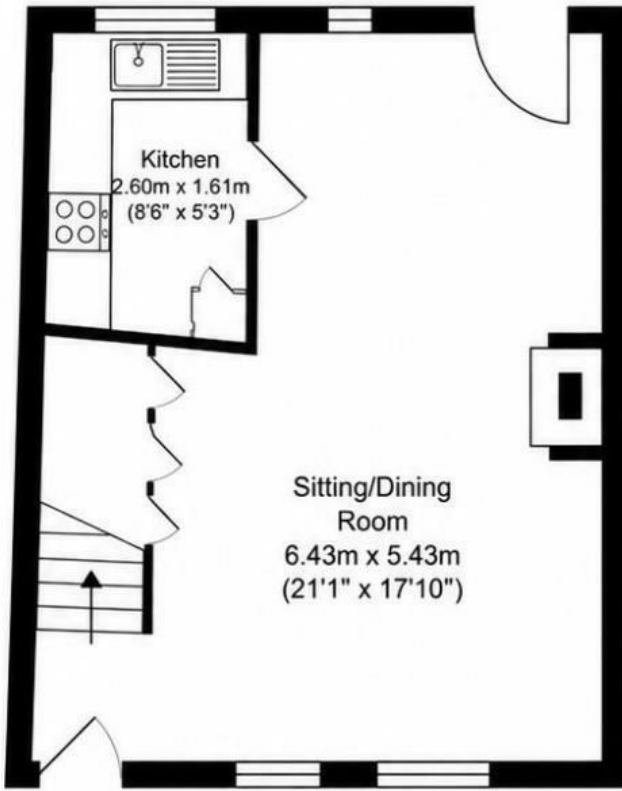

1 Shutes Farm Cottages
Symondsburry
Bridport
DT6 6HF

Total Area: 692 ft² 64.3 m²

Not to scale. Measurements are approximate and for guidance only.



BRI/SA/REV29062026



01308 422092

bridport@symondsandsampson.co.uk
Symonds & Sampson LLP
23, South Street,
Bridport, Dorset DT6 3NU



Important Notice: Symonds & Sampson LLP and their Clients give notice that: 1. They have no authority to make or give any representations or warranties in relation to the property. These particulars do not form part of any offer or contract and must not be relied upon as statements or representations of fact. 2. Any areas, measurements or distances are approximate. The text, photographs and plans are for guidance only and are not necessarily comprehensive. It should not be assumed that the properties have all necessary planning, building regulation or other consents and Symonds and Sampson LLP have not tested any services, equipment of facilities. 3. We have not made any investigation into the existence or otherwise of any issues concerning pollution of the land, air or water contamination and the purchaser is responsible for making his/her own enquiries in this regard. 4. The property is sold subject to and with the benefit of all existing wayleaves, easements and rights of way whether public or private, specifically mentioned or not. The vendors shall not be required to define any such rights, privileges or advantages.

SALES | LETTINGS | AUCTIONS | FARMS & LAND | COMMERCIAL | NEW HOMES | PLANNING & DEVELOPMENT