

for sale

£150,000



Alicia Close Swindon SN25 1XE

NO ONWARD CHAIN! Situated in the highly sought-after HAYDON END NORTH SWINDON, this spacious TWO BEDROOM GROUND FLOOR APARTMENT offers well-balanced accommodation throughout. **ALLOCATED PARKING**



Alicia Close Swindon SN25 1XE

Accommodation Details

Entrance Hall

Door to communal entrance hall. Intercom. Radiator. Storage cupboard. Airing cupboard.

Open Plan Living Accommodation

18' 2" x 14' 10" (5.54m x 4.52m)

Lounge Area

Two double glazed windows to the front aspect. Television point. Telephone point. Radiator.

Kitchen

Fully fitted kitchen with a range of base and wall units with complementary work surfaces over. Inset sink and drainer. Space and plumbing for washing machine and dishwasher. Space for fridge/freezer. Integrated electric oven and gas hob with extractor hood over. Integrated boiler.

Bedroom One

11' 8" x 9' 6" (3.56m x 2.90m)

Two double glazed windows to front. Built in wardrobe. Radiator.

Bedroom Two

9' 6" x 9' 4" (2.90m x 2.84m)

Two double glazed windows to the front aspect. Radiator.

Bathroom

Three piece suite comprising low level WC, wash hand basin and panelled bath with shower over. Part tiled to water sensitive areas.

External Features

Parking

Allocated parking





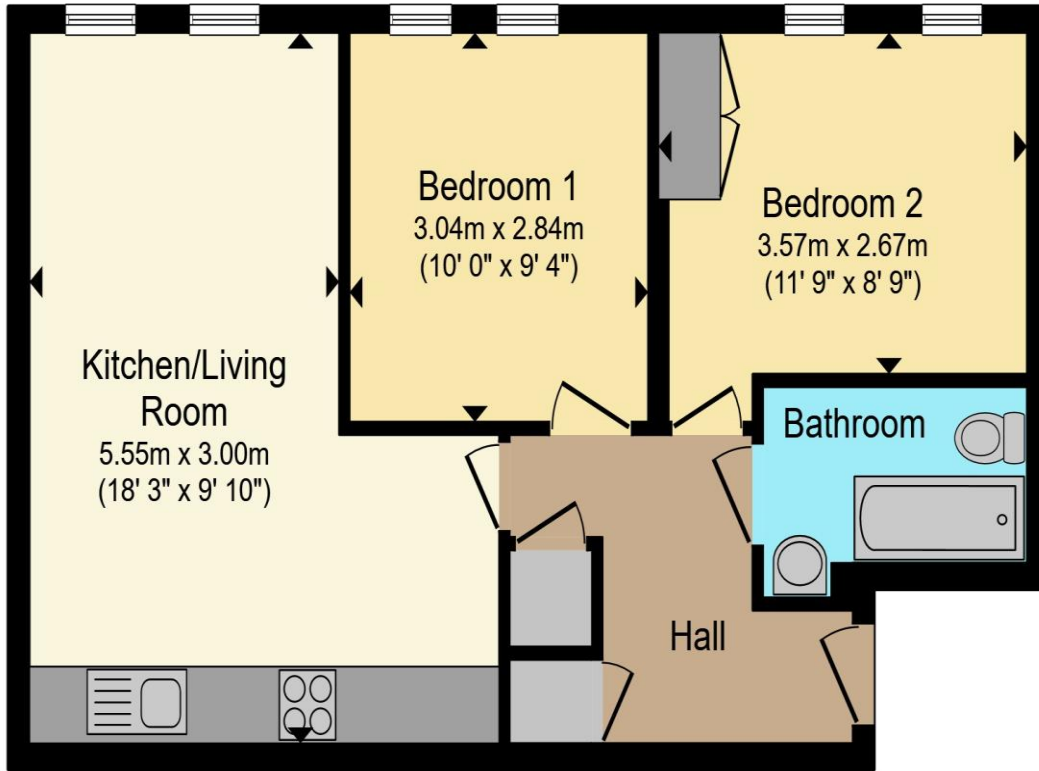

Total floor area 51.2 m² (552 sq.ft.) approx

This floor plan is for illustrative purposes only. It is not drawn to scale. Any measurements, floor areas (including any total floor area), openings and orientation are approximate. No details are guaranteed, they cannot be relied upon for any purpose and they do not form part of any agreement. No liability is taken for any error, omission or misstatement. A party must rely upon its own inspection(s). Powered by www.propertybox.io



To view this property please contact Connells on

T 01793 708050
E swindonnorth@connells.co.uk

Unit B11 North Swindon District Centre Thamesdown Drive
 SWINDON SN25 4AN

Property Ref: SDN315028 - 0002

Tenure:Leasehold EPC Rating: C

Council Tax Band: C Service Charge: 2037.00

Ground Rent: 100.00

view this property online
connells.co.uk/Property/SDN315028

This is a Leasehold property with details as follows; Term of Lease 250 years from 01 Jan 2007. Should you require further information please contact the branch. Please Note additional fees could be incurred for items such as Leasehold backs.

1. MONEY LAUNDERING REGULATIONS Intending purchasers will be asked to produce identification documentation at a later stage and we would ask for your co-operation in order that there will be no delay in agreeing the sale. 2. These particulars do not constitute part or all of an offer or contract. 3. The measurements indicated are supplied for guidance only and as such must be considered incorrect. Potential buyers are advised to recheck measurements before committing to any expense. 4. We have not tested any apparatus, equipment, fixtures, fittings or services and it is in the buyers interest to check the working condition of any appliances.

Connells Residential is registered in England and Wales under company number 1489613, Registered Office is Cumbria House, 16-20 Hockliffe Street, Leighton Buzzard, Bedfordshire, LU7 1GN. VAT Registration Number is 500 2481 05.

