



Oldfield Lane,

Offers In Excess Of £450,000

FOR SALE



- Tenants currently in situ
- Sold with no chain and vacant possession
- Three Bedrooms
- Downstairs W/C
- Close to local amenities
- Prime Location

THE PROPERTY

A well-presented three bedroom terraced home in the heart of Oldfield Park, Bath. This property offers generous living space, a private garden, and is sold with no onward chain. An excellent opportunity for families, first-time buyers or investors alike.

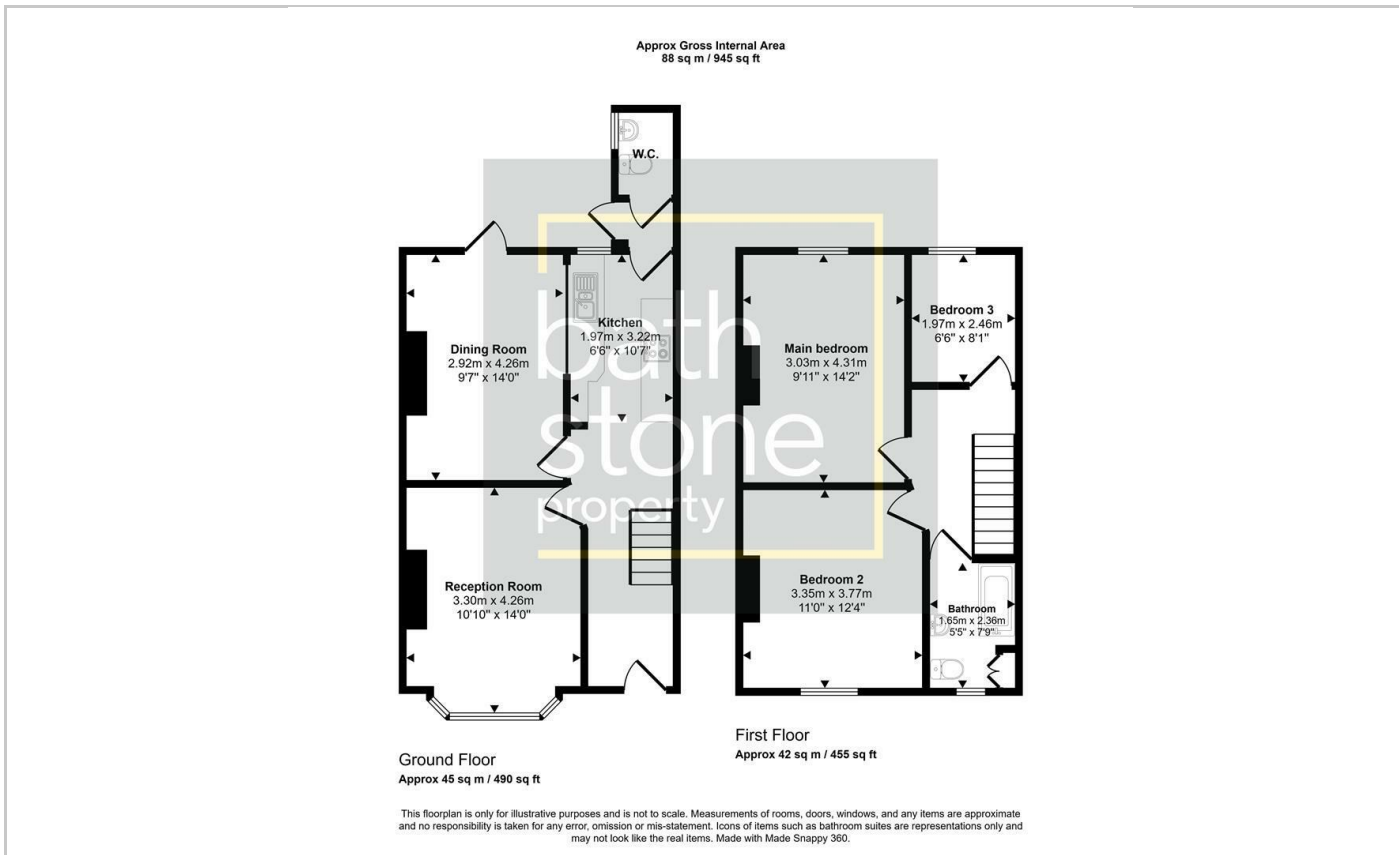

Energy Efficiency Rating		Current	Potential
Very energy efficient - lower running costs			
(92 plus) A			84
(81-91) B			
(69-80) C			
(55-68) D		66	
(39-54) E			
(21-38) F			
(1-20) G			
Not energy efficient - higher running costs			
England & Wales		EU Directive 2002/91/EC	