



Barge House Road, E16

£2,200 Per calendar month

A spacious three bedroom house set on a quiet residential street. Arranged over two floors, this house is perfect for entertaining with its spacious reception room, private garden and off-street parking.

Barge House Road enjoys close proximity to the River Thames, London City Airport and the shops and restaurants of Gallions Reach. King George V DLR station is your closest railway link and is located within 0.4 miles of the property.

Features

Three Bedrooms
Two Bathrooms
Semi- Detached House
Spacious Reception Room
Private G

Off- Street Parking



Barge House Road, E16



Barge House Road, London, E16

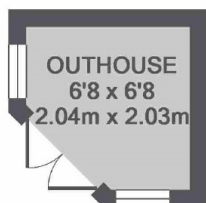

TOTAL APPROX. FLOOR AREA 39 SQ.FT. (3.6 SQ.M.)



GROUND FLOOR

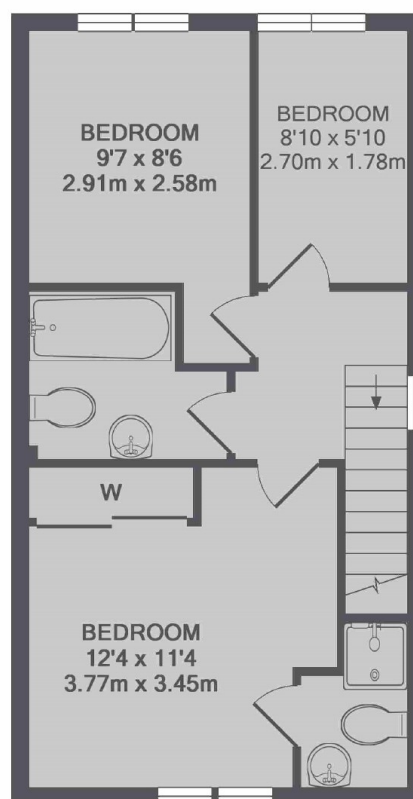

1ST FLOOR

TOTAL APPROX. FLOOR AREA 835 SQ.FT. (77.6 SQ.M.)