



Monarch Court

Stanmore

£1,650 Per month

A one bedroom, second floor flat available 24th August in the popular Stanmore Place.

The flat has an open plan kitchen living room, double bedroom with built-in wardrobes, family bathroom and a utility cupboard.

Stanmore Place is in an excellent location for Canon's Park tube station. On site and included for tenants is a gym, a children's playground, a 24 hour concierge and a secure parking space.

Available 24th August 2026
Harrow Council Tax Band C
Deposit of £1,846.15 at the asking price

Viewing

Please contact our Davidson Frost-Wellings Office on 020 8954 8806 if you wish to arrange a viewing appointment for this property or require further information.

- One Double Bedroom
- Open Plan Kitchen
- Second Floor
- Gym and Concierge
- Secure Parking
- Available 24th August



Floor Plan

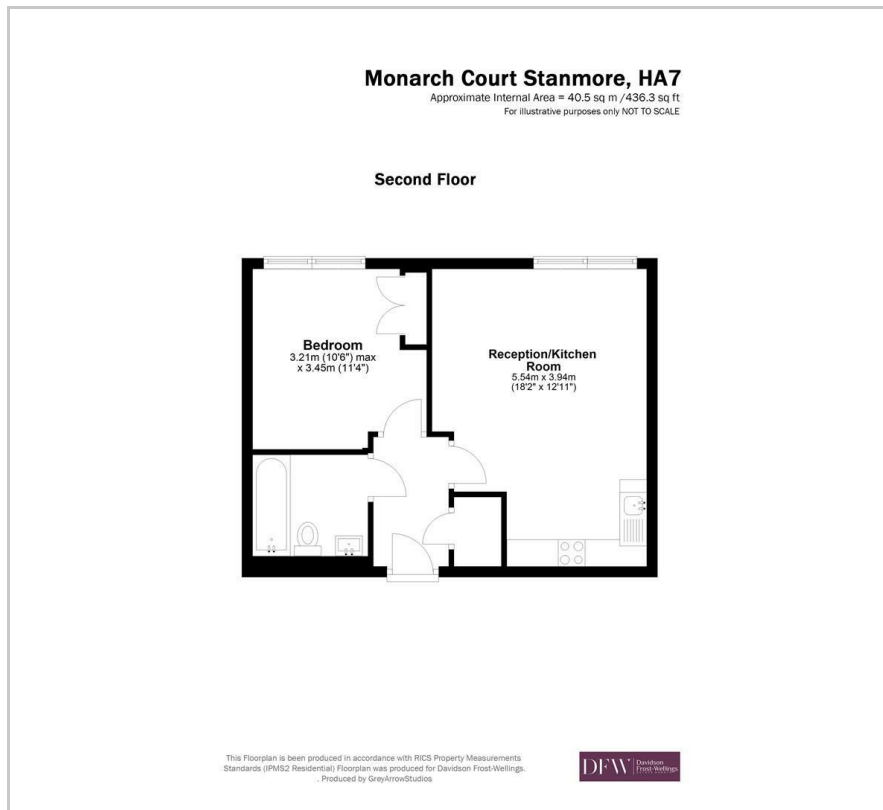

Area Map



Energy Efficiency Rating

	Current	Potential
<i>Very energy efficient - lower running costs</i>		
(92 plus) A		
(81-91) B	81	81
(69-80) C		
(55-68) D		
(39-54) E		
(21-38) F		
(1-20) G		
<i>Not energy efficient - higher running costs</i>		
England & Wales	EU Directive 2002/91/EC	



These particulars, whilst believed to be accurate are set out as a general outline only for guidance and do not constitute any part of an offer or contract. Intending purchasers should not rely on them as statements of representation of fact, but must satisfy themselves by inspection or otherwise as to their accuracy. No person in this firm's employment has the authority to make or give any representation or warranty in respect of the property.