



Fusion Court, Ware SG12 9EJ

Guide price £300,000



Taylor Phelps

Estate Agency

Taylor Phelps

Taylor Phelps are pleased to offer this superb riverside apartment positioned within this modern sought after development close to Ware high street and train station! This fantastic two bedroom apartment boasts a larger style balcony with elevated river view, two modern bathrooms, a useful loft space and gated parking! Available Chain Free!







Taylor Phelps



Taylor Phelps



Taylor Phelps



Taylor Phelps



Floor Plan

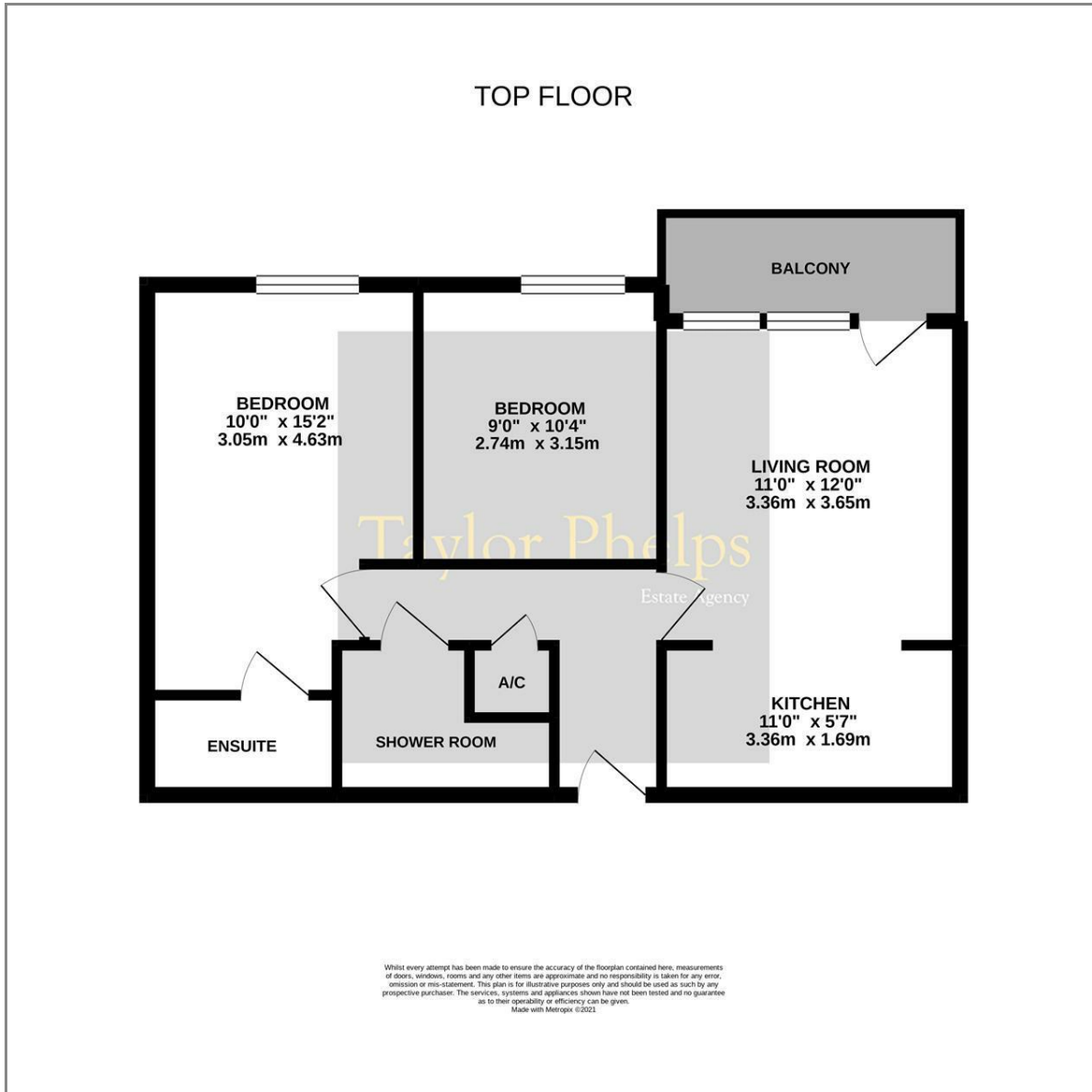

Area Map



Energy Efficiency Graph

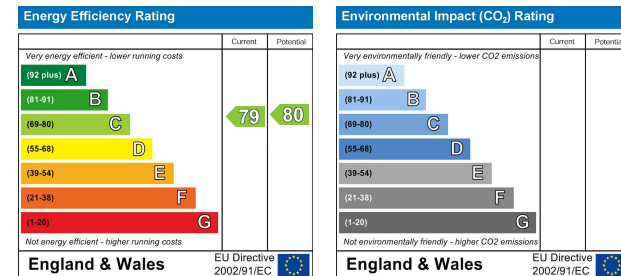

These particulars, whilst believed to be accurate are set out as a general outline only for guidance and do not constitute any part of an offer or contract. Intending purchasers should not rely on them as statements of representation of fact, but must satisfy themselves by inspection or otherwise as to their accuracy. No person in this firm's employment has the authority to make or give any representation or warranty in respect of the property.

01920 459000

hello@taylorphelps.co.uk

5 Frenchs Yard, Amwell End, Ware, Hertfordshire, SG12 9HP

www.taylorphelps.co.uk

