



See More Online

# KFB: Key Facts For Buyers

A Guide to This Property & the Local Area

Friday 09<sup>th</sup> January 2026

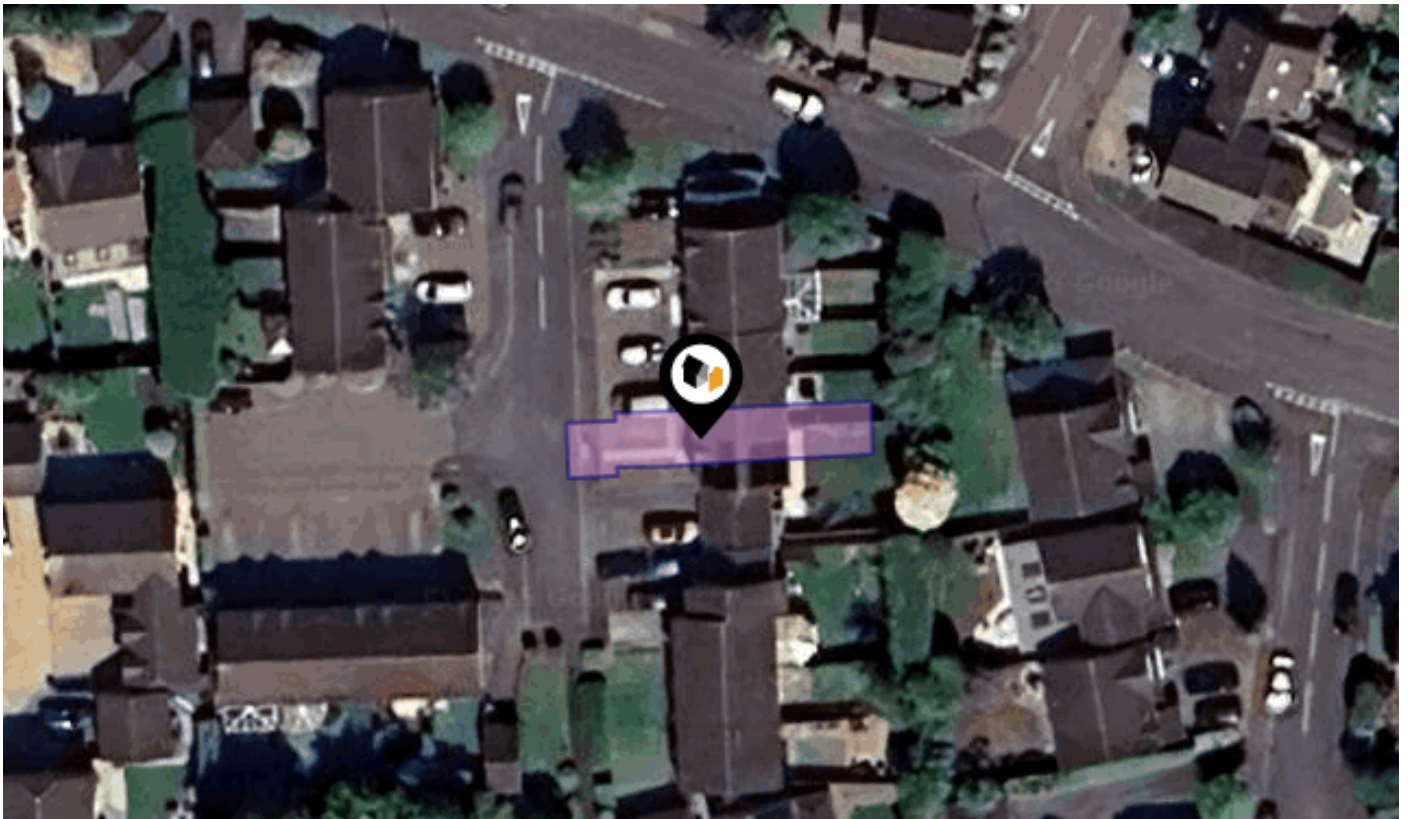

**4, SCANIA WALK, WINKFIELD ROW, BRACKNELL, RG42 7TE**

**Avocado Property**

07515141327

mattandsanjay@avocadopropertyagents.co.uk

www.avocadopropertyagents.co.uk



Powered by  
**aprift**  
Know any property instantly

# Property Overview

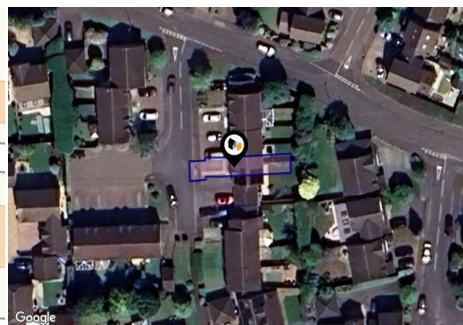

## Property

Type:	Terraced
Bedrooms:	2
Floor Area:	602 ft <sup>2</sup> / 56 m <sup>2</sup>
Plot Area:	0.03 acres
Year Built :	1983-1990
Council Tax :	Band C
Annual Estimate:	£1,916
Title Number:	BK286178
UPRN:	100080207200

Last Sold Date:	24/09/2021
Last Sold Price:	£335,000
Last Sold £/ft <sup>2</sup> :	£576
Tenure:	Freehold

## Local Area

Local Authority:	Bracknell forest
Conservation Area:	No
Flood Risk:	
• Rivers & Seas	Very low
• Surface Water	Very low

### Estimated Broadband Speeds (Standard - Superfast - Ultrafast)

<b>16</b> mb/s	<b>80</b> mb/s	<b>1800</b> mb/s

### Mobile Coverage: (based on calls indoors)



### Satellite/Fibre TV Availability:



## 4, SCANIA WALK, WINKFIELD ROW, BRACKNELL, RG42 7TE

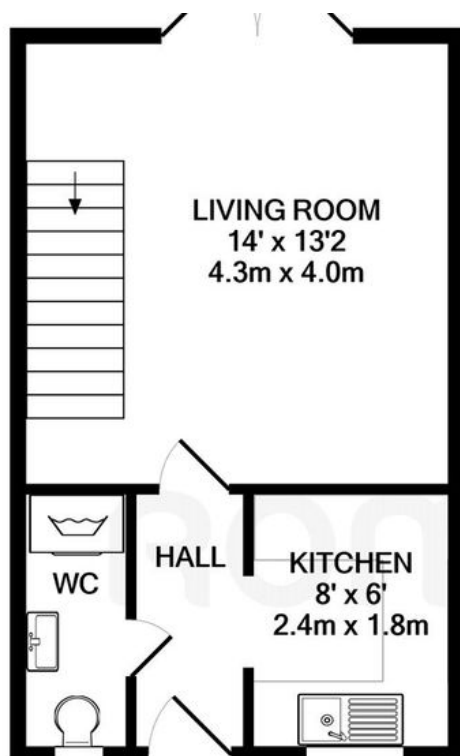

GROUND FLOOR

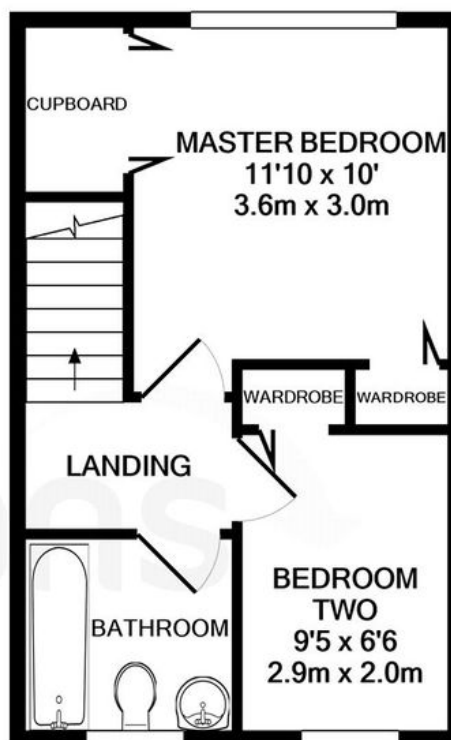

1ST FLOOR

Whilst every attempt has been made to ensure the accuracy of the floor plan contained here, measurements of doors, windows, rooms and any other items are approximate and no responsibility is taken for any error, omission, or mis-statement. This plan is for illustrative purposes only and should be used as such by any prospective purchaser. The services, systems and appliances shown have not been tested and no guarantee

# Property EPC - Certificate

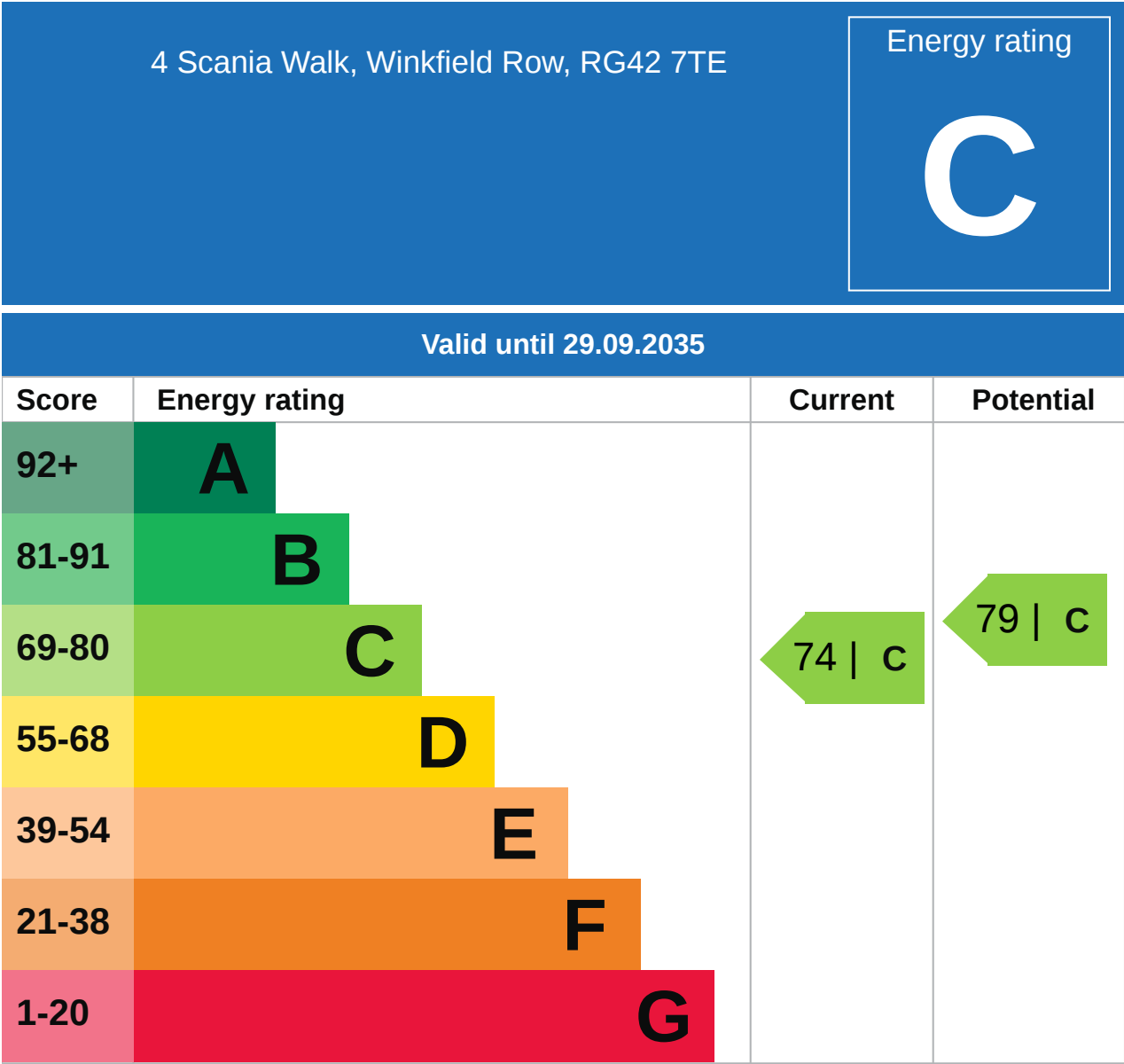

# Property

## EPC - Additional Data



### Additional EPC Data

---

<b>Property Type:</b>	House
<b>Build Form:</b>	Mid-Terrace
<b>Transaction Type:</b>	Marketed sale
<b>Energy Tariff:</b>	Unknown
<b>Main Fuel:</b>	Mains gas (not community)
<b>Main Gas:</b>	Yes
<b>Previous Extension:</b>	0
<b>Open Fireplace:</b>	0
<b>Walls:</b>	Cavity wall, as built, insulated (assumed)
<b>Walls Energy:</b>	Good
<b>Roof:</b>	Pitched, 100 mm loft insulation
<b>Roof Energy:</b>	Average
<b>Main Heating:</b>	Boiler and radiators, mains gas
<b>Main Heating Controls:</b>	Programmer and room thermostat
<b>Hot Water System:</b>	From main system
<b>Hot Water Energy Efficiency:</b>	Good
<b>Lighting:</b>	Below average lighting efficiency
<b>Floors:</b>	Solid, no insulation (assumed)
<b>Total Floor Area:</b>	56 m <sup>2</sup>

# Market

## House Price Statistics



10 Year History of Average House Prices by Property Type in RG42

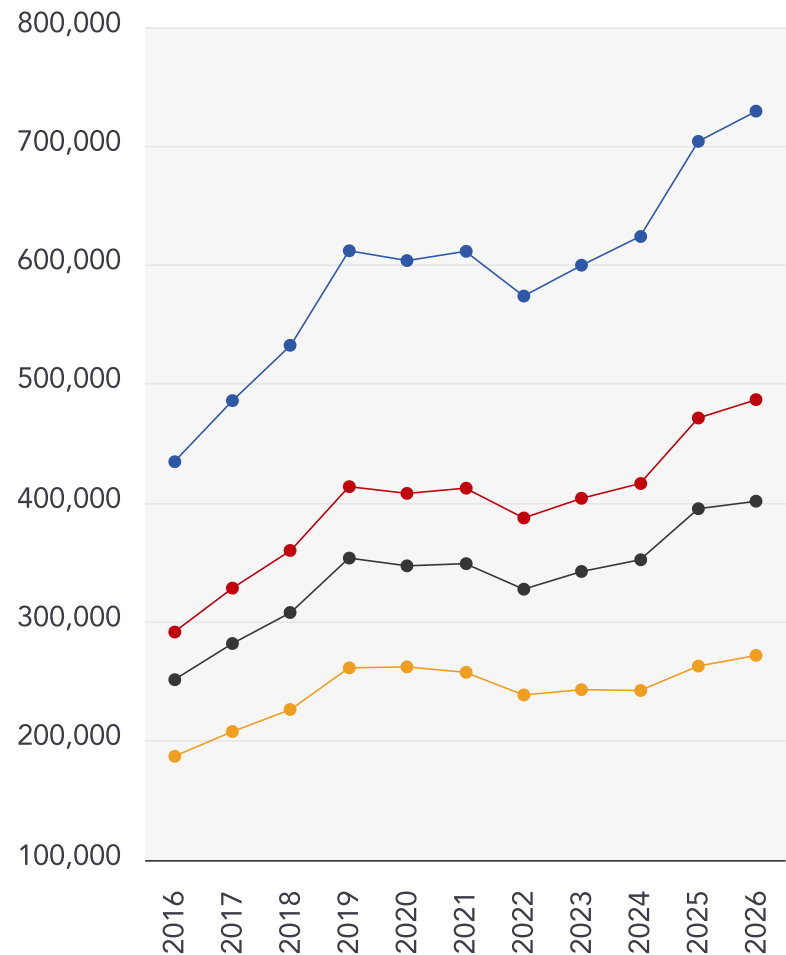

Detached

**+67.78%**

Semi-Detached

**+66.97%**

Terraced

**+59.63%**

Flat

**+45.31%**



# Maps

## Conservation Areas



This map displays nearby official conservation areas. Every local authority in England has at least one conservation area. Most are designated by the Council as the local planning authority, though Historic England and the Secretary of State also have the power to create them.

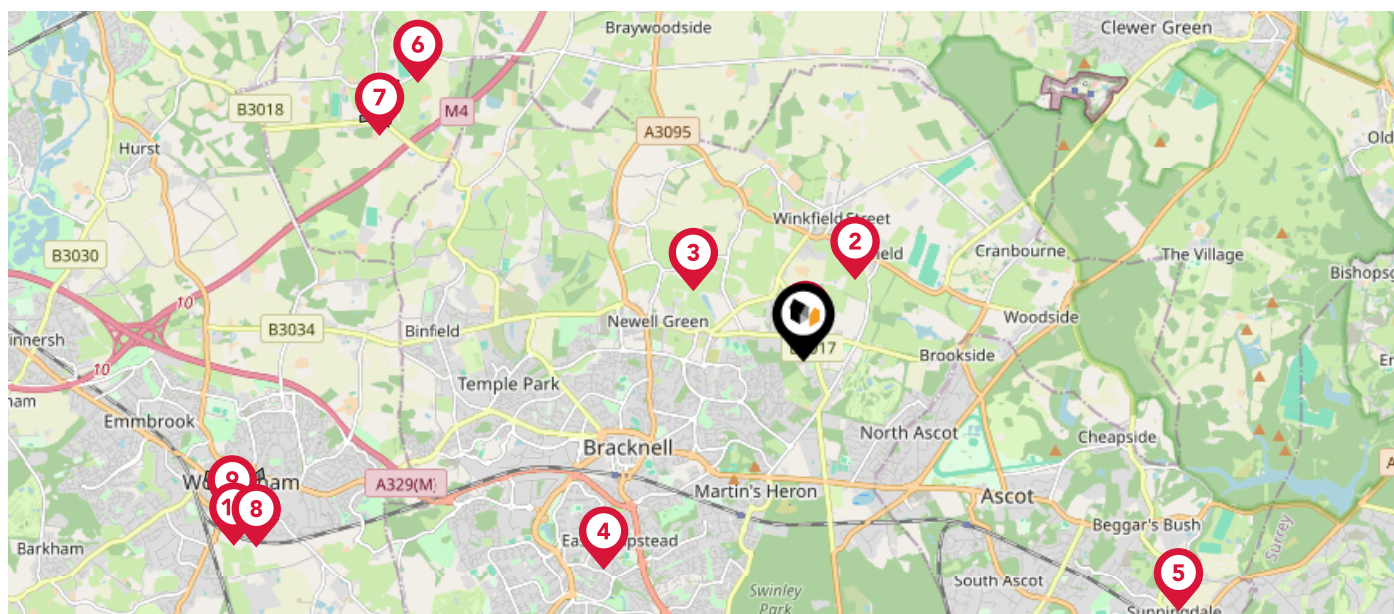

### Nearby Conservation Areas

- 1 Winkfield Row
- 2 Winkfield Village
- 3 Warfield
- 4 Easthampstead
- 5 Sunningdale
- 6 Beenham's Heath
- 7 Shurlock Row
- 8 Murdoch Road
- 9 Wokingham Town Centre
- 10 Langborough Road

# Maps

## Council Wards



The UK is divided into wards that are used for local elections to elect local government councillors. Sometimes these are known as 'electoral divisions'. Population counts can vary substantially between wards, but the national average is about 5,500

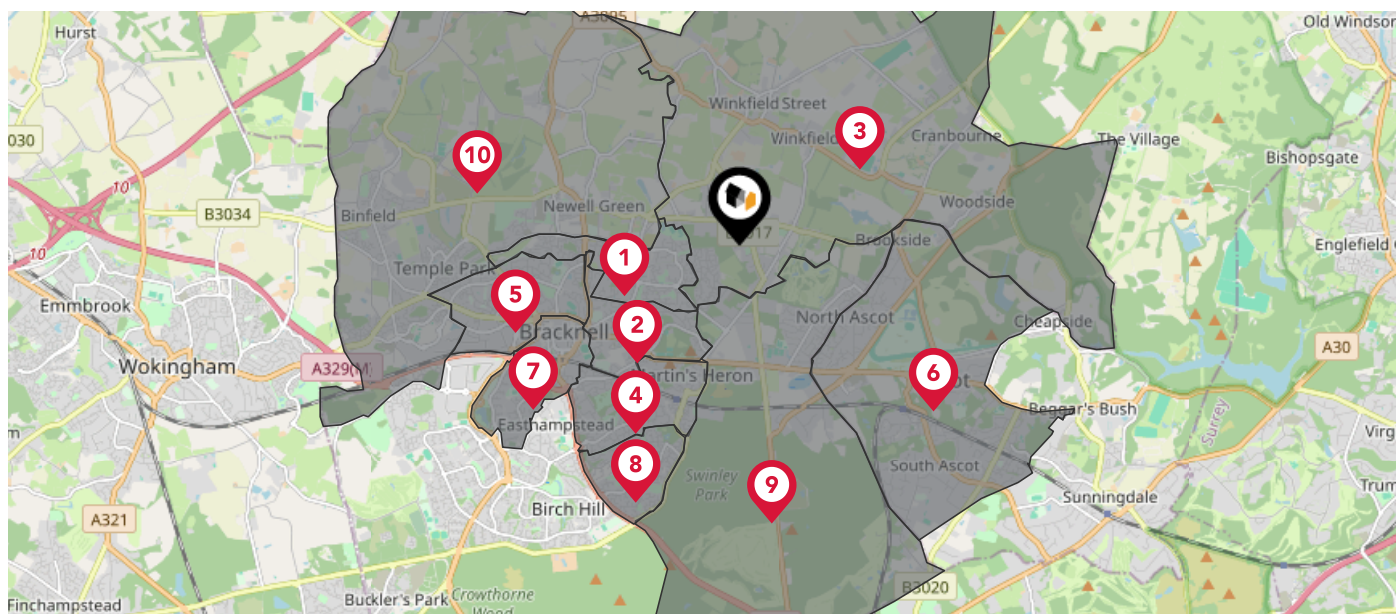

### Nearby Council Wards



Warfield Harvest Ride Ward



Bullbrook Ward



Winkfield and Cranbourne Ward



Harmans Water Ward



Priestwood and Garth Ward



Ascot & Sunninghill Ward



Wildridings and Central Ward



Crown Wood Ward



Ascot Ward



Binfield with Warfield Ward



# Flood Risk

## Rivers & Seas - Flood Risk



This map shows the chance of flooding from rivers and / or the sea, taking into account flood defences and their condition.

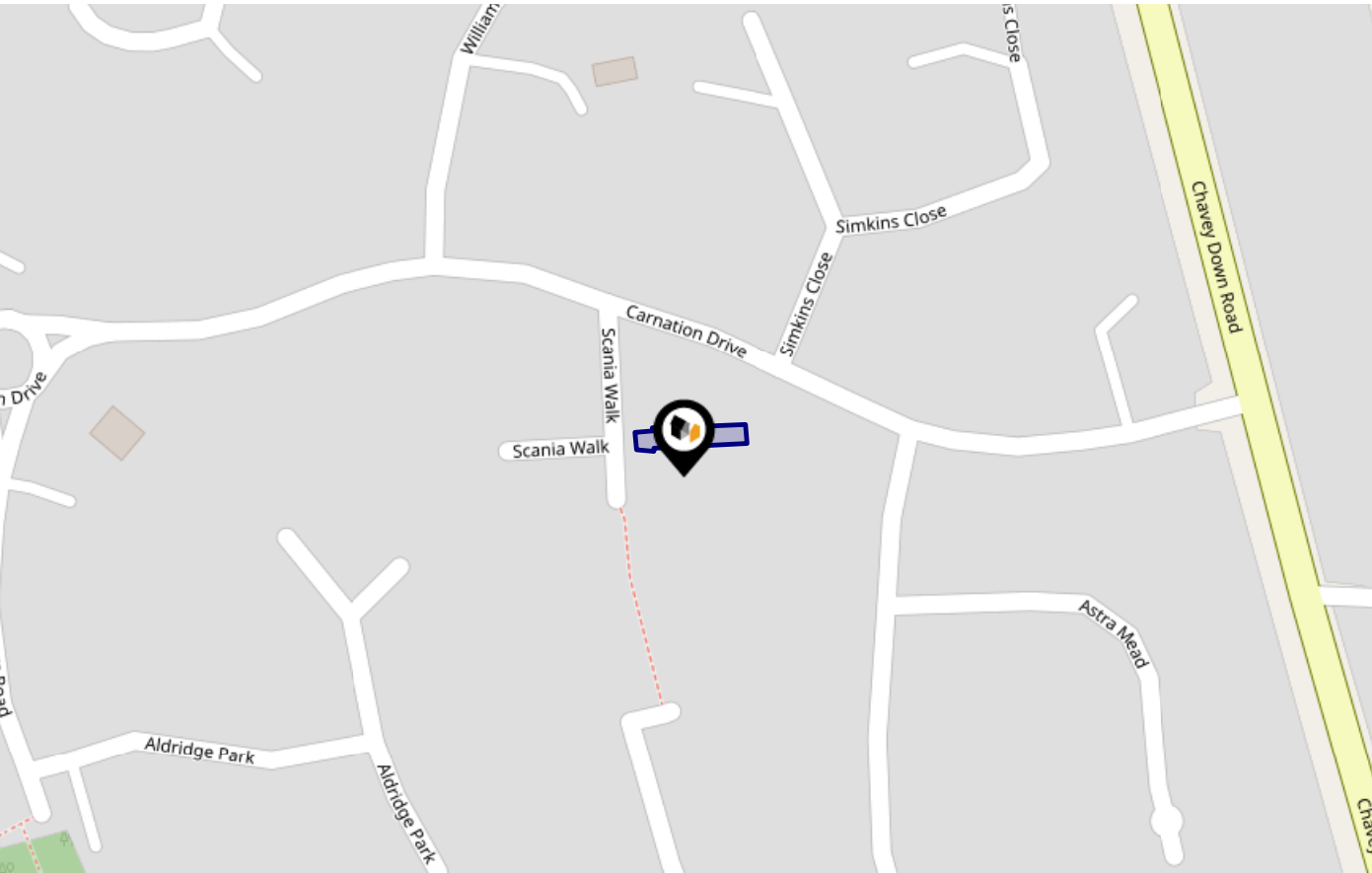

Risk Rating: Very low

The map does not contain sufficient information for it to be used to determine flood risk to individual properties, but it does give you an indication of whether your area may be affected by surface water flooding at this risk level.

- High Risk** - an area which has a chance of flooding of greater than 1 in 30 (3.3%) in any one year.
- Medium Risk** - an area which has a chance of flooding of greater than 1 in 100 (1.0%) in any one year.
- Low Risk** - an area which has a chance of flooding of greater than 1 in 1000 (0.1%) in any one year.
- Very Low Risk** - an area in which the risk is below 1 in 1000 (0.1%) in any one year.

Chance of flooding to the following depths at this property:

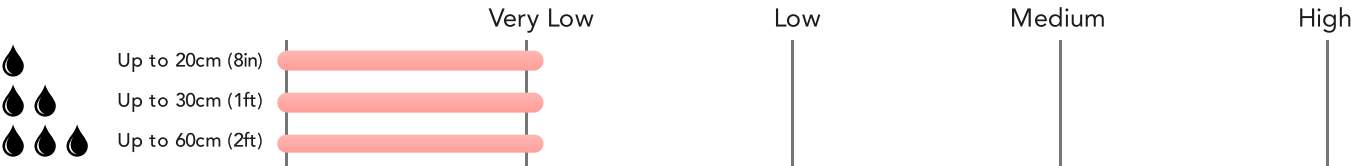

# Flood Risk

## Rivers & Seas - Climate Change



This map shows the future chance of flooding from rivers and / or the sea **between 2036 and 2069**, taking into account flood defences and their condition. The government climate change models cannot predict exactly when the chance of flooding will go up. It could happen at any time during the time period.

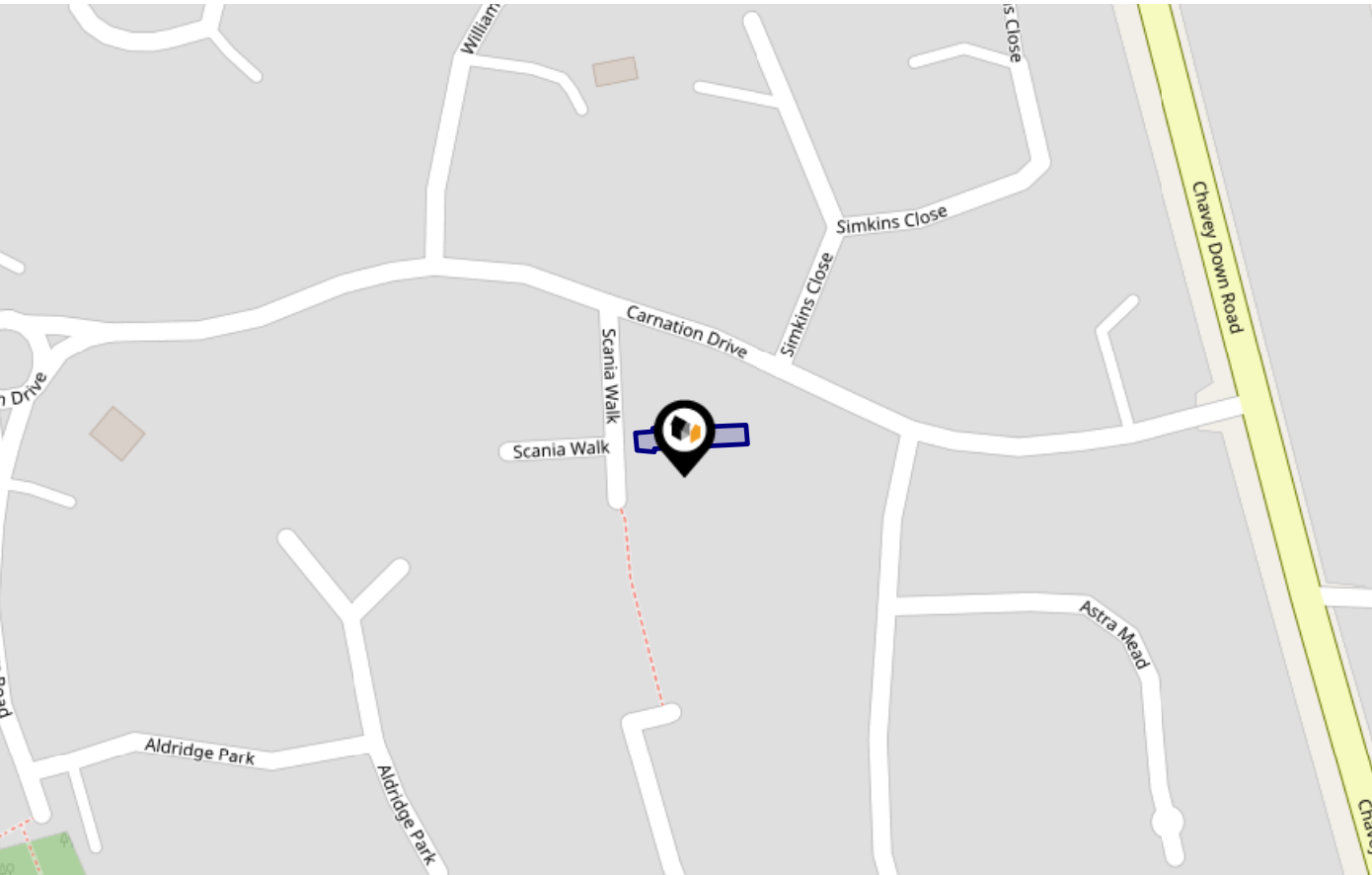

Risk Rating: Very low

The map does not contain sufficient information for it to be used to determine flood risk to individual properties, but it does give you an indication of whether your area may be affected by surface water flooding at this risk level.

- High Risk** - an area which has a chance of flooding of greater than 1 in 30 (3.3%) in any one year.
- Medium Risk** - an area which has a chance of flooding of greater than 1 in 100 (1.0%) in any one year.
- Low Risk** - an area which has a chance of flooding of greater than 1 in 1000 (0.1%) in any one year.
- Very Low Risk** - an area in which the risk is below 1 in 1000 (0.1%) in any one year.

Chance of flooding to the following depths at this property:

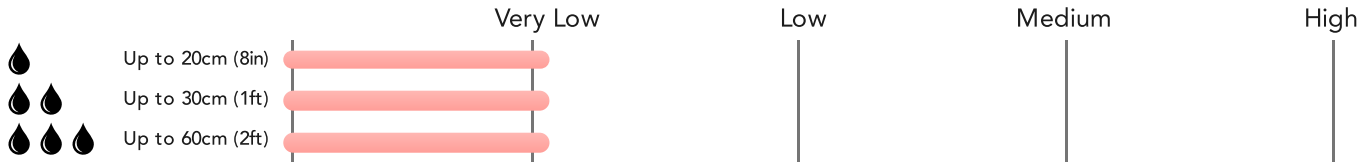

# Flood Risk

## Surface Water - Flood Risk



This map shows the chance of flooding where rainwater has nowhere to drain. This kind of flooding can occur far from rivers or seas.

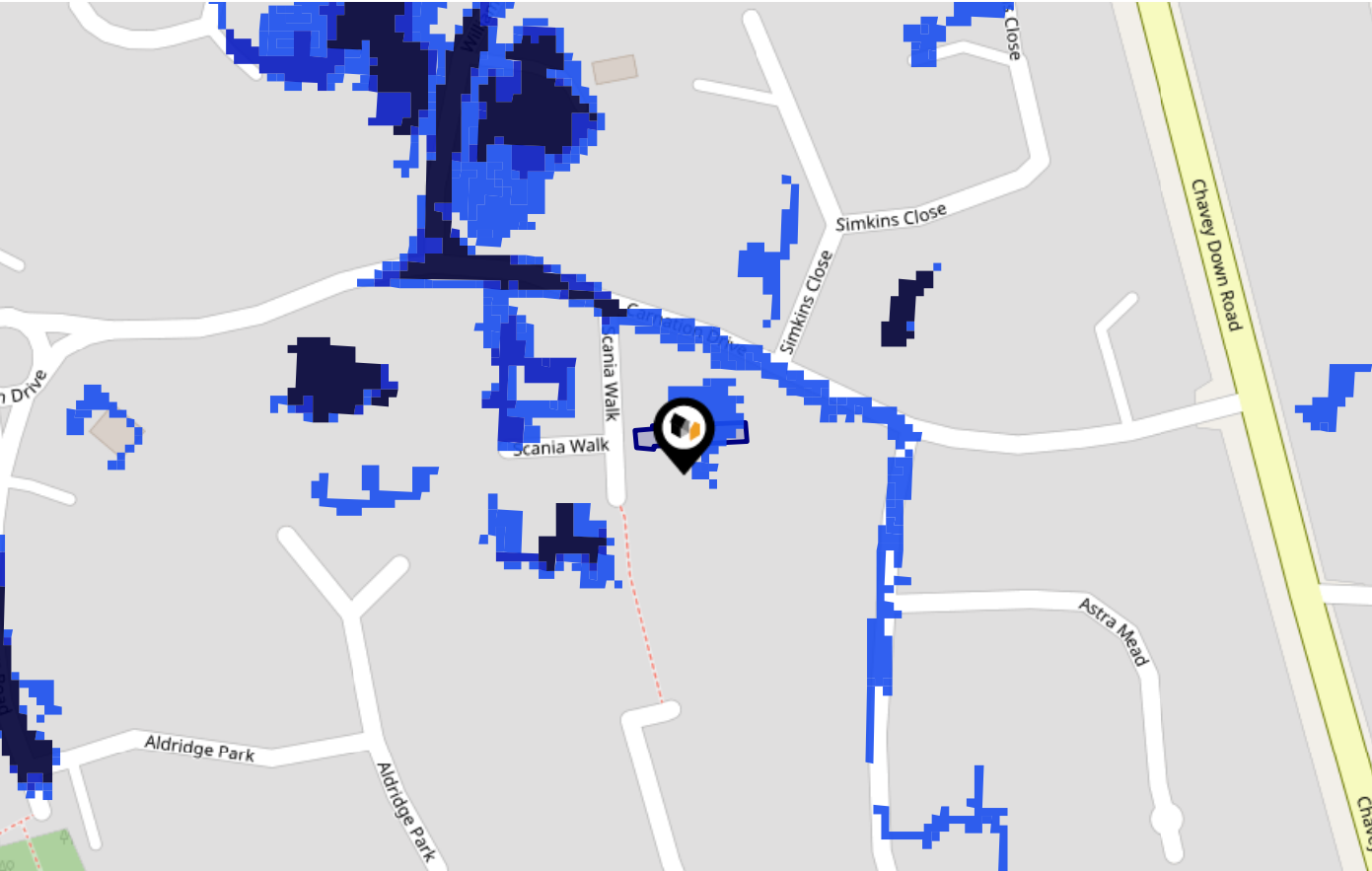

Risk Rating: Very low

The map does not contain sufficient information for it to be used to determine flood risk to individual properties, but it does give you an indication of whether your area may be affected by surface water flooding at this risk level.

- High Risk** - an area which has a chance of flooding of greater than 1 in 30 (3.3%) in any one year.
- Medium Risk** - an area which has a chance of flooding of greater than 1 in 100 (1.0%) in any one year.
- Low Risk** - an area which has a chance of flooding of greater than 1 in 1000 (0.1%) in any one year.
- Very Low Risk** - an area in which the risk is below 1 in 1000 (0.1%) in any one year.

Chance of flooding to the following depths at this property:

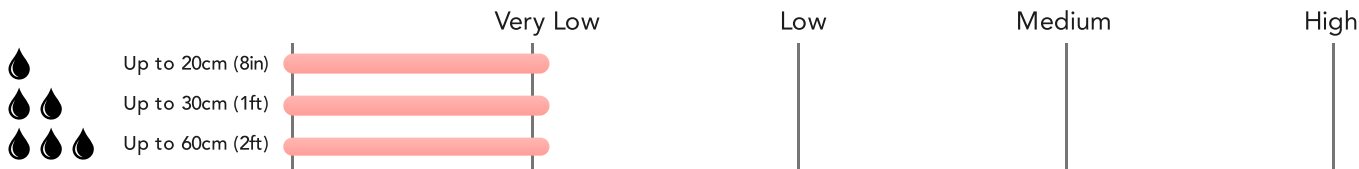

# Flood Risk

## Surface Water - Climate Change



This map shows the future chance of flooding **between 2040 and 2060** where rainwater has nowhere to drain. This kind of flooding can occur far from rivers or seas. The government climate change models cannot predict exactly when the chance of flooding will go up. It could happen at any time during the time period.

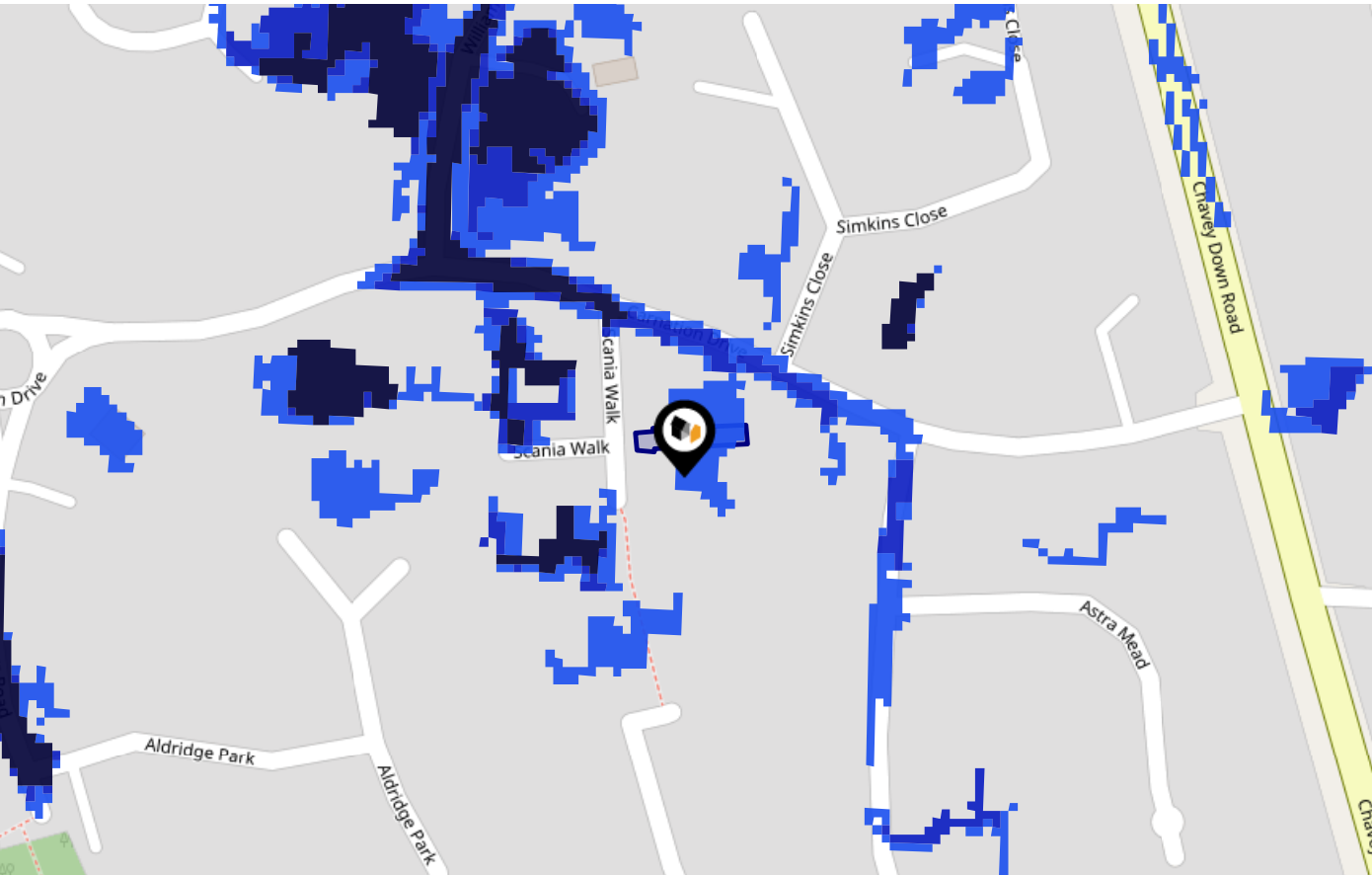

Risk Rating: Very low

The map does not contain sufficient information for it to be used to determine flood risk to individual properties, but it does give you an indication of whether your area may be affected by surface water flooding at this risk level.

- High Risk** - an area which has a chance of flooding of greater than 1 in 30 (3.3%) in any one year.
- Medium Risk** - an area which has a chance of flooding of greater than 1 in 100 (1.0%) in any one year.
- Low Risk** - an area which has a chance of flooding of greater than 1 in 1000 (0.1%) in any one year.
- Very Low Risk** - an area in which the risk is below 1 in 1000 (0.1%) in any one year.

Chance of flooding to the following depths at this property:

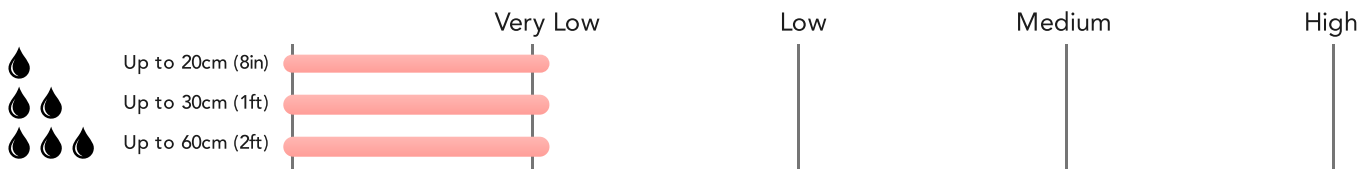

# Maps







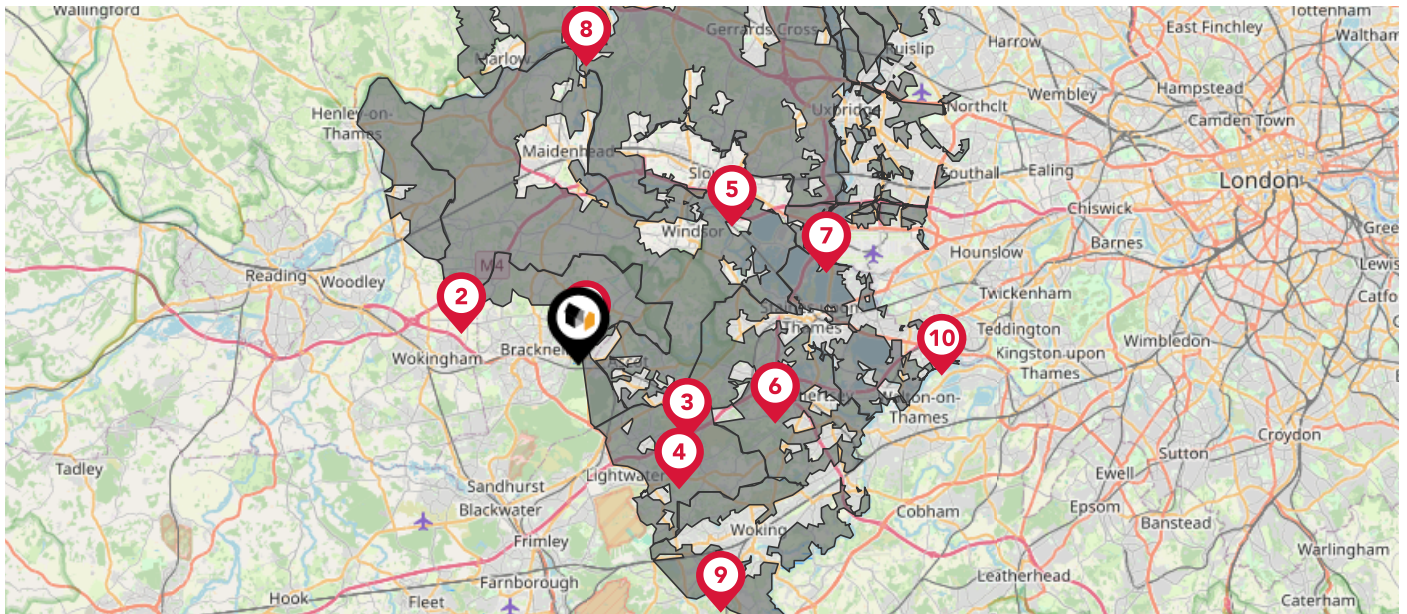



## Green Belt



This map displays nearby areas that have been designated as Green Belt...



### Nearby Green Belt Land

-  1 London Green Belt - Bracknell Forest
-  2 London Green Belt - Wokingham
-  3 London Green Belt - Windsor and Maidenhead
-  4 London Green Belt - Surrey Heath
-  5 London Green Belt - Slough
-  6 London Green Belt - Runnymede
-  7 London Green Belt - Hillingdon
-  8 London Green Belt - Buckinghamshire
-  9 London Green Belt - Woking
-  10 London Green Belt - Spelthorne











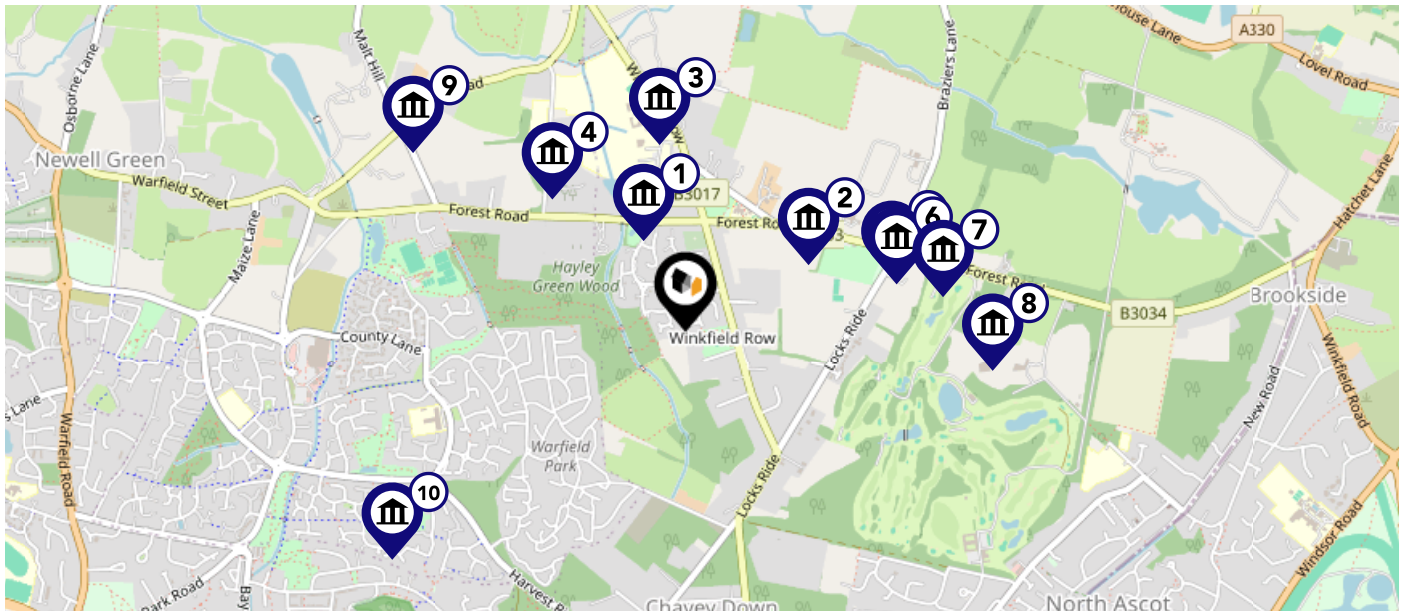

# Maps

## Listed Buildings



This map displays nearby listed buildings and protected structures, as well as their listed tier and distance from the target property...



Listed Buildings in the local district	Grade	Distance
 1390454 - Winkfield Row, Ronans	Grade II	0.2 miles
 1390450 - Somerton House	Grade II	0.3 miles
 1061316 - Apple Tree Cottage	Grade II	0.4 miles
 1390398 - Brockdale	Grade II	0.4 miles
 1390447 - The Cottages	Grade II	0.5 miles
 1390451 - The Keeper's Cottage	Grade II	0.5 miles
 1390453 - Weycroft	Grade II	0.6 miles
 1390452 - Tudor Cottage	Grade II	0.7 miles
 1390392 - Milestone 100 Metres North-east Of Junction With Hayley Green Road	Grade II	0.7 miles
 1390406 - Icehouse In Grounds To N Of Garden Cottage (not Included), S Of Warfield Park	Grade II	0.8 miles



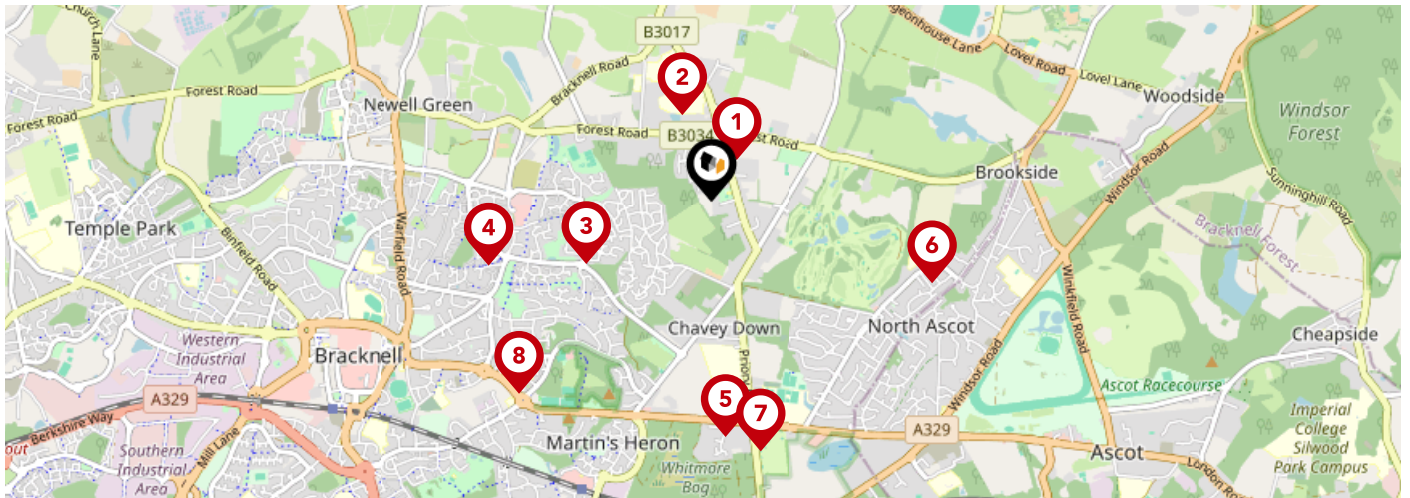



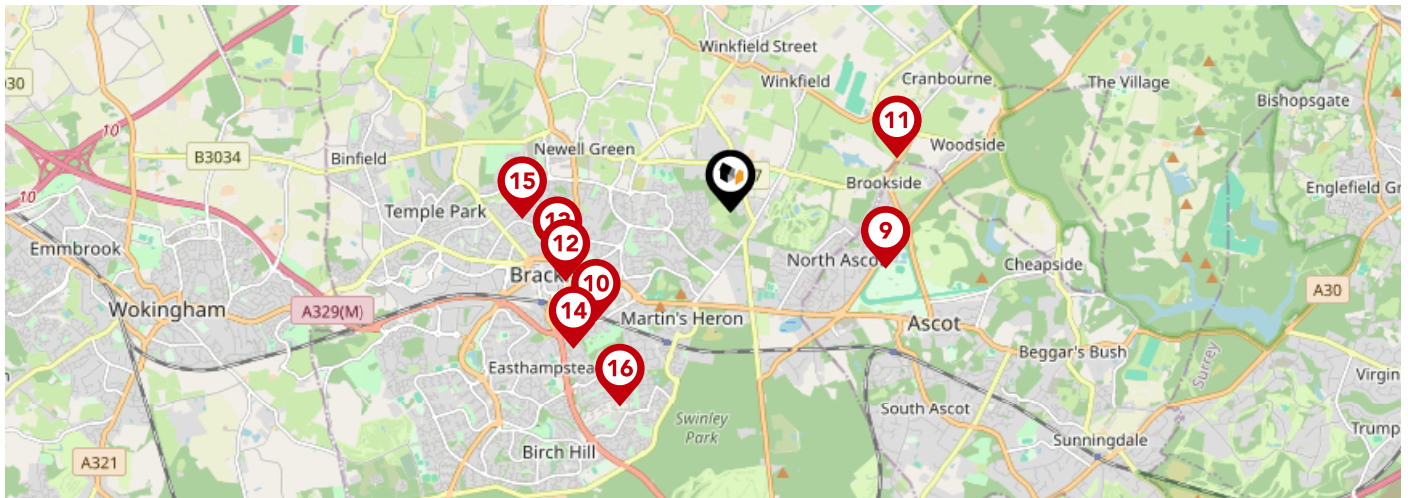

# Area Schools



		Nursery	Primary	Secondary	College	Private
<b>1</b>	<b>Winkfield St Mary's CofE Primary School</b> Ofsted Rating: Good   Pupils: 198   Distance:0.23	<input type="checkbox"/>	<input checked="" type="checkbox"/>	<input type="checkbox"/>	<input type="checkbox"/>	<input type="checkbox"/>
<b>2</b>	<b>Lambrook School</b> Ofsted Rating: Not Rated   Pupils: 630   Distance:0.42	<input type="checkbox"/>	<input type="checkbox"/>	<input checked="" type="checkbox"/>	<input type="checkbox"/>	<input type="checkbox"/>
<b>3</b>	<b>Whitegrove Primary School</b> Ofsted Rating: Good   Pupils: 421   Distance:0.64	<input type="checkbox"/>	<input checked="" type="checkbox"/>	<input type="checkbox"/>	<input type="checkbox"/>	<input type="checkbox"/>
<b>4</b>	<b>Warfield Church of England Primary School</b> Ofsted Rating: Good   Pupils: 452   Distance:1.07	<input type="checkbox"/>	<input checked="" type="checkbox"/>	<input type="checkbox"/>	<input type="checkbox"/>	<input type="checkbox"/>
<b>5</b>	<b>Heathfield School</b> Ofsted Rating: Not Rated   Pupils: 226   Distance:1.09	<input type="checkbox"/>	<input type="checkbox"/>	<input checked="" type="checkbox"/>	<input type="checkbox"/>	<input type="checkbox"/>
<b>6</b>	<b>Ascot Heath Primary School</b> Ofsted Rating: Good   Pupils: 395   Distance:1.09	<input type="checkbox"/>	<input checked="" type="checkbox"/>	<input type="checkbox"/>	<input type="checkbox"/>	<input type="checkbox"/>
<b>7</b>	<b>LVS Ascot</b> Ofsted Rating: Not Rated   Pupils: 840   Distance:1.18	<input type="checkbox"/>	<input type="checkbox"/>	<input checked="" type="checkbox"/>	<input type="checkbox"/>	<input type="checkbox"/>
<b>8</b>	<b>Holly Spring Primary School</b> Ofsted Rating: Good   Pupils: 642   Distance:1.26	<input type="checkbox"/>	<input checked="" type="checkbox"/>	<input type="checkbox"/>	<input type="checkbox"/>	<input type="checkbox"/>

# Area Schools



		Nursery	Primary	Secondary	College	Private
	<b>Papplewick School</b> Ofsted Rating: Not Rated   Pupils: 223   Distance:1.52	<input type="checkbox"/>	<input type="checkbox"/>	<input checked="" type="checkbox"/>	<input type="checkbox"/>	<input type="checkbox"/>
	<b>St Joseph's Catholic Primary School, Bracknell</b> Ofsted Rating: Good   Pupils: 209   Distance:1.61	<input type="checkbox"/>	<input checked="" type="checkbox"/>	<input type="checkbox"/>	<input type="checkbox"/>	<input type="checkbox"/>
	<b>Cranbourne Primary School</b> Ofsted Rating: Outstanding   Pupils: 186   Distance:1.61	<input type="checkbox"/>	<input checked="" type="checkbox"/>	<input type="checkbox"/>	<input type="checkbox"/>	<input type="checkbox"/>
	<b>Garth Hill College</b> Ofsted Rating: Good   Pupils: 1476   Distance:1.66	<input type="checkbox"/>	<input type="checkbox"/>	<input checked="" type="checkbox"/>	<input type="checkbox"/>	<input type="checkbox"/>
	<b>Sandy Lane Primary School</b> Ofsted Rating: Good   Pupils: 450   Distance:1.66	<input type="checkbox"/>	<input checked="" type="checkbox"/>	<input type="checkbox"/>	<input type="checkbox"/>	<input type="checkbox"/>
	<b>Ranelagh School</b> Ofsted Rating: Outstanding   Pupils: 1062   Distance:1.92	<input type="checkbox"/>	<input type="checkbox"/>	<input checked="" type="checkbox"/>	<input type="checkbox"/>	<input type="checkbox"/>
	<b>Kennel Lane School</b> Ofsted Rating: Good   Pupils:0   Distance:1.93	<input type="checkbox"/>	<input type="checkbox"/>	<input checked="" type="checkbox"/>	<input type="checkbox"/>	<input type="checkbox"/>
	<b>Harmans Water Primary School</b> Ofsted Rating: Good   Pupils: 466   Distance:2.07	<input type="checkbox"/>	<input checked="" type="checkbox"/>	<input type="checkbox"/>	<input type="checkbox"/>	<input type="checkbox"/>



# Area

## Transport (National)

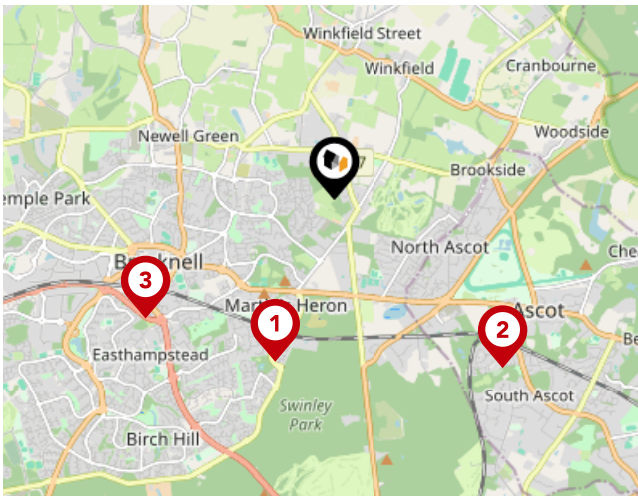

### National Rail Stations

Pin	Name	Distance
1	Martins Heron Rail Station	1.6 miles
2	Ascot Rail Station	2.19 miles
3	Bracknell Rail Station	2.07 miles

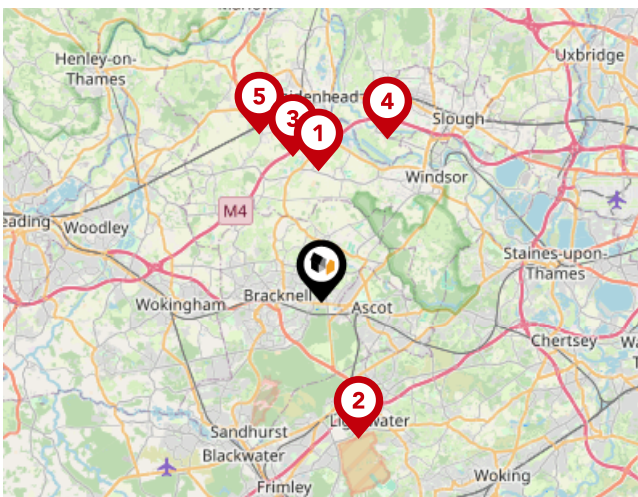

### Trunk Roads/Motorways

Pin	Name	Distance
1	M4 J8	4.87 miles
2	M3 J3	5.21 miles
3	A404(M) J9A	5.52 miles
4	M4 J7	6.51 miles
5	A404(M) J9	6.62 miles

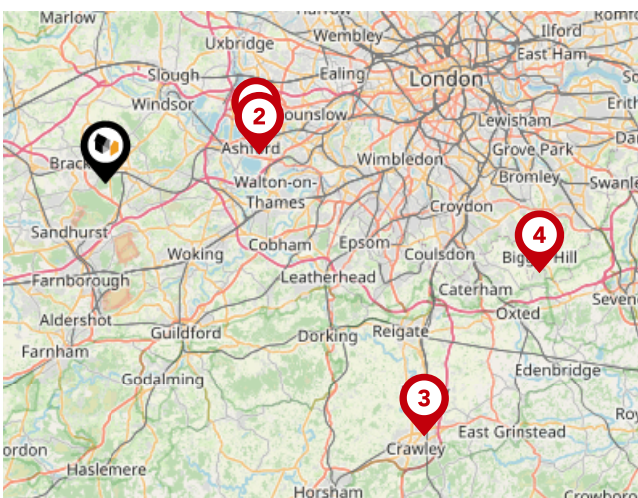

### Airports/Helipads

Pin	Name	Distance
1	Heathrow Airport	11.59 miles
2	Heathrow Airport Terminal 4	11.57 miles
3	Gatwick Airport	30.29 miles
4	Leaves Green	32.84 miles

# Area

## Transport (Local)

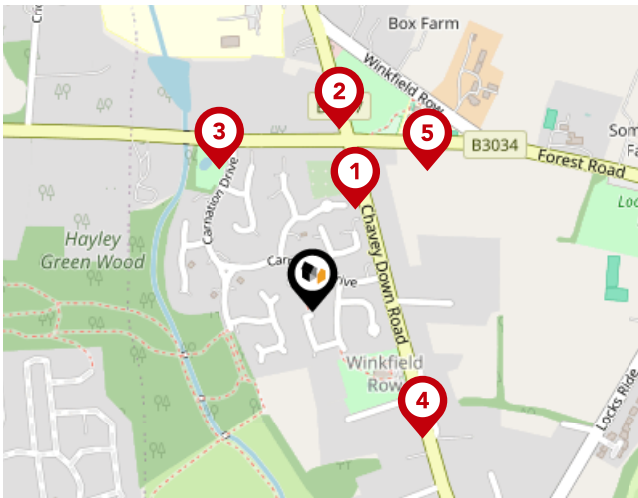

### Bus Stops/Stations

Pin	Name	Distance
1	Hollies Corner	0.13 miles
2	Hollies Corner	0.21 miles
3	Carnation Drive	0.2 miles
4	Mushroom Castle Lane	0.19 miles
5	Forest Road - St Mary's School	0.21 miles

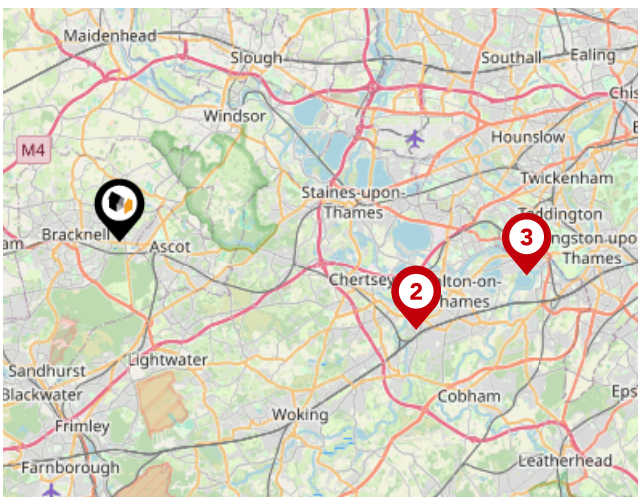

### Ferry Terminals

Pin	Name	Distance
1	Shepperton Ferry Landing	11.44 miles
2	Weybridge Ferry Landing	11.48 miles
3	Moulsey - Hurst Park Ferry Landing	15.08 miles



# Avocado Property

## Data Quality

We are committed to comprehensive property data being made available upfront to make the home buying and selling process quicker, easier and cheaper. This is why we have partnered with Sprift, the UK's leading supplier of property-specific data.



**Contains public sector information licensed under the Open Government License v3.0**

The information contained within this report is for general information purposes only.

Sprift Technologies Ltd aggregate this data from a wide variety of sources and while we endeavour to keep the information up to date and correct, we make no representations or warranties of any kind, express or implied, about the completeness, accuracy, reliability, of the information or related graphics contained within this report for any purpose.

Any reliance you place on such information is therefore strictly at your own risk. In no event will we be liable for any loss or damage including without limitation, indirect or consequential loss or damage, or any loss or damage whatsoever arising from loss of data or profits arising out of, or in connection with, the use of this report.



**Avocado Property**

07515141327

[mattandsanjay@avocadopropertyagents.co.uk](mailto:mattandsanjay@avocadopropertyagents.co.uk)

[www.avocadopropertyagents.co.uk](http://www.avocadopropertyagents.co.uk)

