



MILE



## Palermo Road, Willesden Junction NW10

£2,100 pcm

This great property comprises of a large 17ft reception with bay windows and dining area, two double bedrooms, a fully fitted separate kitchen and a modern three piece bathroom.

This bright and airy property also benefits from double glazed windows, high ceilings, wood floors throughout and an abundance of storage space and natural light.

Offered on an unfurnished basis, the property is available from June 2026

Palermo Road is within easy reach of Kensal Green and Willesden Junction Bakerloo line and Overground station as well as the numerous coffee shops, restaurants, gastro pubs and shopping amenities of Kensal Rise, Kensal Green, Ladbroke Grove and Notting Hill.

- Superb first floor apartment
- Two double bedrooms
- Excellent condition
- Fantastic location
- Available 8<sup>th</sup> June 2026!!
- Offered unfurnished
- Separate fully fitted kitchen
- Double glazed windows
- Bright and airy
- Close to shops and transports

# PALERMO ROAD

Approximate Gross Internal Area  
734 sq ft / 68.2 sq m

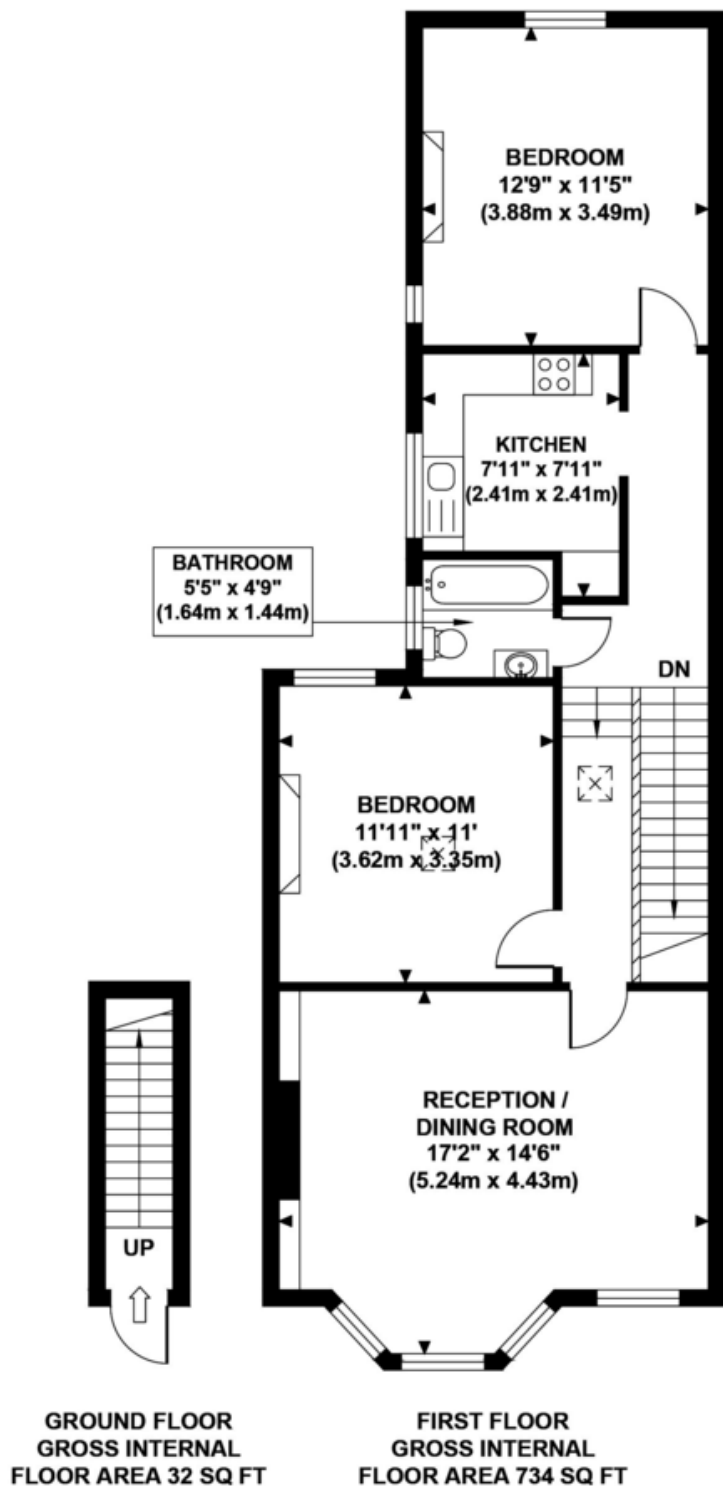

Although every attempt has been made to ensure accuracy,  
all measurements are approximate and no responsibility is taken for any error, omission, or mid-statement.  
This floor plan is for illustrative purposes only and not to scale. Measured in accordance to RICS standards.  
GB PRO PHOTOS

**MONEY LAUNDERING REGULATIONS 2003:** Intending purchasers will be asked to produce identification documentation at a later stage and we would ask for your co-operation in order that there will be no delay in agreeing the sale.

**General:** While we endeavour to make our sales particulars fair, accurate and reliable, they are only a general guide to the property and, accordingly, if there is any point which is of particular importance to you, please contact the office and we will be pleased to check the position for you, especially if you are contemplating travelling some distance to view the property.

**Measurements:** These approximate room sizes are only intended as general guidance. You must verify the dimensions carefully before ordering carpets or any built-in furniture.

**Services:** Please note we have not tested the services or any of the equipment or appliances in this property, accordingly we strongly advise prospective buyers to commission their own survey or service reports before finalising their offer to purchase.