



Tewkesbury Road, W13

£325,000

A large double-bedroom flat in excellent condition, situated on the upper floors of this modern development, benefiting from a long lease and offered to the market with no onward chain.

Ideally located for access to West Ealing station (Elizabeth Line) which provides unrivalled access to Central London. A range of shops & restaurants to enjoy locally.

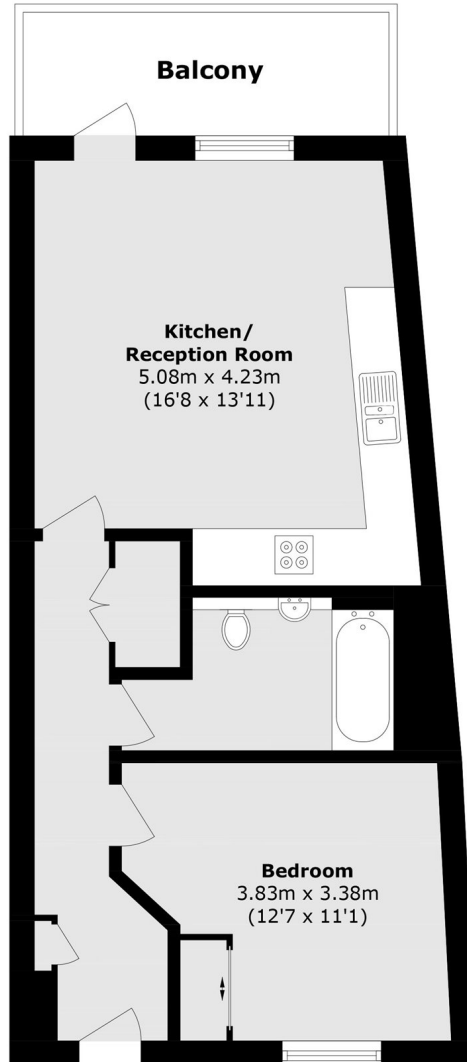

Total (approx.): 50.1 sq. m (539.2 sq. ft)

Balcony area (approx.): 6.6 sq. m (71.0 sq. ft)

Robertson Smith & Kempson Northfields Sales
116 Northfield Avenue,
London, W13 9RT
020 8566 2340
northfieldssales@robertsonsmithandkempson.co.uk

Energy Rating: . We aim to make our particulars both accurate and reliable. However they are not guaranteed; nor do they form part of an offer or contract. If you require clarification on any points then please contact us, especially if you're traveling some distance to view. Please note that appliances and heating systems have not been tested and therefore no warranties can be given as to their good working order.