



THRALE ROAD, SW16

£440,000

- Victorian flat
- Two double bedrooms
- Private garden
- Open plan reception
- Share of freehold
- Energy rating: D





## ABOUT THE HOME

A charming split level flat, offering period allure as well as a fresh interior. This property opens with a spacious reception / dining area greeting all those who enter the property, this area spans much of the ground floor and keeps an original fireplace at the heart of the room. This space seamlessly transitions into the kitchen which is found at the rear of the flat, offering an accessible and efficient workspace. The French doors connected to the kitchen allow easy access to the private South West facing garden, offering ample space for gatherings. Accessing the bedrooms is via a staircase in the reception, with the first of two doubles offering access to a private terrace. The second bedroom is found adjacent to the bathroom offering easy access which also boasts a bathtub.

The property is located on Thrale road, a highly sort after location due to its close proximity to the Tooting Common and the independent shops that give Furzedown the reputation it has.





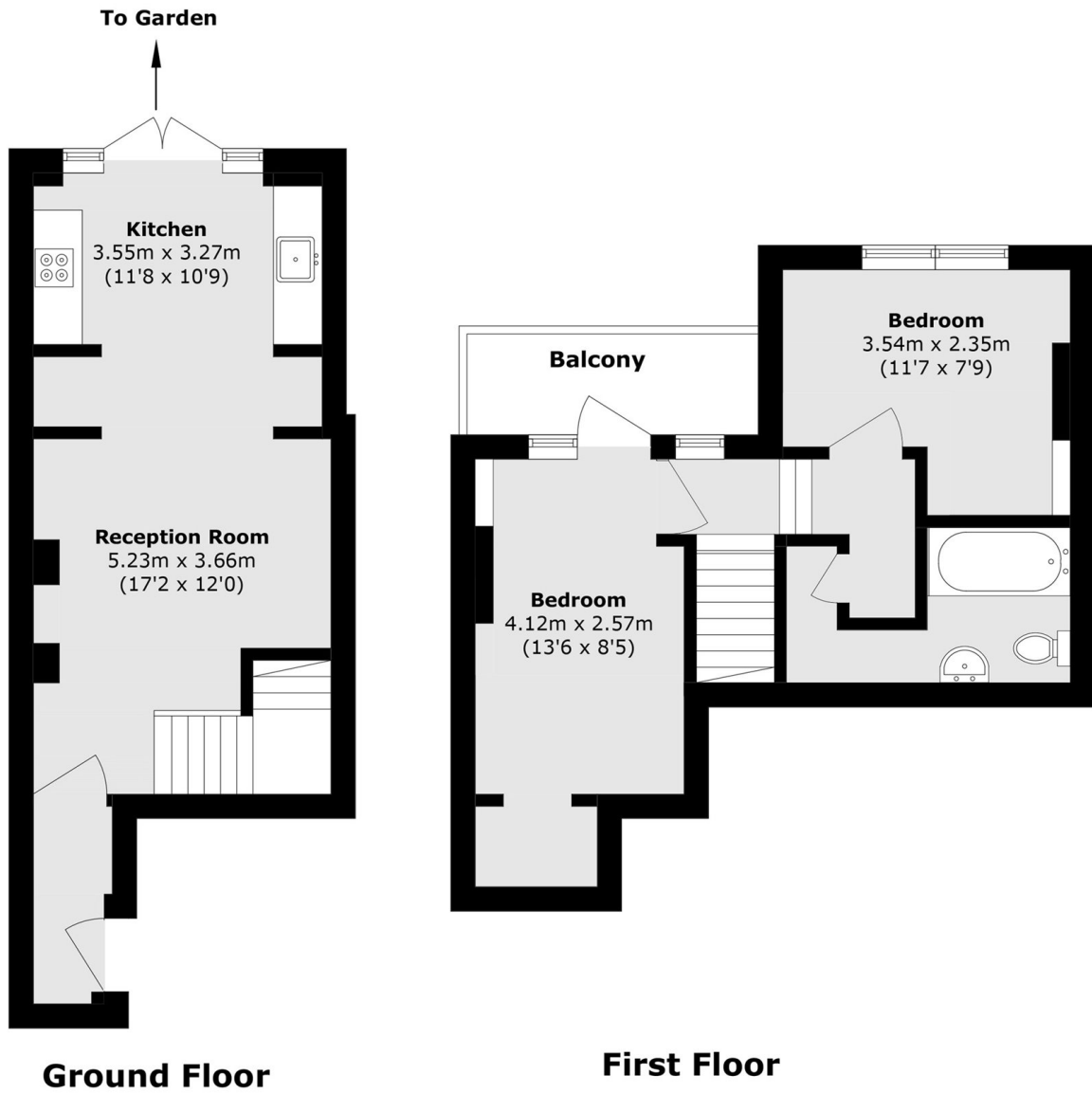

Total area (approx.): 63.3 sq. m (681.3 sq. ft)

Balcony area (approx.): 4.4 sq. m (47.3 sq. ft)

### JACKSONS TOOTING

3 Upper Tooting Road, London,  
SW17 7TS  
Sales: 020 8487 3175  
Lettings: 020 8487 3176

Energy Rating: We aim to make our particulars both accurate and reliable. However they are not guaranteed; nor do they form part of an offer or contract. If you require clarification on any points then please contact us, especially if you're traveling some distance to view. Please note that appliances and heating systems have not been tested and therefore no warranties can be given as to their good working order.