



**Ferndale Road, SW4**

**£1,150,000**

**Dexters**



## Ferndale Road, SW4

This well-proportioned mid-terrace house offers generous living space arranged over three floors.

On the ground floor, you'll find two large reception rooms. There is also useful downstairs storage space to keep clutter at bay. The kitchen is well-sized and functional, with direct access to a large, private garden. Upstairs on the first floor, there are two comfortable double bedrooms accompanied by two bathrooms. The top floor boasts a further two double bedrooms, along with a shower room, offering additional sleeping quarters or space for a home office or study.

This property is sold chain free, providing a smooth and quick purchasing process. Additionally, it has significant potential for further extension (STPP), allowing buyers to tailor the home to their own needs and increase living space if desired.

Ferndale Road is located a very short walk from the many shops, restaurants and bars of Clapham High Street and Clapham Old Town, along with Clapham North underground (Northern Line), overground and Brixton underground (Victoria Line) Stations.

### Features

- Four Double Bedroom
- Two Reception Room
- Three Bathroom
- Freehold House
- Chain Free
- Private Garden







# Ferndale Road, London, SW4

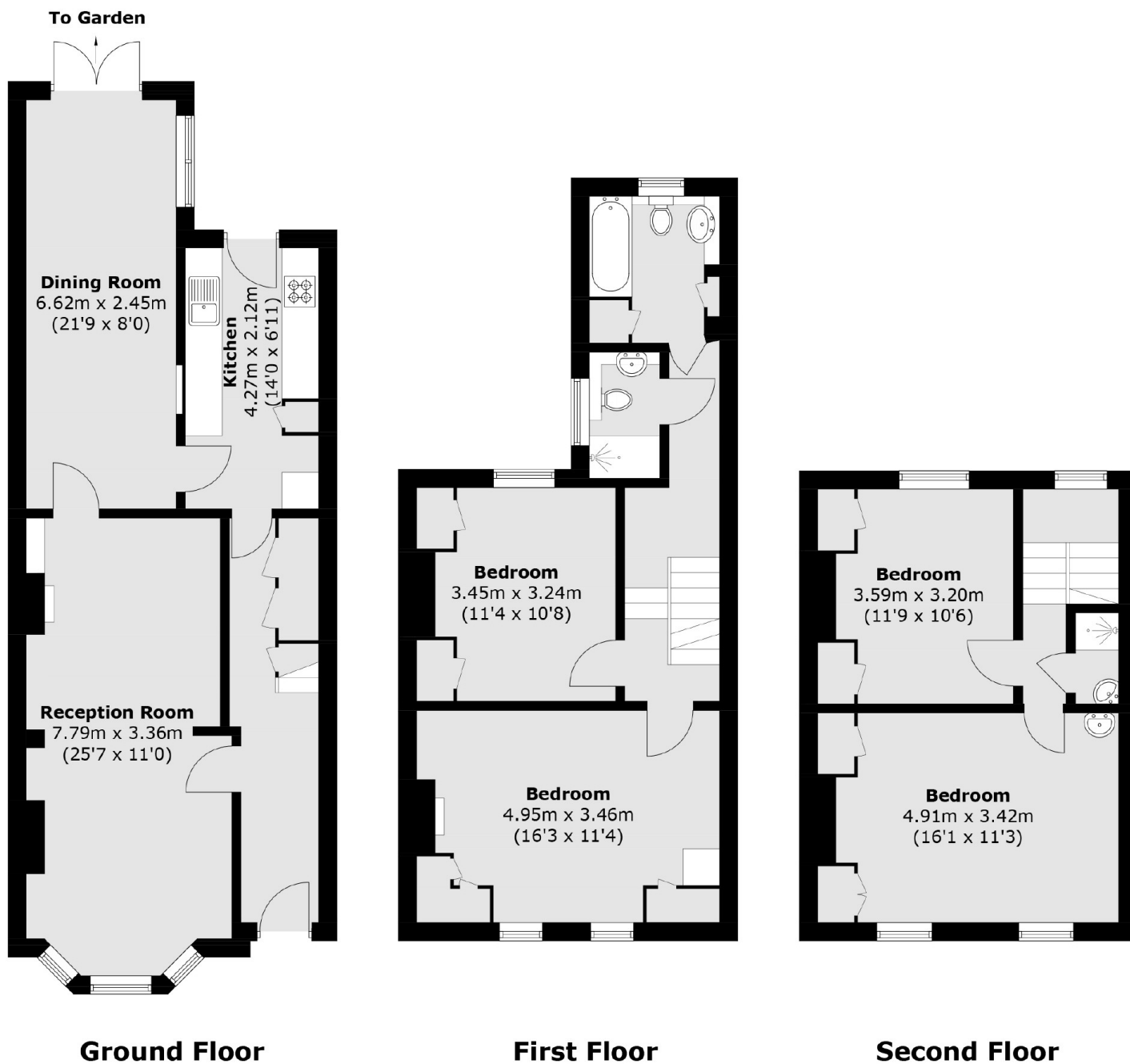

Total area (approx.): 141.1 sq. m (1,518.8 sq. ft)