



3 Rochelle Court

Market Lavington, SN10 4AT

Guide Price £125,000

Welcome to Rochelle Court, a two bedroom ground floor apartment in the large village of Market Lavington, within a 2 minute walk of the High Street.

The accommodation comprises of communal hallway, apartment hallway, living/dining room, kitchen, two bedrooms and a shower room.

The property also benefits from double glazing, electric heating and an allocated parking space.

- No Chain
- Ground Floor Aptment
- Living/Dining Room
- Kitchen
- Two Bedrooms
- Shower Room
- Allocated Parking
- Minutes from the High Street

Viewing

Please contact our Blueleaf Property Office on 01225 839050 if you wish to arrange a viewing appointment for this property or require further information.

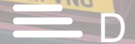

Floor Plan

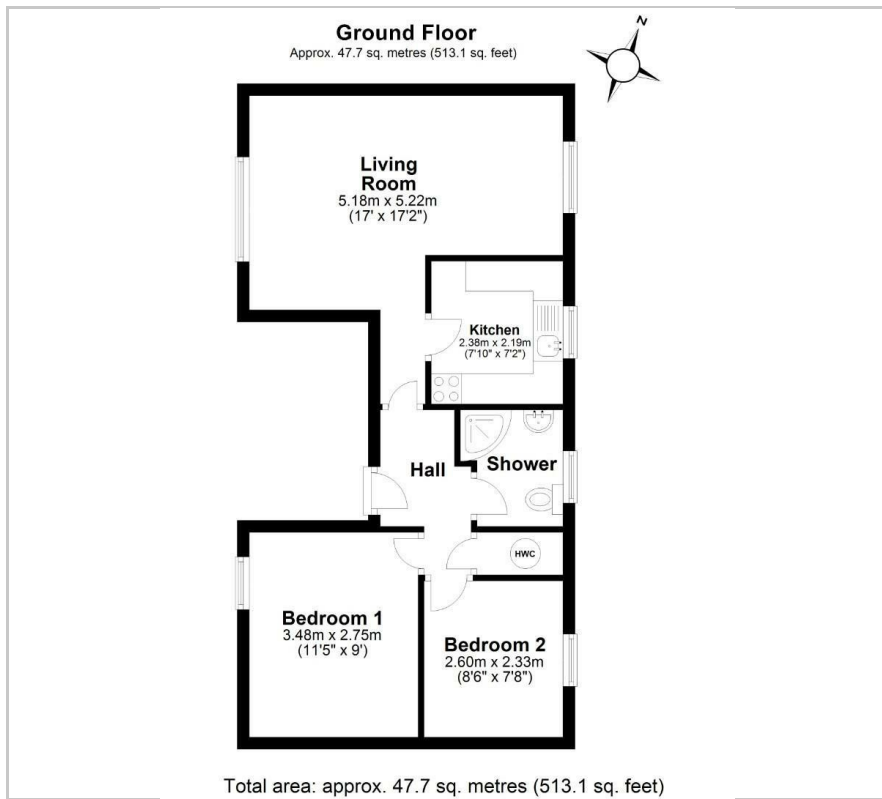

Area Map



Energy Efficiency Graph

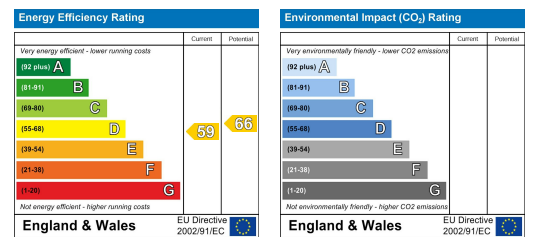

These particulars, whilst believed to be accurate are set out as a general outline only for guidance and do not constitute any part of an offer or contract. Intending purchasers should not rely on them as statements of representation of fact, but must satisfy themselves by inspection or otherwise as to their accuracy. No person in this firm's employment has the authority to make or give any representation or warranty in respect of the property.