



PRIVATE
PARKING



171 WORDSWORTH MEAD, REDHILL, SURREY, RH1 1AL

**£252,500
LEASEHOLD**

The apartments in Wordsworth Mead have always been highly desirable. Modern buildings with lots of parking available, long leases and reasonable service charges whilst being well maintained.

So take this opportunity to secure a chain free first floor apartment at the end of the cul de sac.

The 21st dual aspect lounge/diner has a westerly aspect catching the afternoon and evening sun and can be easily zoned into two separate living areas, with the dining section having it's own window, and an open arch to the fitted kitchen, which itself, is fitted with contemporary white gloss units

The main bedroom has a built in floor to ceiling double wardrobe, and bedroom two is large enough to take a double bed if needed. The fitted bathroom has a modern electric shower over the bath.

Outside there is plenty of parking for residents and visitors, along with lawned gardens to the rear.

The location is perfect for access to Redhill town and station, making it ideal for those needing the trains for work or pleasure. The town's amenities are again all within walking distance, so this apartment is a real box ticker!

Book your viewing now.

- **PURPOSE BUILT APARTMENT**
- **21FT LOUNGE/DINER**
- **DOUBLE GLAZED WINDOW**
- **CLOSE TO STATION AND TOWN**
- **COUNCIL TAX BAND: C**
- **FIRST FLOOR**
- **TWO BEDROOMS**
- **CUL DE SAC LOCATION**
- **NO ONWARD CHAIN**
- **EPC RATING: C**





ROOM DIMENSIONS:

ENTRANCE HALL

LOUNGE/DINER

21'6 x 10'7 (6.55m x 3.23m)

KITCHEN

8'0 x 7'10 (2.44m x 2.39m)

BEDROOM ONE

12'0 +wardrobe x 8'10 (3.66m +wardrobe x 2.69m)

BEDROOM TWO

9'10 x 7'7 (3.00m x 2.31m)

BATHROOM

7'1 x 6'1 (2.16m x 1.85m)

ELECTRIC HEATING

DOUBLE GLAZED WINDOWS

COMMUNAL PARKING

YEARS REMAINING ON LEASE: 950

GROUND RENT: £0

SERVICE CHARGES : £1,195.00 PER ANNUM (2026)



FIRST FLOOR
581 sq.ft. (54.0 sq.m.) approx.

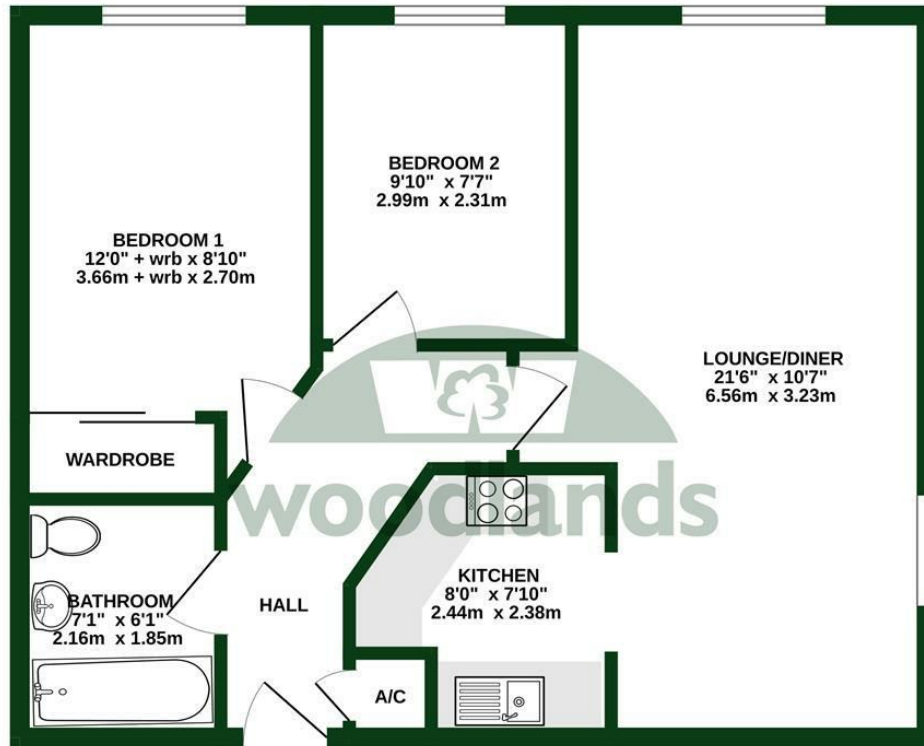

TOTAL FLOOR AREA : 581 sq.ft. (54.0 sq.m.) approx.

Whilst every attempt has been made to ensure the accuracy of the floorplan contained here, measurements of doors, windows, rooms and any other items are approximate and no responsibility is taken for any error, omission or mis-statement. This plan is for illustrative purposes only and should be used as such by any prospective purchaser. The services, systems and appliances shown have not been tested and no guarantee as to their operability or efficiency can be given.
Made with Metreplex ©2026



Energy Efficiency Rating		
	Current	Potential
Very energy efficient - lower running costs		
(92 plus) A		
(81-91) B		
(69-80) C	77	79
(55-68) D		
(39-54) E		
(21-38) F		
(1-20) G		
Not energy efficient - higher running costs		
England & Wales	EU Directive 2002/91/EC	

To view this property please call 01737 771777

www.woodlands-estates.co.uk

These particulars are set out as a general outline for the guidance of intending purchasers or lessees and do not constitute any part of an offer or contract. No person in the employment of the above named agents has any authority to make or give any representation or warranty whatsoever in relation to this property. If there is any point which is of particular interest, please contact our office and we will be pleased to check the information. The mention of any appliances and/or services does not imply they are in full and efficient working order.