



# Lismore Close

Great Billing, Northampton

oriordanbond  
SALES & LETTINGS



GROUND FLOOR  
766 sq.ft. (71.2 sq.m.) approx.

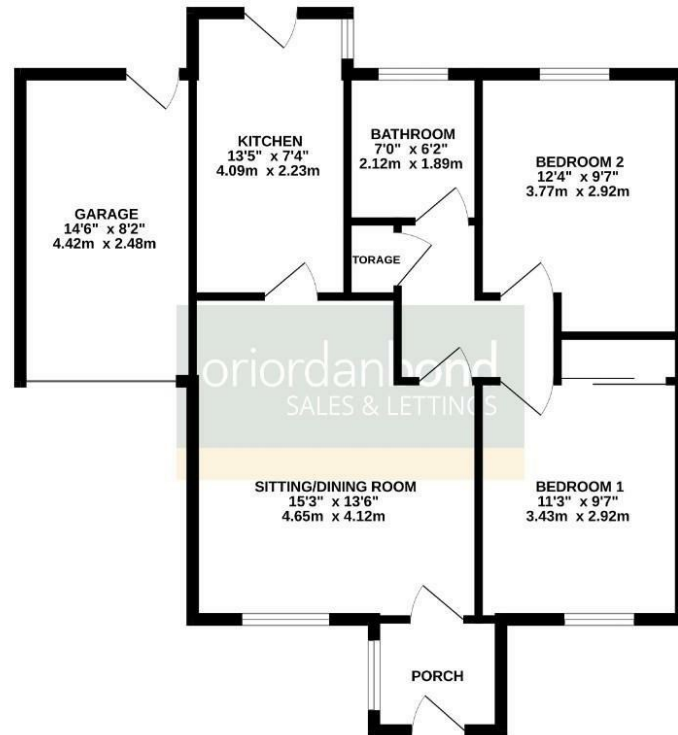

TOTAL FLOOR AREA : 766 sq.ft. (71.2 sq.m.) approx.  
While every attempt has been made to ensure the accuracy of the floorplan contained here, measurements of rooms, windows, doors and any other items are approximations and no responsibility is taken for any error, omission or mis-statement. This plan is for illustrative purposes only and should be used as such by any prospective purchaser. The services, systems and appliances shown have not been tested and no guarantee, as to their operability or efficiency, can be given.  
Made with floorplan 02020

## Lismore Close

Great Billing  
NN3 9HE

PRICE £285,000

An immaculately presented two bedroom detached bungalow, situated in the popular location of Great Billing, offered to the market in show home condition with modern stylish interior and driveway with garage.

The accommodation comprises entrance hall, sitting/dining room, re-fitted kitchen, two double bedrooms and a re-fitted shower room. Outside is a well maintained low maintenance front garden with driveway providing off road parking leading to a single garage. To the rear is an enclosed fully landscaped, low maintenance garden. Further benefits include gas radiator heating and uPVC double glazing. (A/766/M)

### Additional information

- Council Tax Band: C
- Energy Efficiency Rating: D

### Viewing

Viewing strictly by appointment – details below

### Disclaimer

O'Riordan Bond Estate Agents Limited has not tested apparatus, equipment, fittings or services and so cannot verify they are in working order. The buyer is advised to obtain verification from their solicitor or surveyor.

O'Riordan Bond Weston Favell Sales  
01604 784007

westonfavell@oriordanbond.co.uk

