



Kensington Apartments, 11 Commercial Street, London E1 6LW

 **2 Bedrooms**  **2 Bathrooms**  **1 Reception Room**



Kensington Apartments, London E1

Leasehold (984 years remaining)

A sophisticated apartment within Kensington Apartments, part of the Cityscape development, offering private balcony space overlooking landscaped courtyard gardens with City views.

Key Features

- 2 Bedrooms, 2 Bathrooms
- Chain free
- On-site concierge and gym
- Council Tax: **F**
- Service Charge: **£6,789 P/A**
- Ground Rent: **£250 P/A**
- Excellent transport links
- EPC: **B**

Positioned in the heart of East London, Kensington Apartments at 11 Commercial Street presents contemporary urban living with exceptional connectivity to the City. This thoughtfully designed development combines modern residential comfort with comprehensive amenities, creating an environment perfectly suited to London's dynamic lifestyle.

This two-bedroom, two-bathroom apartment offers well-proportioned living space enhanced by a private balcony overlooking the development's landscaped courtyard gardens, with views extending towards the City skyline.









Kensington Apartments

Approximate Gross Internal Area = 68.5 sq m / 737 sq ft

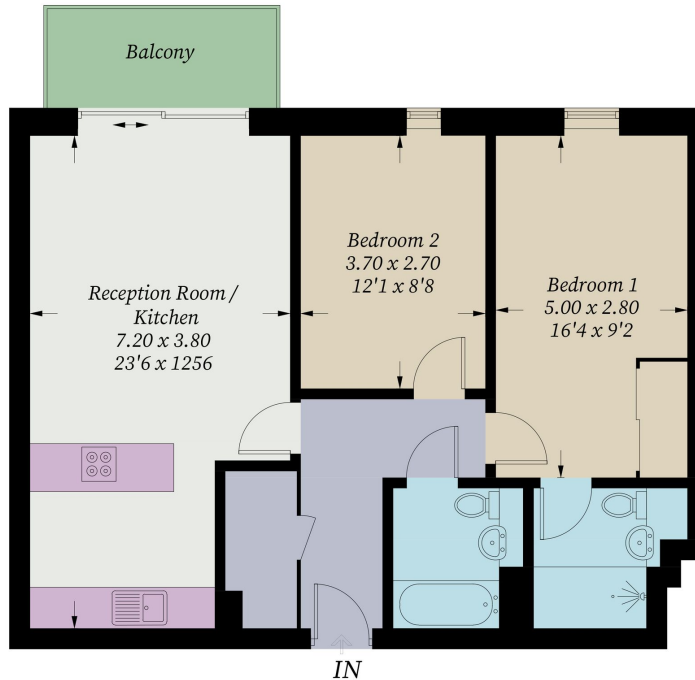

Illustration for identification purposes only, measurements are approximate, not to scale. Fourlabs.co © (ID1317237)