



Frognal

Hampstead, NW3

Asking Price £965,000

A beautifully presented and exceptionally bright two double bedroom first floor flat extending to approximately 857 square feet, set within this attractive period house and ideally positioned on one of Hampstead's most sought-after residential roads just 0.2 miles from Hampstead Village.

This elegant property offers a spacious entrance hall, a superb open-plan kitchen, a dining and reception room measuring 24 feet in length, creating an impressive entertaining space with large sash windows and bespoke shutters, excellent natural light and attractive wood flooring throughout. The contemporary fitted kitchen is seamlessly integrated into the living area and provides ample storage and workspace.

Both double bedrooms are generously proportioned and benefit from built-in wardrobes. The flat is further complemented by a well-appointed bathroom.

Occupying a prime position on Frognal, the property is conveniently located for the extensive shops, cafés and restaurants of Hampstead Village, reached via the picturesque Frognal Way. Hampstead Underground Station (Northern Line) and Finchley Road's transport links (Jubilee & Metropolitan Lines) are also within close proximity. Sole agent.

CHESTERTONS



Frognal

Hampstead, NW3

- Two double bedroom first floor flat
- 857 square feet
- Beautiful period building
- Extremely bright
- New boiler installed in 2026
- Share of freehold & a long lease
- 0.2 miles to Hampstead Village



Tenure: Share of Freehold and a long lease of 968 years remaining.

Service Charge: £2,600 per annum.

Ground Rent: £0

Local Authority: Camden

Council Tax Band: F

Score	Energy rating	Current	Potential
92+	A		
81-91	B		83 B
69-80	C	71 C	
55-68	D		
39-54	E		
21-38	F		
1-20	G		

Chestertons Hampstead Sales

55-56 Hampstead High Street
Hampstead
NW3 1QH
hampstead@chestertons.co.uk
020 7794 3311
chestertons.co.uk

Froggnal, Hampstead, NW3

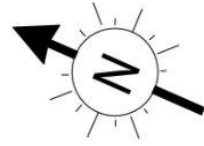

○ - Ceiling Height

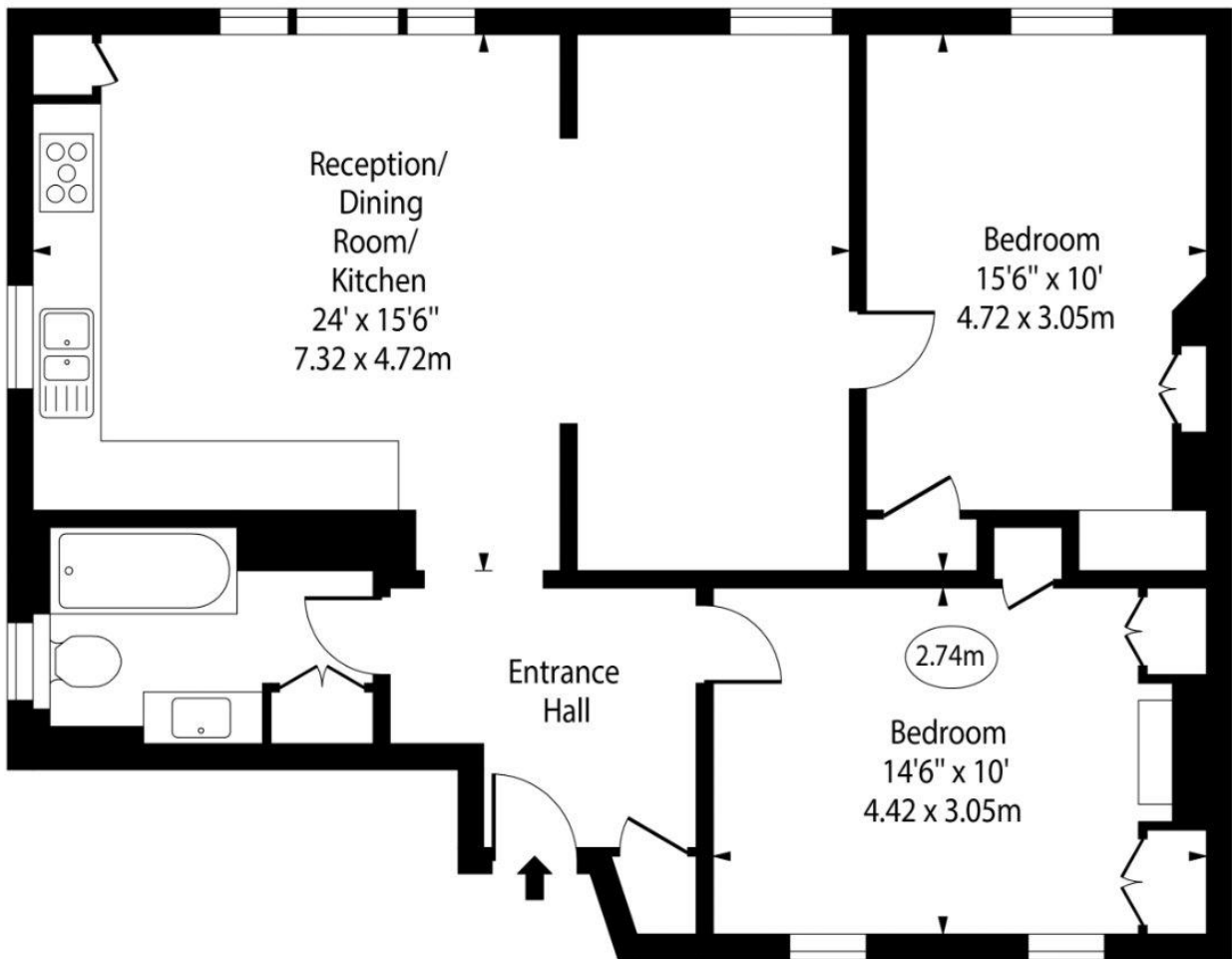

First Floor

Approx Gross Internal Area 857 Sq Ft - 79.62 Sq M
For Illustration Purposes Only - Not To Scale

