



St. Oswalds Park

Dunham-On-Trent, Newark, NG22 0UB

£75,000



Dunham On Trent village has a pub / restaurant, Indian restaurant and a busy village hall with a recreation ground. Further amenities are located in the well served village of Tuxford and the market town of Retford. Retford offers a wealth of facilities including supermarkets, shops, boutiques, popular restaurants and pubs and even a monthly farmers market which offer local produce for sale in the busy market square. There is also an award winning town park, Kings Park which has both the River Idle and the chesterfield canal running through it as well as a children's play park, rose garden, small cafe and bowling green. The A1 motorway is accessed in under 7 miles and for those travelling further afield, Robin Hood airport is accessed in under 15 miles.



Description

LOW MAINTENANCE LIVING - This well presented two bedroom park home positioned on a popular residential development in the village of Dunham On Trent within walking distance to the local pub, restaurant and village hall. The home comprises of a kitchen / diner, lounge, two bedrooms and shower room. There is a driveway, side and rear garden with a greenhouse.

Entrance Hall

Entering through the side upvc door into the carpet hallway with radiator and access to all rooms.

Kitchen 11'8" x 8'2" (3.56m x 2.49m)

The kitchen comprises of white wall and base units, complementary butcher block style work surfaces with matching breakfast bar, sink and drainer unit, integrated gas four ring hob, electric oven with an extractor over and space for fridge freezer and washing machine, laminate flooring, dual aspect double glazed windows to either side and central heating radiator, coving and centre lighting. The combi boiler is located in a cupboard in the kitchen.

Lounge 11'6" x 10'0" (3.51m x 3.05m)

A bright lounge with dual aspect windows with blinds, carpet and radiator, coving and centre lighting.

Bedroom One 11'6" x 8'2" (3.53m x 2.51m)

A double room to the rear of the home with fitted wardrobes, double glazed window and a central heating radiator.

Bedroom Two 8'5" x 8'2" (2.59m x 2.49m)

A side facing bedroom with carpet and two built in single units and radiator.

Shower Room 8'2" x 8'5" (2.50m x 2.57m)

A newly renovated shower room with a walk in double shower unit, glass door with a pump fed shower, white vanity sink and wc.

Additional Information

The park home was manufactured in 2006 and had the exterior painted in 2025. Site fees are £269 pcm. Bottle gas runs the central heating boiler and gas hob.

Outside

To the side of the property there is a driveway and gated access to the low maintenance side garden with astro turf and border to the side with small decorative shrubs, patio and greenhouse to the rear.

Disclaimer

1. **MONEY LAUNDERING REGULATIONS:** Intending purchasers will be asked to produce identification documentation at a later stage and we would ask for your co-operation in order that there will be no delay in agreeing the sale.
2. **General:** While we endeavour to make our sales particulars fair, accurate and reliable, they are only a general guide to the property and, accordingly, if there is any point which is of particular importance to you, please contact the office and we will be pleased to check the position for you, especially if you are contemplating travelling some distance to view the property.
3. **Measurements:** These approximate room sizes are only intended as general guidance. You must verify the dimensions carefully before ordering carpets or any built-in furniture.
4. **Services:** Please note we have not tested the services or any of the equipment or appliances in this property, accordingly we strongly advise prospective buyers to commission their own survey or service reports before finalising their offer to purchase.
5. **THESE PARTICULARS ARE ISSUED IN GOOD FAITH BUT DO NOT CONSTITUTE REPRESENTATIONS OF FACT OR FORM PART OF ANY OFFER OR CONTRACT. THE MATTERS REFERRED TO IN THESE PARTICULARS SHOULD BE INDEPENDENTLY VERIFIED BY PROSPECTIVE BUYERS OR TENANTS. NEITHER Clark Estates OR ANY OF ITS EMPLOYEES OR AGENTS HAS ANY AUTHORITY TO MAKE OR GIVE ANY REPRESENTATION OR WARRANTY WHATEVER IN RELATION TO THIS PROPERTY.**

Area Map



Floor Plans

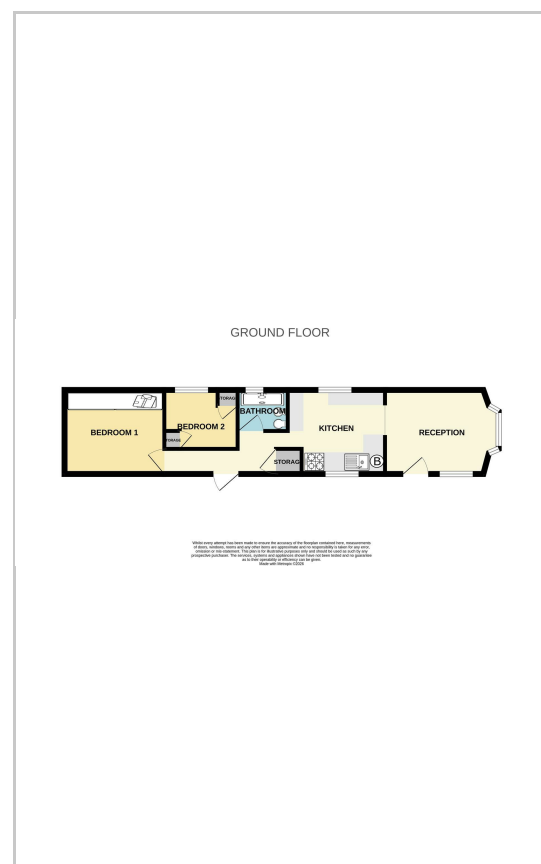

Energy Efficiency Graph

These particulars, whilst believed to be accurate are set out as a general outline only for guidance and do not constitute any part of an offer or contract. Intending purchasers should not rely on them as statements of representation of fact, but must satisfy themselves by inspection or otherwise as to their accuracy. No person in this firm's employment has the authority to make or give any representation or warranty in respect of the property.

14-16 Eldon Street, Tuxford, NG22 0LH

Tel: 01777 801 901 Email: dawn@clark-estates.co.uk www.clark-estates.co.uk